

## Pendant Mount Installation Instructions

### PENDANT HARDWARE KIT CONTENTS:

#### At the feed point:

- One (1) 6' SJT cord
- One (1) 6' 3/32 aircraft cable with 1 swaged end
- One (1) 1/4x20x3/32 cable gripper with attached bracket
- One (1) 1/4x20 female threaded barrel nut
- One (1) steel round canopy with 2 holes
- One (1) J-box strap
- One (1) 1/4x20 threaded stud
- One (1) white plastic cord strain relief

#### At the support point:

- One (1) 6' 3/32 aircraft cable with 1 swaged end
- One (1) 1/4x20x3/32 cable gripper with attached bracket
- One (1) 1/4x20 female threaded barrel nut
- One (1) steel round canopy with 1 hole

#### SUPPLIED BY CONTRACTOR:

##### At the feed point:

- One (1) round j-box installed in ceiling

##### At the support point:

- One (1) 1/4x20 stud (hard ceiling)
- Caddy Clip or equivalent (grid mount)

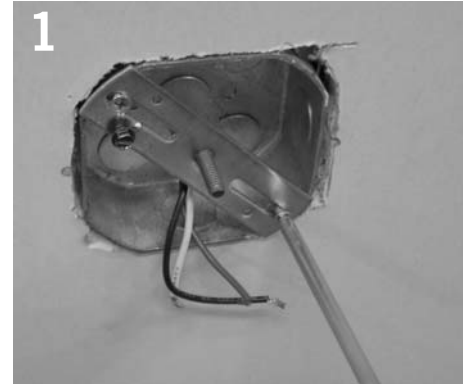

1 Install j-box strap and 1/4-20 stud to j-box.

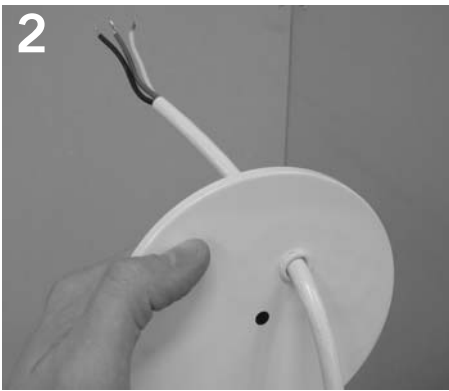

2 Thread feed cord through bushing in feed canopy.



3 Make electrical connection in j-box and slide canopy over 1/4-20 stud.

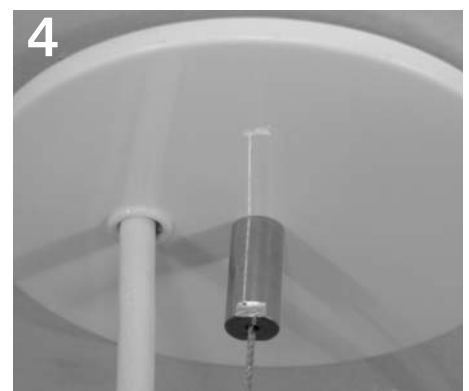

4 Secure canopy by tightening barrel nut onto stud. Repeat the same steps without cord for the support side.



5 Slide cables into cable grippers.



6 Unscrew gripper button cover.



7 Adjust cable lengths with gripper buttons and screw button cover back on.

## Pendant Mount Installation Instructions (cont.)



Trim excess cables with wire-cutter.



Slide mounting brackets into desired positions.



Slide cables into cable grippers.

## Wall Mount Installation Instructions

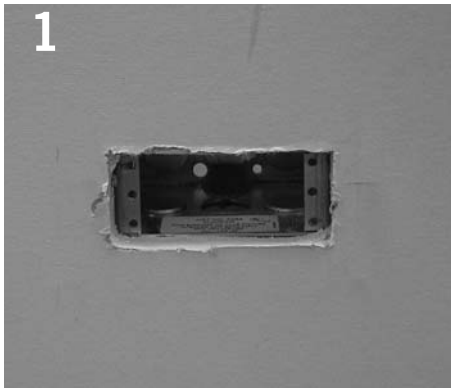

1  
Install Energie junction box horizontally into wall.



2  
Remove channel back by carefully prying off with screwdriver.

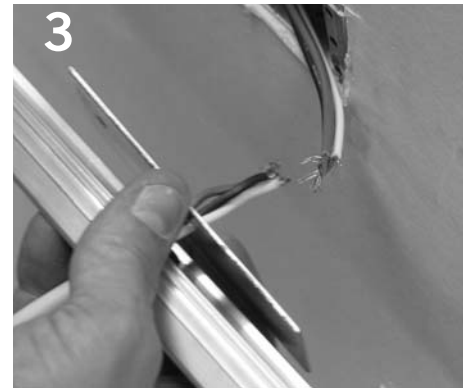

3  
Make electrical connection. NOTE: Fixture backplate should be between channel back and junction box.

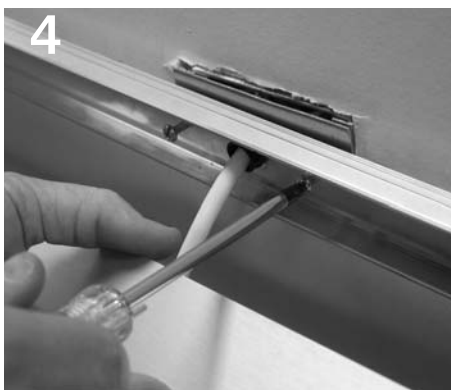

4  
Anchor backplate and channel back to junction box.



5  
Screw channel back to wall.



6  
Snap fixture onto channel back.

## Ceiling Mount Installation Instructions

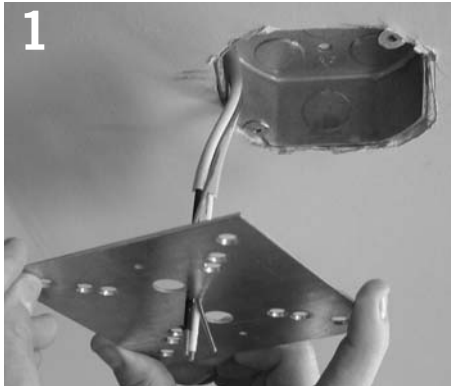

1 Slide mounting plate over pre-installed octagonal junction box.



2 Secure mounting plate with two counter-sunk screws.

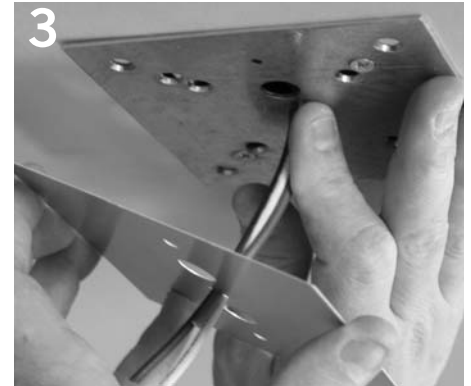

3 Position coverplate on mounting plate.



4 Remove channel back by carefully prying off with screwdriver.



5 Secure channel back to mounting plate with 2 screws.



6 Secure channel to ceiling at either end of channel.



7 Make electrical connection.

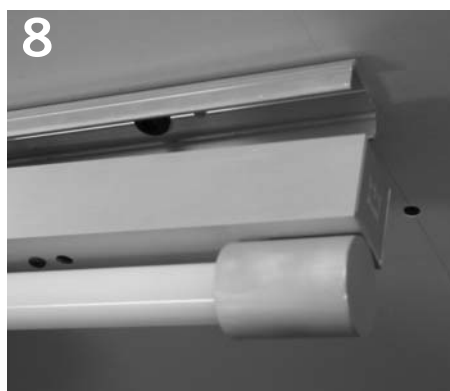

8 Snap fixture onto channel back.

Product to be installed by qualified electrician only.

PART # 05072145-01

## Lamp Installation Instructions

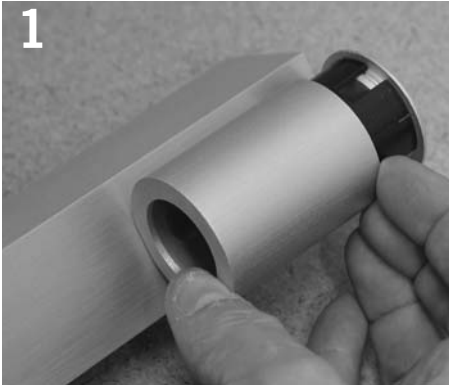

1 At non-spring loaded end, slide lamp-socket cover towards fixture center to remove it.



2 Slide lamp-socket cover over lamp.

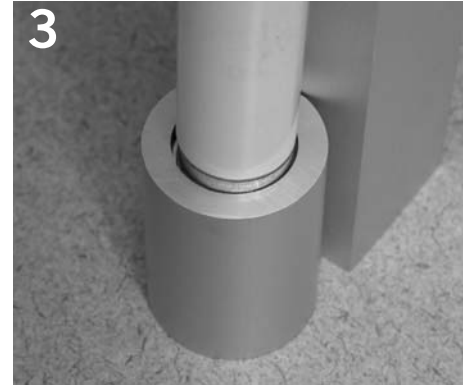

3 Insert opposite end of lamp into spring-loaded end of fixture.



4 Slide lamp into slots on fixed-end socket.



5 Twist and lock lamp into place.

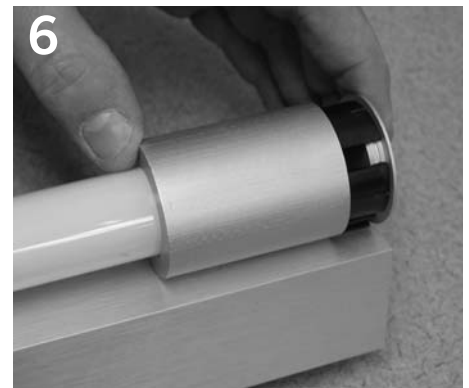

6 Slide lamp-socket cover over end of lamp.