

## Pendant Mount Installation Instructions

### PENDANT HARDWARE KIT CONTENTS:

#### At the feed point:

- One (1) 4-15/16" Ceiling Canopy
- One (1) Junction Box Cross Bar
- One (1) 1/4 - 20 x 1" Threaded Stud
- One (1) 1/4 - 20 Barrel Nut
- One (1) 7' Aircraft Cable w/ Swaged End
- One (1) Cord Strain Relief Bushing

#### At the support point:

- One (1) 2" Ceiling Canopy
- One (1) 1/4 - 20 Barrel Nut
- One (1) 7' Aircraft Cable w/ Swaged End

### SUPPLIED BY CONTRACTOR:

#### At the feed point:

- One (1) Octagonal Junction Box

#### At the support point:

- One (1) 1/4 - 20 Stud (Hard Ceiling)
- Caddy Clip Or Equivalent (Grid Ceiling)

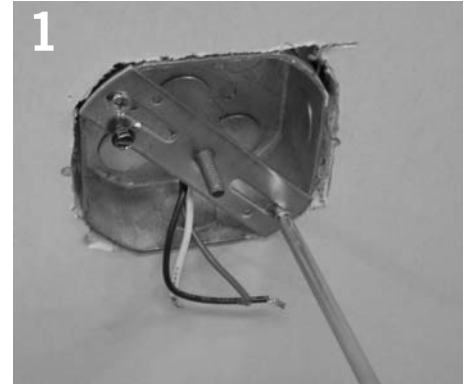

1 Install octagonal junction box into ceiling.

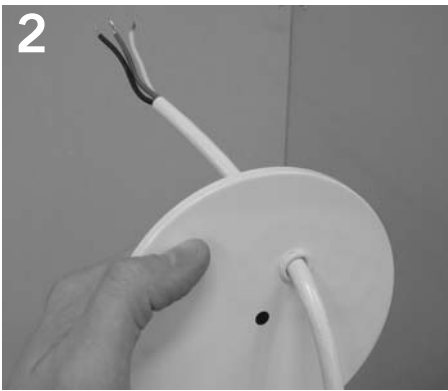

2 Thread feed cord through bushing in feed canopy.



3 Make electrical connection in junction box and slide canopy over 1/4-20 stud.

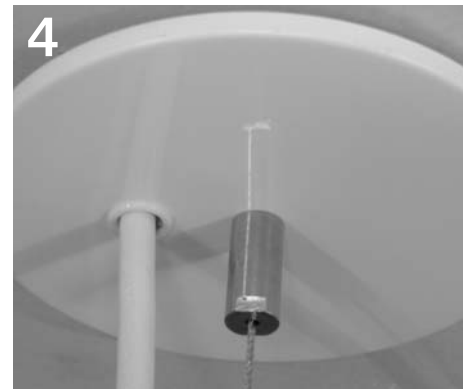

4 Secure canopy by tightening barrel nut onto stud. Repeat the same steps (without electrical cord) for the support end of luminaire..

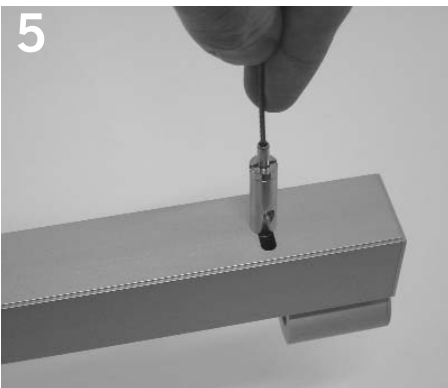

5 Insert cables into grippers on top of luminaire.

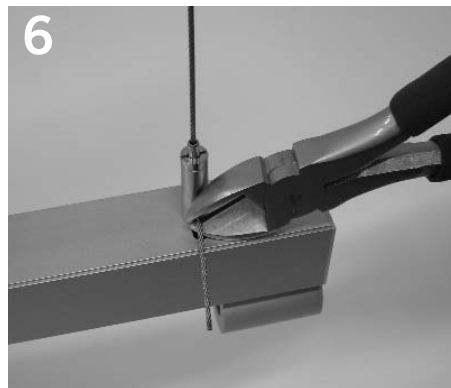

6 Adjust luminaire to desired height and trim excess cable.

Product to be installed by qualified electrician only.

PART # 05072147-01 REV A

## Wall Mount Installation Instructions

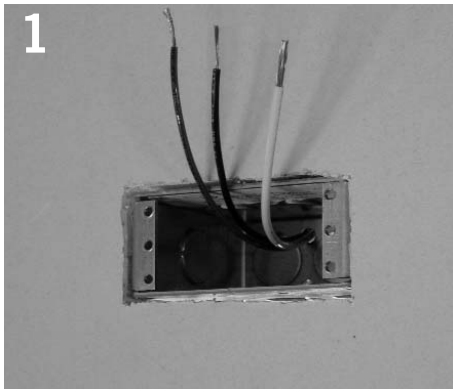

1 Install Energie junction box into wall in orientation of desired luminaire direction.



2 Remove luminaire back channel by carefully prying off with screwdriver.

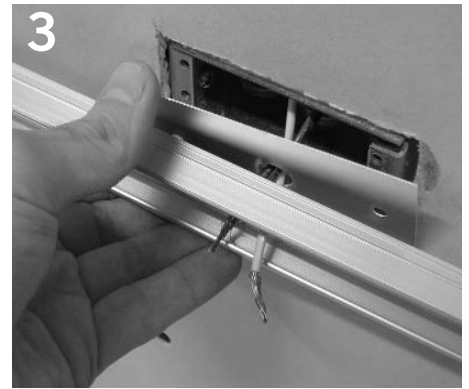

3 Insert building supply wires through center hole in trim plate and through center hole in back channel. Trim plate should be between back channel and junction box, as shown.

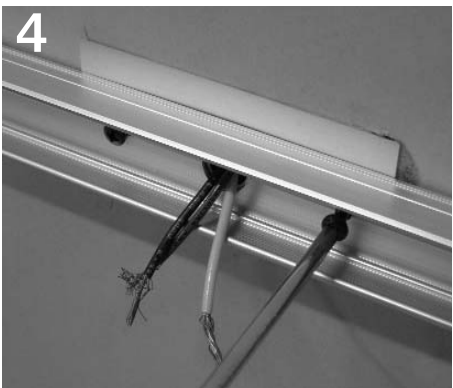

4 Level and secure trim plate and back channel to junction box.

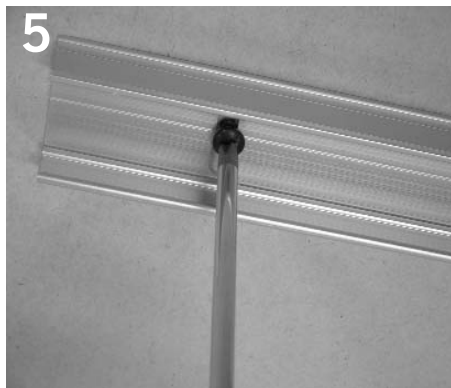

5 Secure back channel to wall at outboard holes.



6 Make electrical connection.



7 Snap fixture onto back channel.

## Ceiling Mount Installation Instructions

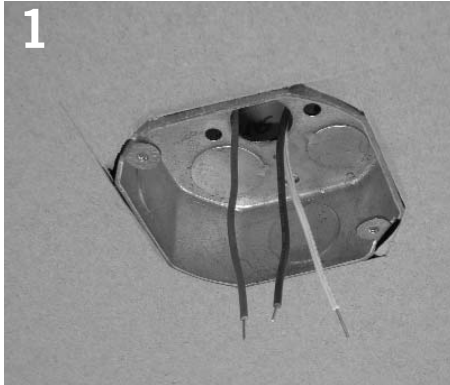

1 Install octagonal junction box into ceiling.

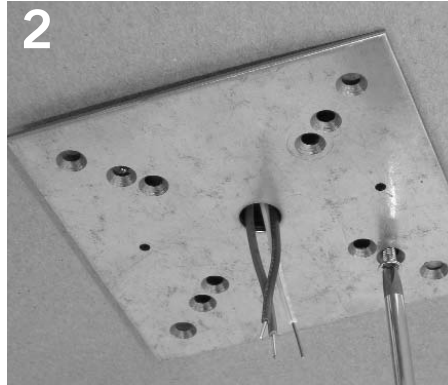

2 Secure junction box cover plate to junction box. Route building supply wires through center hole in plate.



3 Remove luminaire back channel by carefully prying off with screwdriver.



4 Insert building supply wires through center hole in trim plate and through center hole in back channel. Trim plate should be between back channel and junction box plate, as shown.

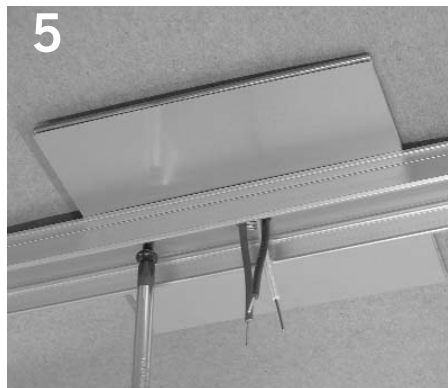

5 Secure trim plate and back channel to junction box plate.

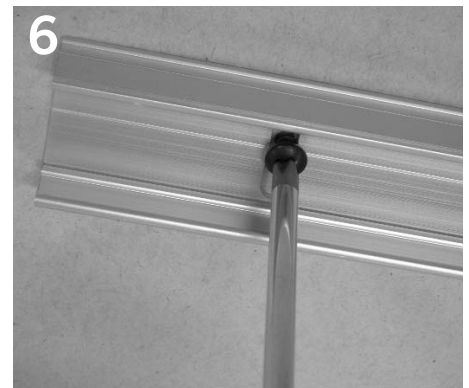

6 Secure back channel to ceiling at outboard holes.



7 Make electrical connection.

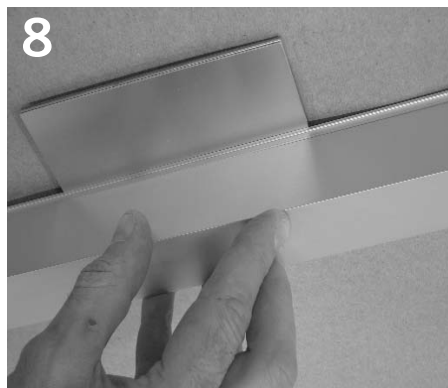

8 Snap fixture onto back channel.

## Lamp Installation Instructions

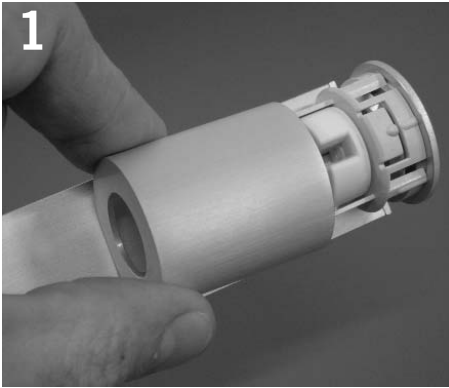

1 Slide lamp end cover toward fixture center and remove. Repeat for opposite lamp end cover.



2 Slide lamp end cover over each end of lamp.



3 Insert lamp into lampholders.



4 Slide lamp end cover to end of lamp.

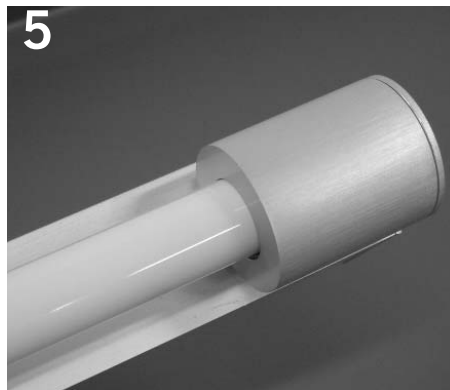

5 Reinstall lamp end covers at each end.

## Lamp Installation Instructions- Baffle

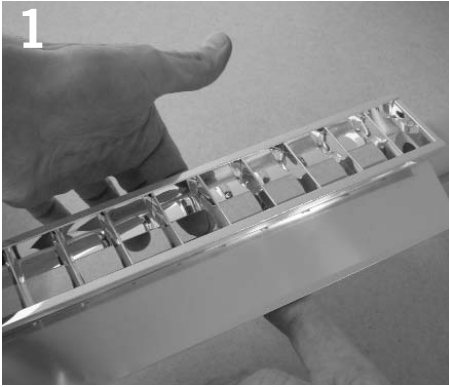

1  
Compress spring clip near each end of baffle. Lift baffle away from luminaire body.

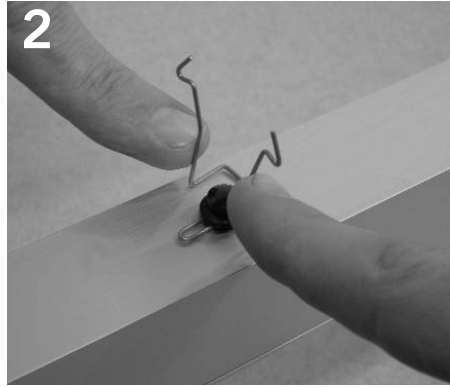

2  
Detail of spring clip suppression.  
NOTE: Baffle removed for clarity.

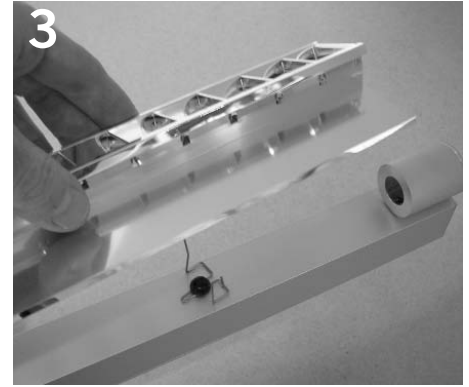

3  
Remove baffle from luminaire.

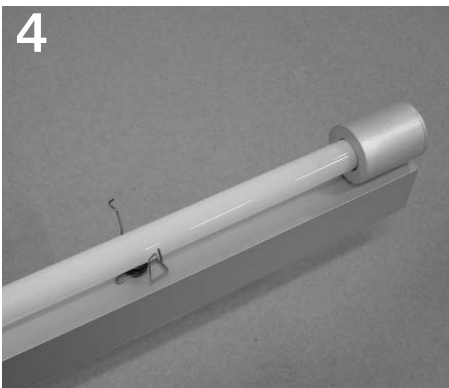

4  
Install lamp per relamp label. See lamping instructions for method of installation.



5  
Re-attach baffle to spring clips at each end.

## Lamp Installation Instructions- Microperf Louver

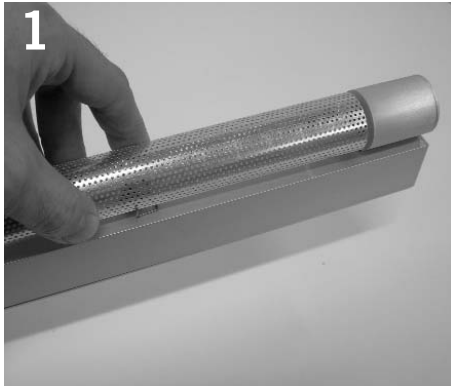

1  
Lightly compress microperf louver at securing clips near each end of luminaire.

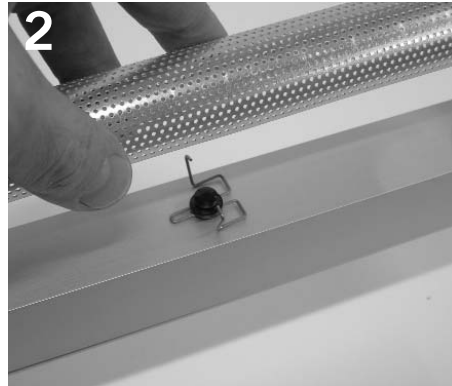

2  
After compressing louver enough to release from securing clip, lift louver from luminaire.

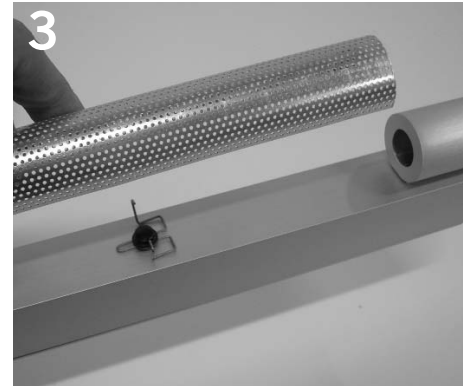

3  
Remove louver from luminaire.



4  
Install lamp per relamp label. See lamping instructions for method of installation.



5  
Re-attach louver to securing clips at each end.