

## Suspending the System



### PENDANT FEED KIT CONTENTS:

- One (1) SJT Cord
- One (1) Cord Bushing
- One (1) Steel Round Canopy with 2 Holes
- One (1) J-box Strap
- One (1) 1/4x20 Threaded Stud
- One (1) White Plastic Cord Strain Relief

### SUPPLIED BY CONTRACTOR:

One (1) Octagonal J-box installed in ceiling



### PENDANT SUPPORT KIT CONTENTS:

- Two (2) 6' 3/32 Aircraft Cables with 1 Swaged End
- Two (2) 1/4x20x3/32 Cable Grippers
- Two (2) Steel Round Canopies with 1 Hole
- Two (2) 1/4x20 Female Threaded Barrel Nuts
- Two (2) Tube Bracket Clamp Assemblies



### SUPPLIED BY CONTRACTOR:

- Two (2) 1/4x20 Studs (Hard Ceiling)
- Caddy Clips or Equivalent (Grid Mount)

**Note:** Luminaire must be tied to structure per local requirements.

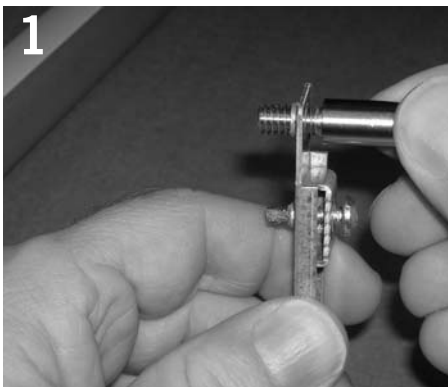

1  
Thread cable grippers into brackets as shown.



2  
Slide bracket into tube at desired location and tighten screw to secure.



3  
Fasten caddy clip around spline.

**NOTE:** All wire/cord connections must be done inside of electrical enclosures. DO NOT make connections inside tubes.

Product to be installed by qualified electrician only.

PART # 05122228-01

## Suspending the System Continued...

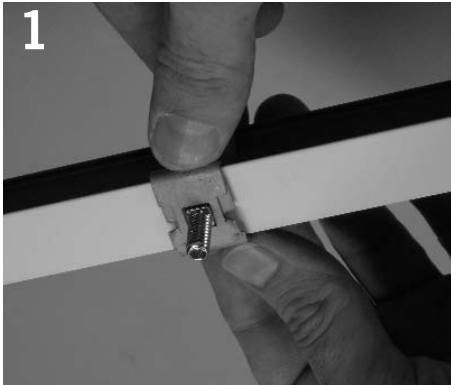

**1**  
To assemble the Caddy Clip start by separating each half of the clip. Place the threaded stud in the square hole on one half. Place the two halves around the T-grid Ceiling and press together. The integrated tabs will then lock together.

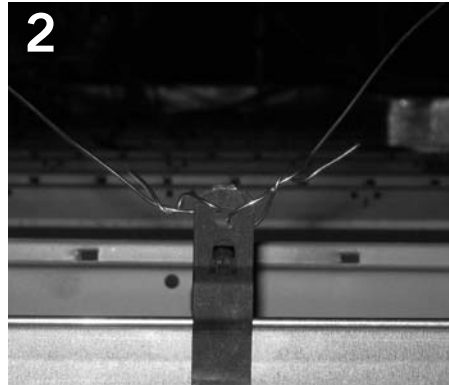

**2**  
Attach the Caddy/B-line clip to the T-grid ceiling as shown. Make sure to tie the clip off to the ceiling structure in a "V" Pattern or directly above the suspension point. This will reduce torsion to the T-grid.

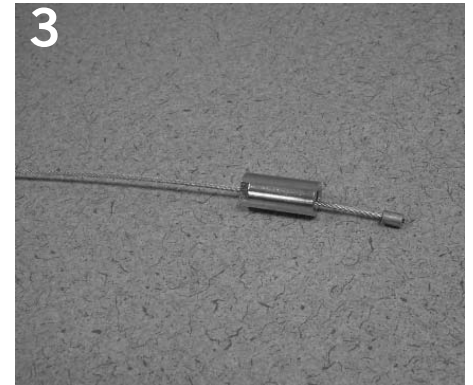

**3**  
Insert swaged suspension cable through threaded barrel.



**4**  
Thread cable through barrel nut and secure canopy by tightening barrel nut onto 1/4-20 stud.



**5**  
Insert cable into gripper and adjust to desired height.

## Installing Feed Kit

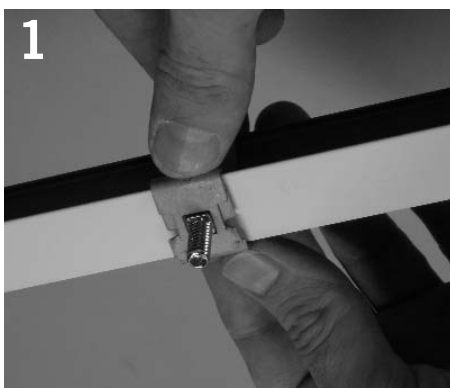

**1**  
To assemble the Caddy Clip start by separating each half of the clip. Place the threaded stud in the square hole on one half. Place the two halves around the T-grid Ceiling and press together. The integrated tabs will then lock together.

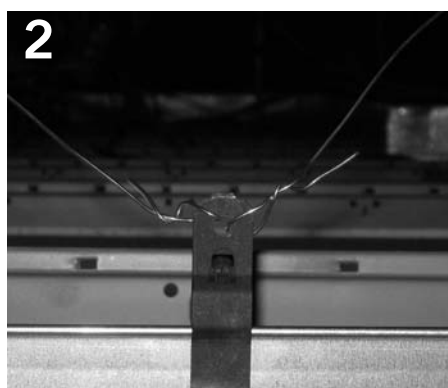

**2**  
Attach the Caddy/B-line clip to the T-grid ceiling as shown. Make sure to tie the clip off to the ceiling structure in a "V" Pattern or directly above the suspension point. This will reduce torsion to the T-grid.

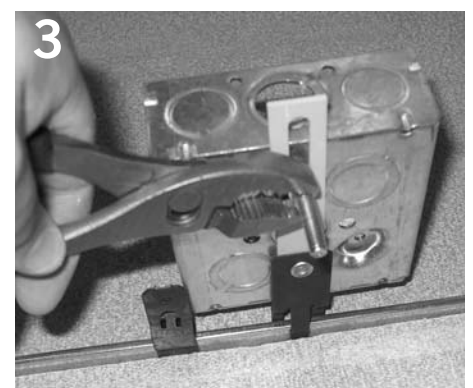

**3**  
Attach the J-box to the Caddy/B-Line clip as shown. Make sure to secure the J-box with a screw. Run conduit to J-box with proper feed wiring for that location.

Product to be installed by qualified electrician only. **NOTE:** All wire/cord connections must be done inside of electrical enclosures.

PART # 05122228-01

## Pendant Mount Installation Instructions

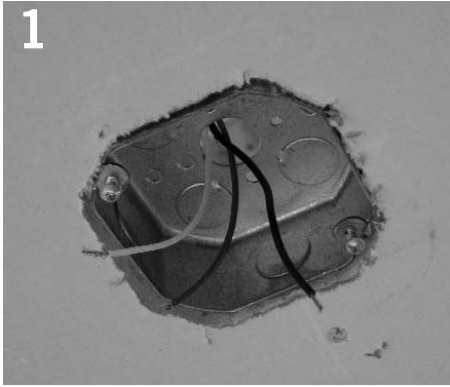

1  
Install 4" octagonal junction box into ceiling.

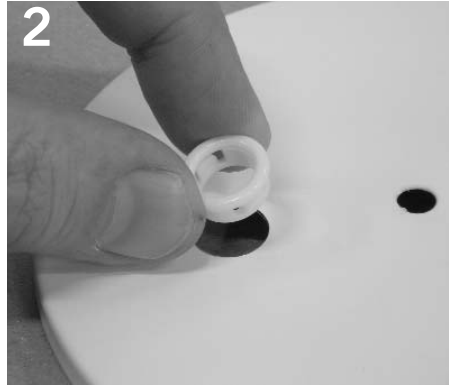

2  
Insert bushing into feed canopy.

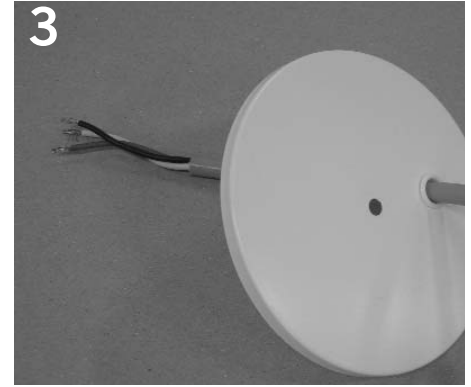

3  
Slide power cord through feed canopy and make electrical connections to pre-installed junction box.

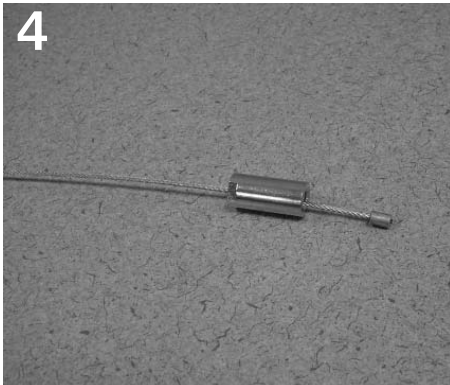

4  
Insert swaged suspension cable through threaded barrel.



5  
Secure feed canopy to 1/4-20 x 1 1/2" length stud with threaded barrel.

**NOTE:** All wire/cord connections must be done inside of electrical enclosures. DO NOT make connections inside tubes.

Product to be installed by qualified electrician only.

PART # 05122228-01

## Making an Electrical Connection at the Fixture

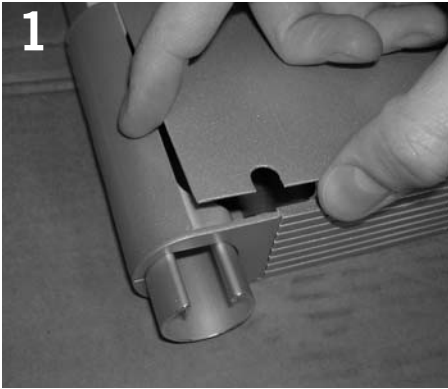

1 Remove electrical enclosure cover.

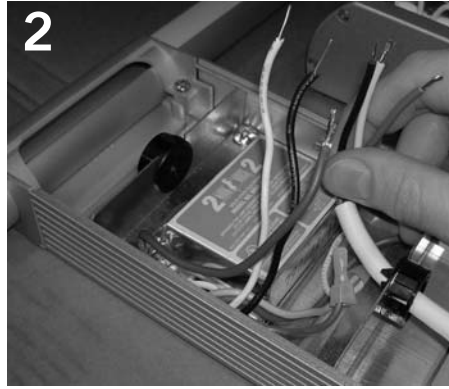

2 Thread through cord tube and into metal electrical enclosure.

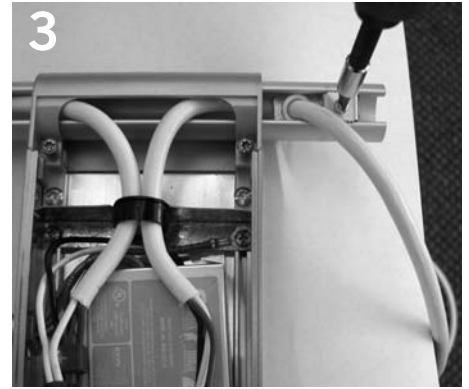

3 Thread other end of cord through bushing in bracket, then tighten clamp screw to secure.



4 Make electrical connection inside metal electrical enclosure.



5 If continuing circuit to additional modules, thread cord in from opposite direction and make electrical connection in metal electrical enclosure.

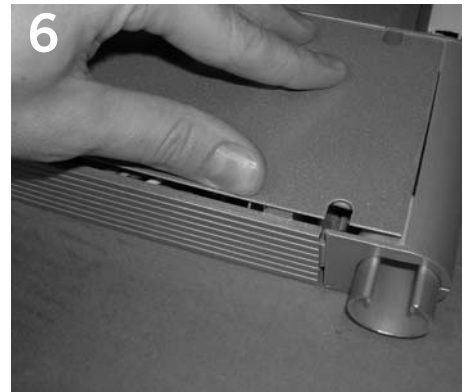

6 Replace electrical enclosure cover.

**NOTE:** All wire/cord connections must be done inside of electrical enclosures. DO NOT make connections inside tubes.

Product to be installed by qualified electrician only.

PART # 05122228-01

## Making an Electrical Connection at the Fixture

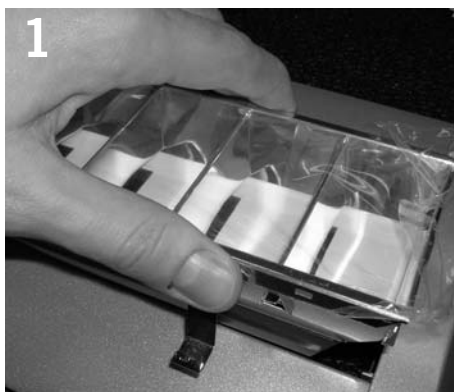

1 Remove louver by squeezing clips at either end and pulling out.

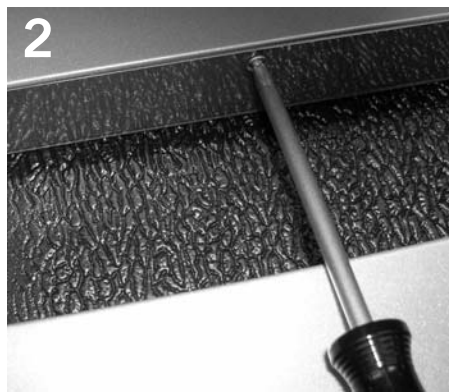

2 Remove ballast compartment cover by unscrewing phillips screws.



3 Pull cover and ballast out of fixture.



4 Remove tube cover and feed incoming SJT from Tube through one hole in side of fixture. If continuing circuit, feed outgoing cord through second hole.



5 Make electrical connection inside ballast compartment and conceal cord in tube as shown.

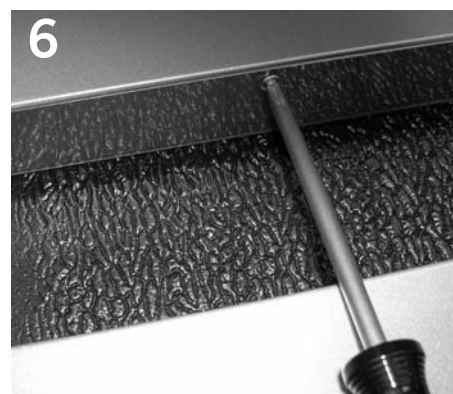

6 Replace ballast cover and secure with screws.



7 Replace tube cover as shown.

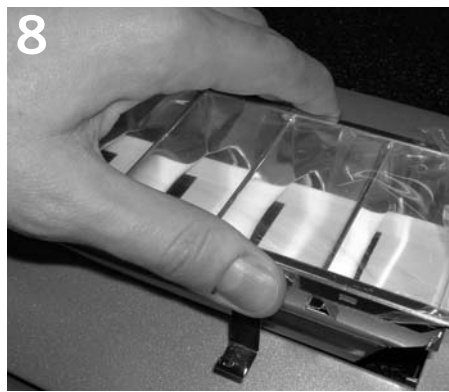

8 Install lamp(s) per relamp label and reinstall louver.

**NOTE:** All wire/cord connections must be done inside of electrical enclosures. DO NOT make connections inside tubes.

Product to be installed by qualified electrician only.

PART # 05122228-01

## Joining Tubes

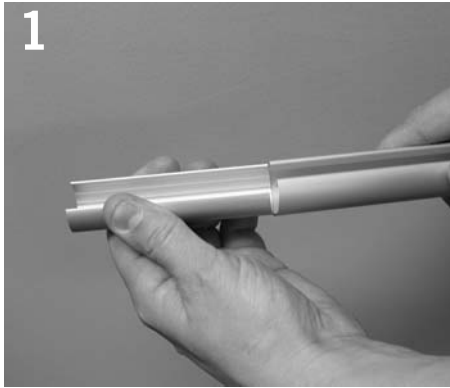

1 Slide joining sleeve into end of tube.

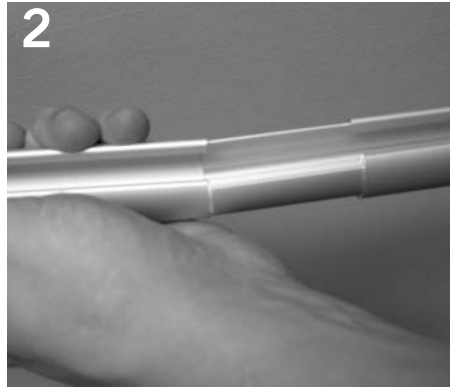

2 Slide next tube module onto joining sleeve.

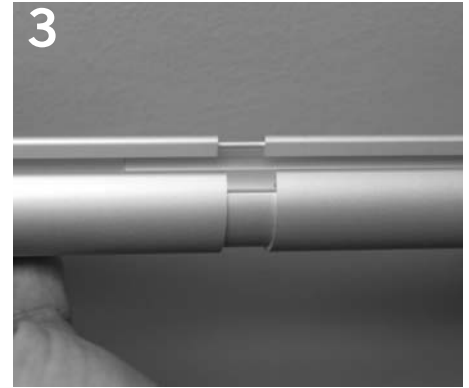

3 Slide tubes together.

## Inserting Endcaps

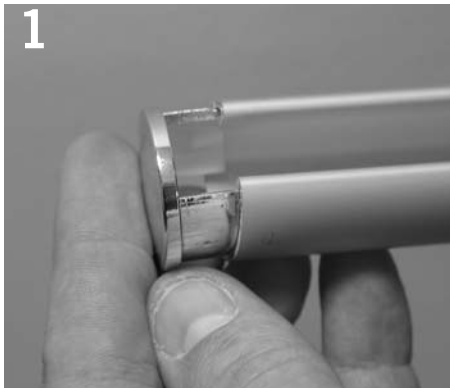

1 Insert endcap into tube.



2 Push endcap until flush.

### MAXIMUM LOAD PER DROP

Maximum load per drop may be calculated by adding the total wattage required by the fixtures. The maximum allowable wattage per drop is:

- 120 VOLT** - 1080 watts
- 277 VOLT** - 2493 watts
- 347 VOLT** - 3123 watts

Note: For non-standard ballasts, please contact Energie.

The wattage required by each T200 module is:

## Inserting Tube Covers

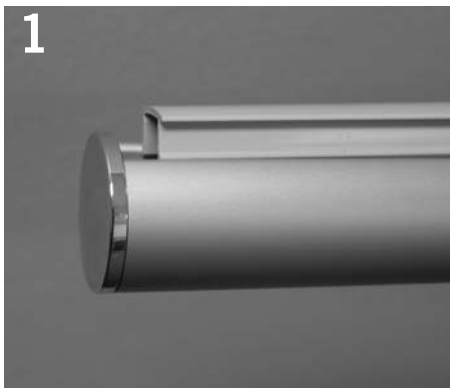

1 Insert tube cover into tube extrusion.



2 Snap cover into tube.

- T200-IND-1T528** -- 32
- T200-IND-2T528** -- 65
- T200-IND-2T554** -- 122
- T200-LAM-1T528** -- 30
- T200-LAM-2T528** -- 65
- T200-LIC** -- 30
- T200-MHS-39** -- 39
- T200-MHS-70** -- 70
- T200-PAR1** -- 75
- T200-PAR2** -- 150
- T200-PAR3** -- 225

**NOTE:** All wire/cord connections must be done inside of electrical enclosures. DO NOT make connections inside tubes.  
Product to be installed by qualified electrician only.

PART # 05122228-01

## Installation Instructions

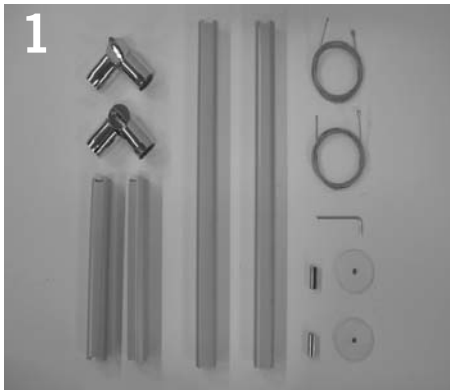

1  
Corner kit comprised of hinged corners, tubes with covers, cables, barrel nuts, canopies and hex wrench.



2  
Insert tubes into corners as shown.



3  
If applicable, route cord through corner piece (it may be necessary to remove 1 or both tubes for ease of cord routing).



4  
Thread cables through barrel nuts and secure canopies to ceiling by threading onto 1/4-20 studs and tightening.



5  
Insert cables into grippers. Adjust to desired length and trim excess cable.



6  
Tighten corners with provided hex wrench. Ensure all the tube covers are replaced.

**NOTE:** All wire/cord connections must be done inside of electrical enclosures. DO NOT make connections inside tubes.

Product to be installed by qualified electrician only.

PART # 05122228-01

## Installation Instructions

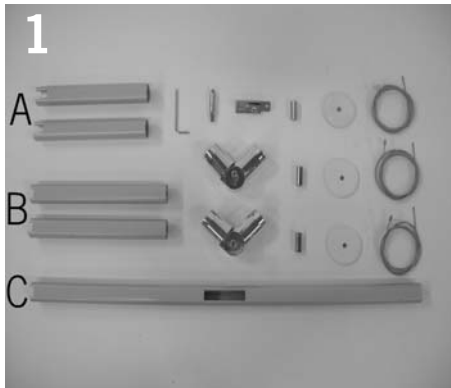

T kit comprised of hinged corners, tubes with covers, cables, barrel nuts, canopies, hex wrench and suspension bracket with cable gripper.

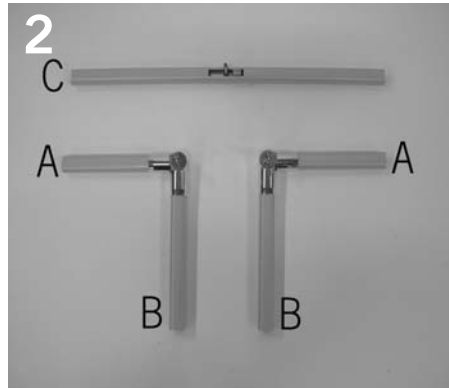

Insert tubes into corners as shown.

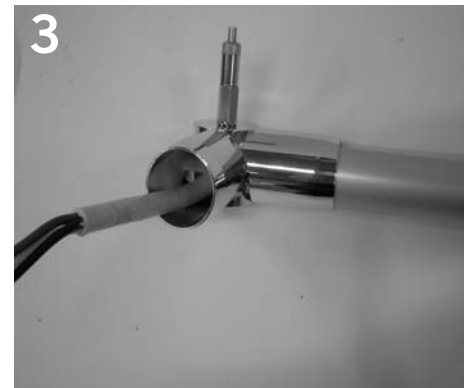

If applicable, route cord through corner piece (it may be necessary to remove 1 or both tubes for ease of cord routing).



Thread cables through barrel nuts and secure canopies to ceiling by threading onto 1/4-20 studs and tightening.



Slide bracket into tube. Center and tighten screw to secure. Insert cables into grippers x3. Adjust to desired length and trim excess cable.



Tighten corners with provided hex wrench. Ensure all the tube covers are replaced.

**NOTE:** All wire/cord connections must be done inside of electrical enclosures. DO NOT make connections inside tubes.

Product to be installed by qualified electrician only.

PART # 05122228-01