

# SCORTA PENDANT

## Installation Instructions

### PENDANT HARDWARE KIT CONTENTS:

#### At the feed point:

- One (1) 6' SJT cord
- One (1) 6' 3/32 aircraft cable with 1 swaged end
- One (1) 1/4x20x3/32 cable gripper
- One (1) 2 piece cable coupler
- One (1) steel round canopy with 2 holes
- One (1) J-box strap
- One (1) 1/4x20 threaded stud
- One (1) white plastic cord strain relief

#### At the support point:

- One (1) 6' 3/32 aircraft cable with 1 swaged end
- One (1) 2 piece cable coupler
- One (1) 1/4x20x3/32 cable gripper
- One (1) steel round canopy with 1 hole

### SUPPLIED BY CONTRACTOR:

#### At the feed point:

- One (1) round j-box installed in ceiling

#### At the support point:

- One (1) 1/4x20 stud (hard ceiling)
- Caddy Clip or equivalent (grid mount)

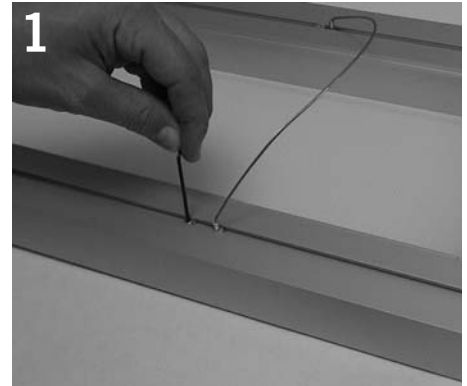

Adjust cable stops (4) to desired position, along fixture extrusion.

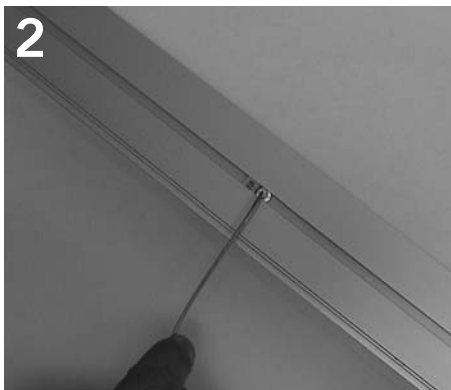

Slide fixed cable against cable stop.



Slide male end of suspension mechanism onto center of fixed cable.

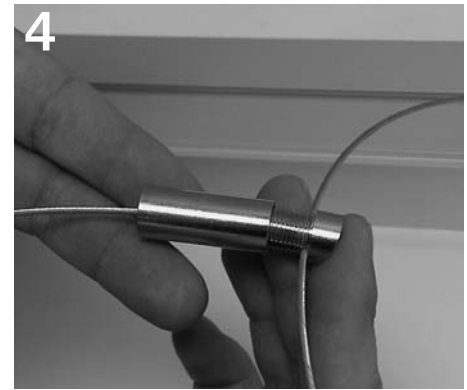

Lace swaged cable through female end of suspension mechanism and screw to male end.



Install lamps per relamp label.



Secure clear acrylic top cover into place.

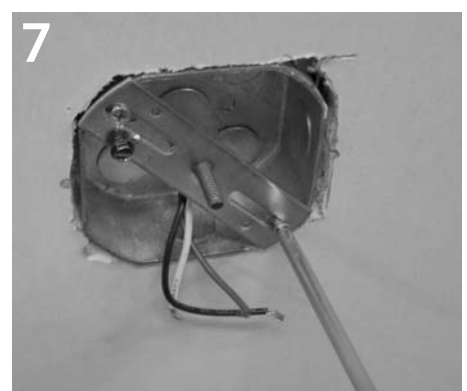

Install j-box strap and 1/4-20 stud to j-box.

Product to be installed by qualified electrician only.

PART # 05101419-01

# SCORTA PENDANT

énergie™

## Installation Instructions

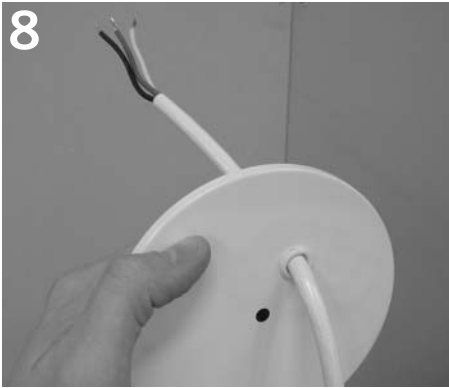

8  
Thread feed cord through bushing in feed canopy.



9  
Make electrical connection in j-box and slide canopy over 1/4-20 stud.



10  
Secure canopy by tightening threaded cable gripper onto stud.



11  
Insert cable and adjust to desired length.  
Trim excess cable.