

Installation Instructions

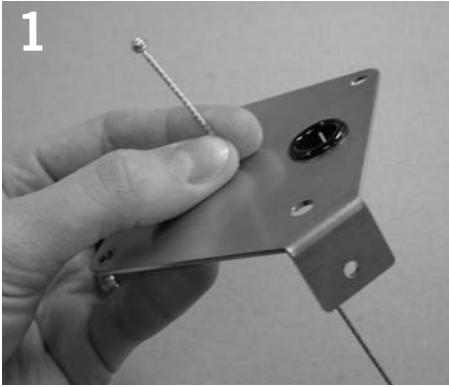

1
Lace aircraft suspension cable through mounting plate. Cable swedge should be above the mounting plate when finished.

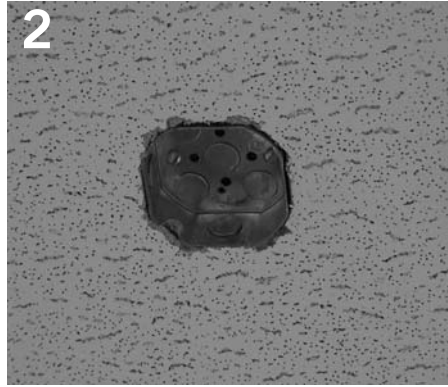

2
Install octagonal junction box (not provided) into ceiling.

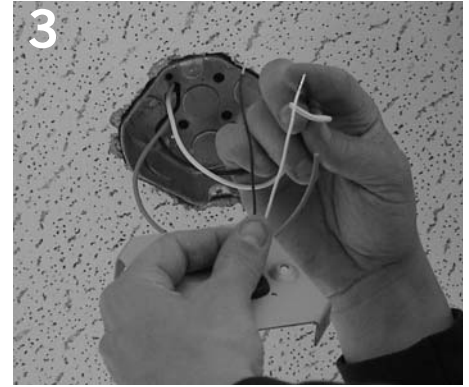

3
Make electrical connection between the mounting plate transformer and junction box.

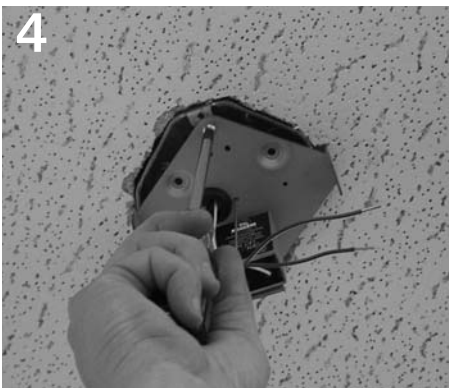

4
Secure mounting plate to junction box with two screws.



5
Cut power cord to desired length.



6
Slide power cord and suspension cable through fixture canopy. Secure cord in canopy with provided strain relief.



7
Make electrical connection between mounting plate and power cord.

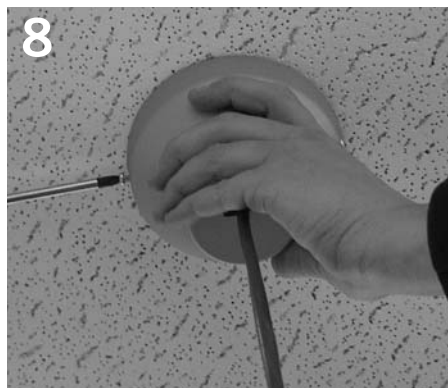

8
Secure canopy to mounting plate with two (2) screws provided.



9
Slide cable into adjustable gripper.

Product to be installed by qualified electrician only.

PART # 05090702-01

Installation Instructions



Install lamp per relamp label.