

OPUS PENDANT

énergie™

Installation Instructions

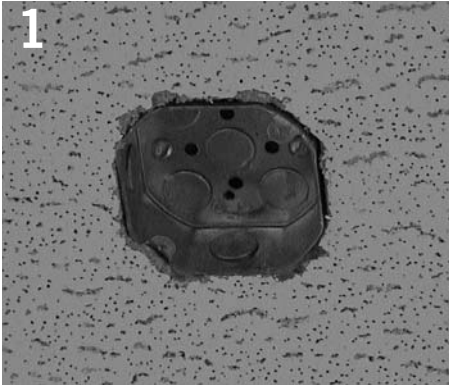

1 Install octagonal junction box into ceiling.



2 Slide mounting canopy off of mounting plate. Slide wireway cover and canopy onto stem as shown.

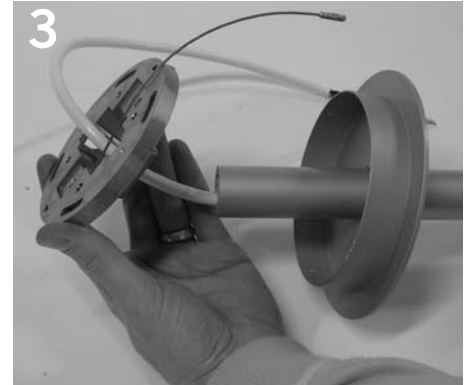

3 Make electrical connection. Route cord through mounting plate.

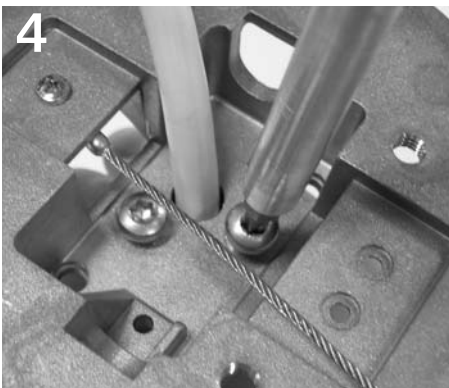

4 Attach mounting plate to stem with (2) two screws provided.



5 Slide barrier plate over cord and canopy as shown.



6 Screw mounting plate to junction box, attaching lanyard at the same time.



7 Slide mounting canopy to cover mounting plate.



8 Quick connect fixture to mounting stem assembly.

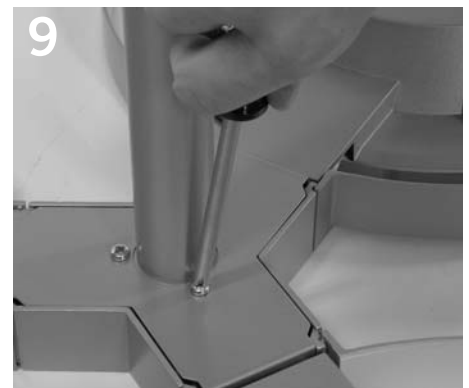

9 Slide wireway cover into place and secure with screws provided.

Product to be installed by qualified electrician only.

PART # 05101001-02

OPUS PENDANT

énergie™

Installation Instructions



10 Pull cover-plate buttons on back of fixture and remove coverplate.

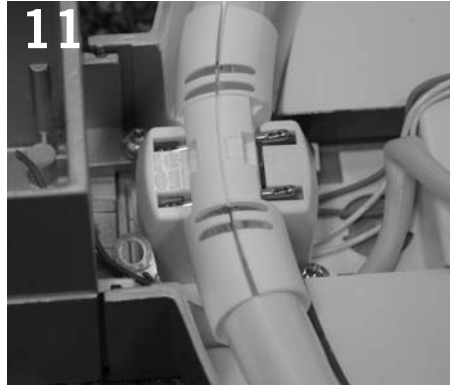

11 Install lamp(s). 55 Watt T5 circline.



12 Position coverplate with lampholds secure around the lamp.

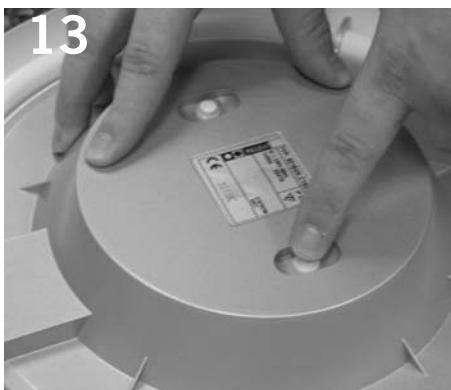

13 Depress buttons to secure coverplate in place.

Product to be installed by qualified electrician only.

PART # 05101001-02

Energie LLC, 4885 Ward Road, Suite 300 Wheat Ridge, CO 80033 Tel 720 963 8055 Fax 720 963 8044 www.energielighting.com
All rights reserved. These products may be covered by one or more U.S. or international patents or patents pending. 12/05