

## Wall Mount Installation Instructions

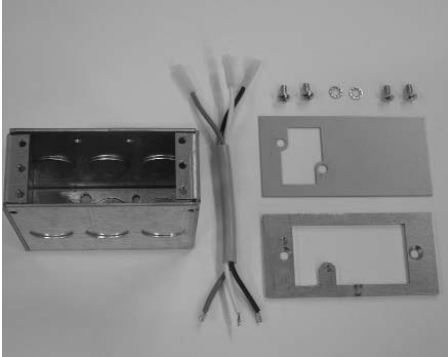

### WALL MOUNT FEED KIT CONTENTS:

- One (1) 6' SJT Cord w/ Connectors (1) End
- One (1) Energie Junction Box
- One (1) Wall Mounting Plate
- One (1) Wall Trim Plate
- Two (2) #8-32 x 3/8 Flathead (FH) Screws
- Two (2) #8-32 x 1/4 Panhead (PH) Screws
- Two (2) #10 Lock Washers

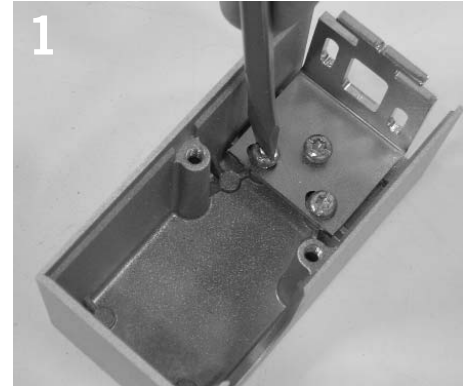

1  
Remove and set aside (2) screws as shown, leaving center screw attached.

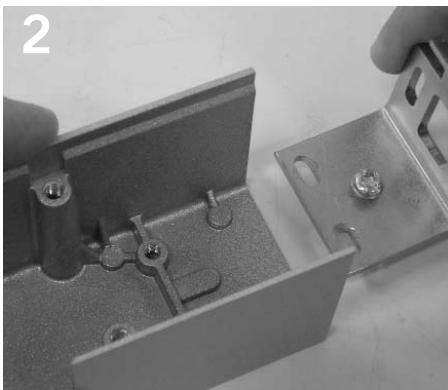

2  
Remove support bracket from end block.

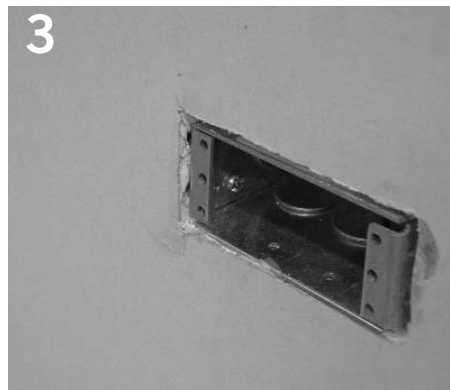

3  
Install Energie junction box horizontally into wall.

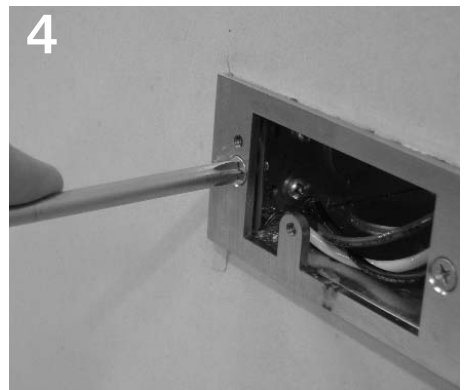

4  
Install mounting plate onto junction box using (2) #8-32 FH screws (provided).  
NOTE: Left end feed shown. For right end feed, invert mounting bracket.



5  
Make electrical connection with connector cord.



6  
Place trim plate over mounting plate and route connector cord through opening.



7  
Install support bracket and trim plate to mounting plate using (2) #8-32 PH screws with lock washers (provided). Level bracket and tighten screws. Route connector cord through opening in bracket, as shown.

Product to be installed by qualified electrician only.

PART # 04040645-01 REV .02

## Wall Mount Installation Instructions continued...

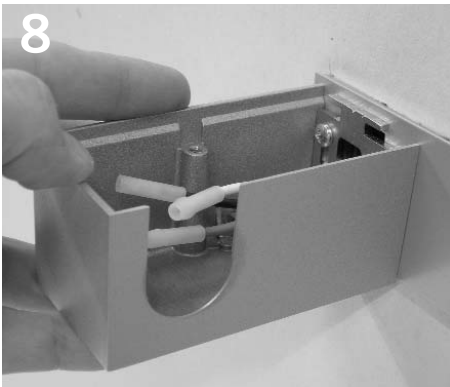

Slide end block onto support bracket.  
NOTE: Opening in end block should face in direction of blank portion of trim plate, as shown.



Reinstall and tighten (2) screws (previously set aside) to secure support bracket to end block.

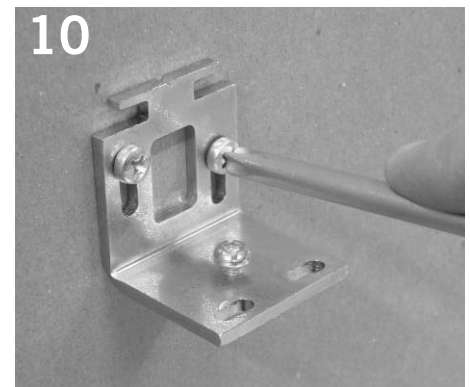

Install support bracket at opposite end of luminaire run with (2) #8 screws (not provided). Level bracket and tighten screws. NOTE: Mid-run joiner installed in same manner.



Slide end joiner block onto support bracket. Reinstall and tighten (2) screws to secure support bracket to block.



Slide luminaire body into slot in end blocks.

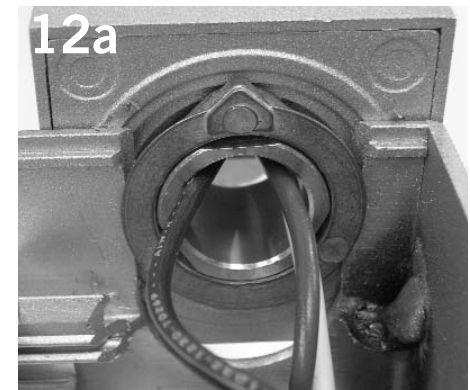

NOTE: To attach luminaire body to end block, arrow on rotation bushing must be oriented away from cut out on end block, as shown.



If applicable, connect like-colored electrical leads at joiner block at opposite end of luminaire body.



Connect like-colored electrical leads at power feed.

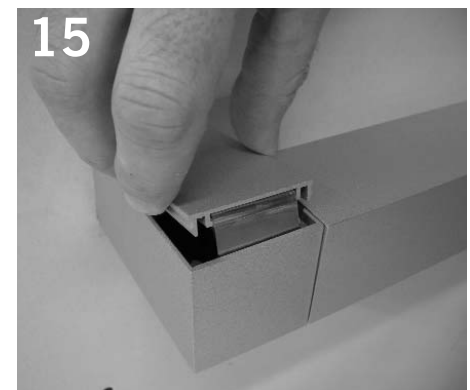

Snap end block covers into place.  
NOTE: Cover spring should face away from wall.

Product to be installed by qualified electrician only.

PART # 04040645-01 REV .02

## Wall Mount Installation Instructions continued...



16 Remove diffuser and install lamp per relamp label. Replace diffuser.



17 Rotate luminaire body to desired orientation.

## No Limit Wall, 1-Lamp Mounting Information

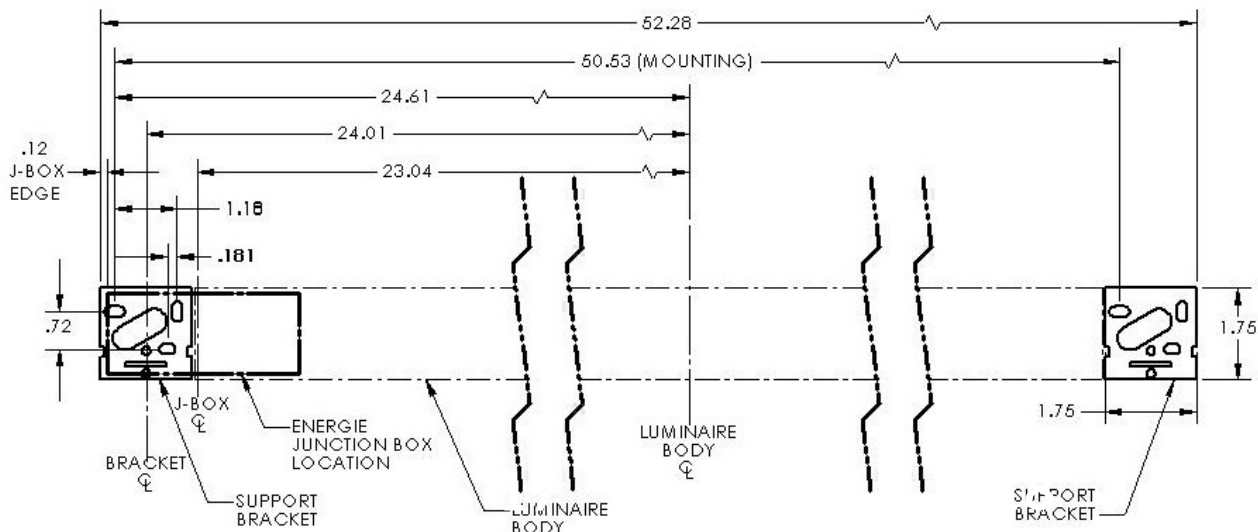

## Maximum Run Length Per Feed

	LAMPING per 4' SECTION	
	(1) T5	(1) T5HO
120 volt	74'	38'

Note: Run lengths based on fixtures with standard ballast. Dimming ballasts, battery packs, separate switching and specified ballasts should be verified by an electrical engineer.

## EMC Installation Instructions

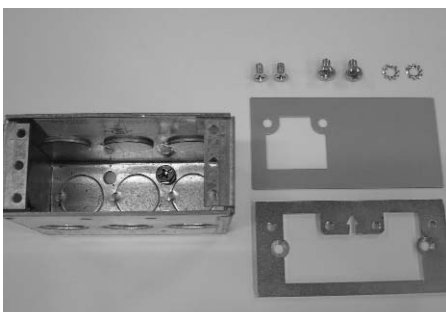

### EMC WALL MOUNT FEED KIT CONTENTS:

- One (1) Energie Junction Box
- One (1) Wall Mounting Plate
- One (1) Wall Trim Plate
- Two (2) #8-32 x 3/8 Flathead (FH) Screws
- Two (2) M5 x 8mm Panhead (PH) Screws
- Two (2) #10 Lock Washers



1  
Loosen support bracket lock and rotate it 90°.



2  
Remove support bracket from end block.



3  
Install Energie junction box horizontally into wall.

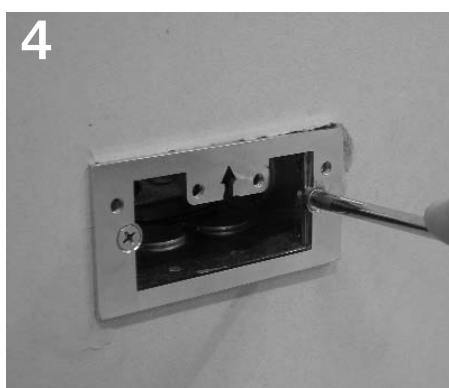

4  
Install mounting plate onto junction box using (2) #8-32 FH screws (provided). NOTE: Orient mounting plate with arrow pointing up.

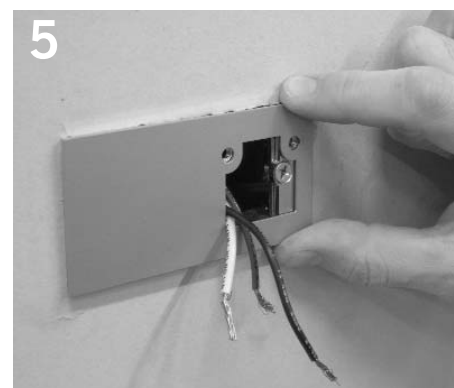

5  
Place trim plate over mounting plate and route connector cord through opening.



6  
Install support bracket and trim plate to mounting plate using (2) M5 x 8mm screws with lock washers (provided). Level bracket and tighten screws. Route leads through opening in bracket.

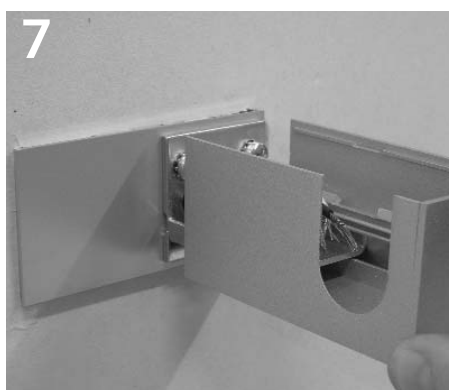

7  
Slide end block onto support bracket. NOTE: Opening in end block should face in direction of blank portion of trim plate, as shown.



8  
Rotate support bracket lock to engage end block, as shown. Tighten screw to secure.

Product to be installed by qualified electrician only.

PART # 04040645-01 REV .01

## EMC Installation Instructions continued...

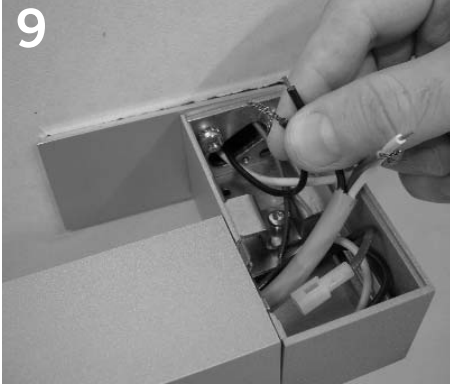

Install luminaire body per instructions.  
Make EMC electrical connection.



Snap end block covers into place.  
NOTE: Cover lip should face wall.