

## Wall Mount Installation Instructions

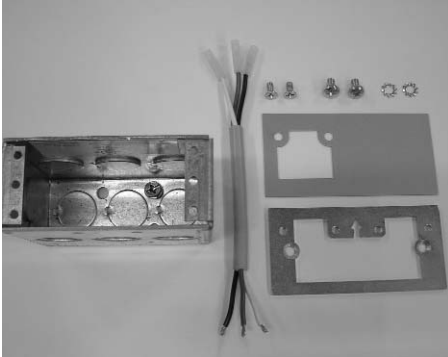

### WALL MOUNT FEED KIT CONTENTS:

- One (1) 6' SJT Cord w/ Connectors (1) End
- One (1) Energie Junction Box
- One (1) Wall Mounting Plate
- One (1) Wall Trim Plate
- Two (2) #8-32 x 3/8 Flathead (FH) Screws
- Two (2) M5 x 8mm Panhead (PH) Screws
- Two (2) #10 Lock Washers



Loosen support bracket lock and rotate it 90°.



Remove support bracket from end block.



Install Energie junction box horizontally into wall.

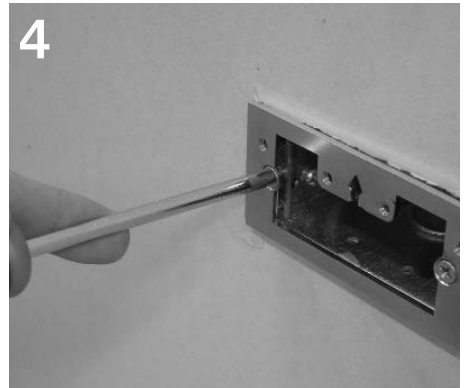

Install mounting plate onto junction box using (2) #8-32 FH screws (provided). NOTE: Orient mounting plate with arrow pointing up.



Make electrical connection with connector cord.



Place trim plate over mounting plate and route connector cord through opening.

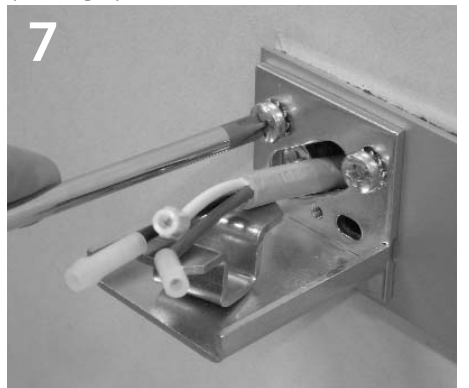

Install support bracket and trim plate to mounting plate using (2) M5 x 8mm screws with lock washers (provided). Level bracket and tighten screws. Route connector cord through opening in bracket, as shown.

Product to be installed by qualified electrician only.

PART # 04040645-01 REV .01

## Wall Mount Installation Instructions continued...

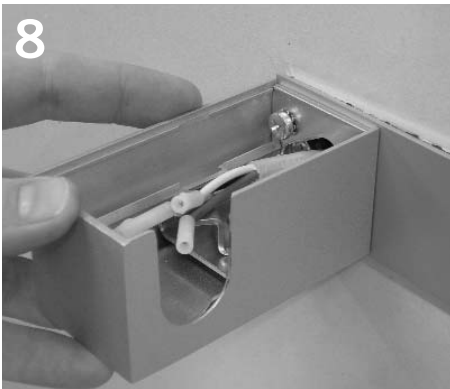

8  
Slide end block onto support bracket.  
NOTE: Opening in end block should face in direction of blank portion of trim plate, as shown.

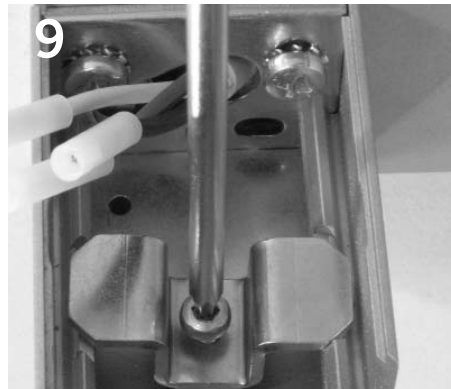

9  
Rotate support bracket lock to engage end block, as shown. Tighten screw to secure.

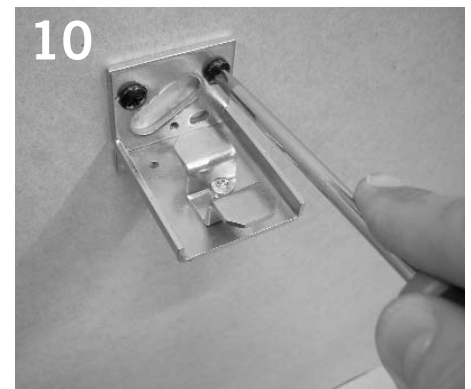

10  
Install support bracket at opposite end of luminaire run with (2) #10 screws (not provided). Level bracket and tighten screws. NOTE: Mid-run joiner installed in same manner.

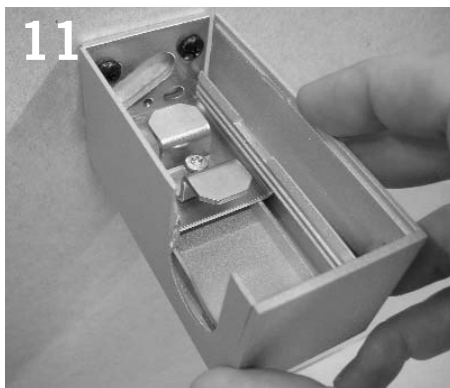

11  
Slide end/ joiner block onto support bracket.



12  
Rotate support bracket lock to engage end block, as shown. Tighten screw to secure.



13  
Slide luminaire body into slot in end blocks.



13a  
NOTE: To attach luminaire body to end block, arrow on rotation bushing must be oriented away from cut out on end block, as shown.



14  
If applicable, connect like-colored electrical leads at joiner block at opposite end of luminaire body.



15  
Connect like-colored electrical leads at power feed.

Product to be installed by qualified electrician only.

PART # 04040645-01 REV .01

## Wall Mount Installation Instructions continued...

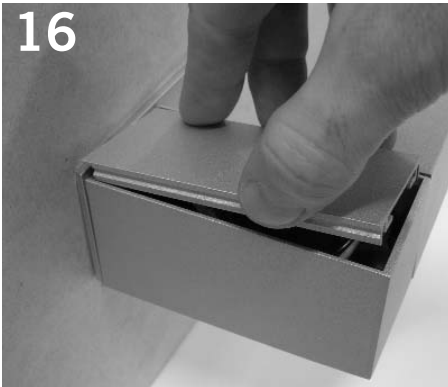

16 Snap end block covers into place.  
NOTE: Cover lip should face wall.



17 Remove diffuser and install lamp per relamp label. Replace diffuser.



18 Rotate luminaire body to desired orientation.

### NO LIMIT WALL, 1-LAMP MOUNTING INFORMATION

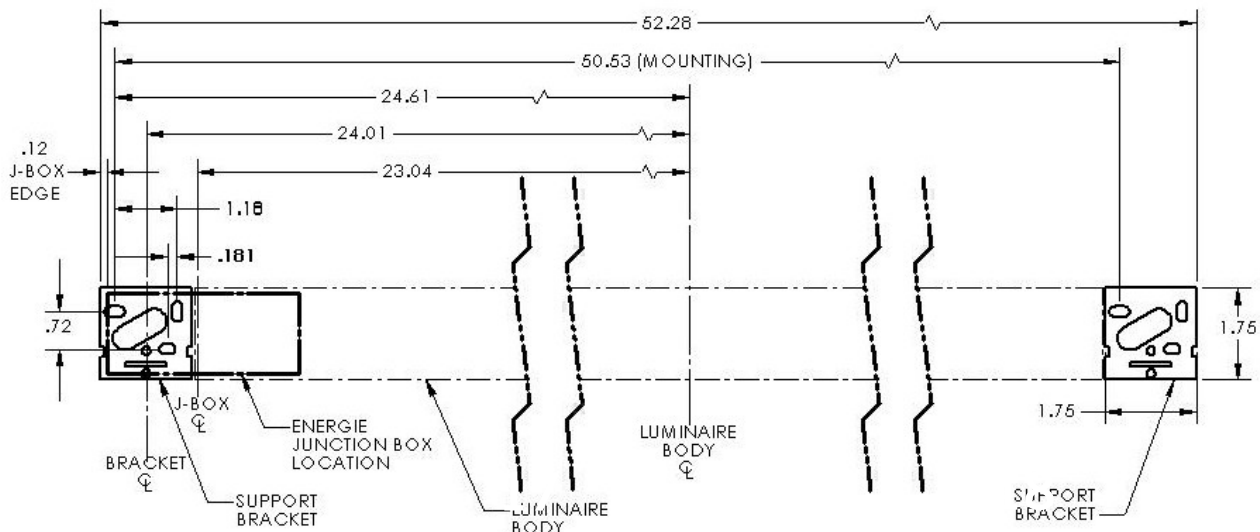

### Maximum Number of Fixtures Per Feed

LAMPING per 4' SECTION

|          | (1) T5 | (1) T5HO |
|----------|--------|----------|
| 120 volt | 21     | 11       |
| 277 volt | 49     | 25       |

## EMC Installation Instructions

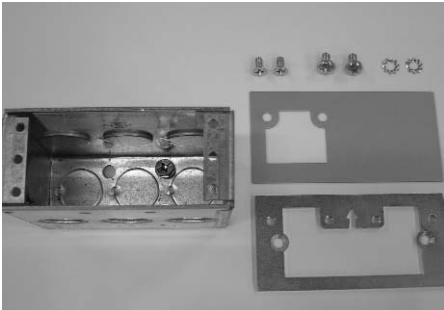

### EMC WALL MOUNT FEED KIT CONTENTS:

- One (1) Energie Junction Box
- One (1) Wall Mounting Plate
- One (1) Wall Trim Plate
- Two (2) #8-32 x 3/8 Flathead (FH) Screws
- Two (2) M5 x 8mm Panhead (PH) Screws
- Two (2) #10 Lock Washers



1  
Loosen support bracket lock and rotate it 90°.



2  
Remove support bracket from end block.



3  
Install Energie junction box horizontally into wall.

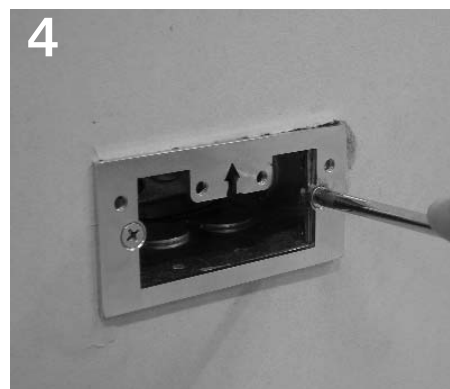

4  
Install mounting plate onto junction box using (2) #8-32 FH screws (provided). NOTE: Orient mounting plate with arrow pointing up.

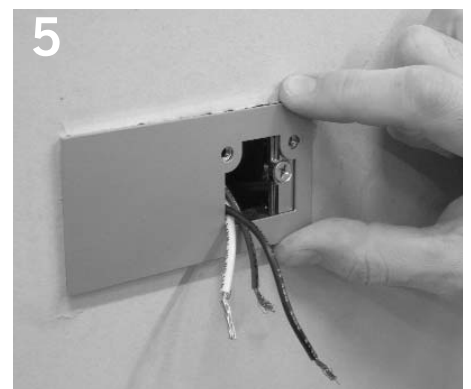

5  
Place trim plate over mounting plate and route connector cord through opening.



6  
Install support bracket and trim plate to mounting plate using (2) M5 x 8mm screws with lock washers (provided). Level bracket and tighten screws. Route leads through opening in bracket.

Product to be installed by qualified electrician only.

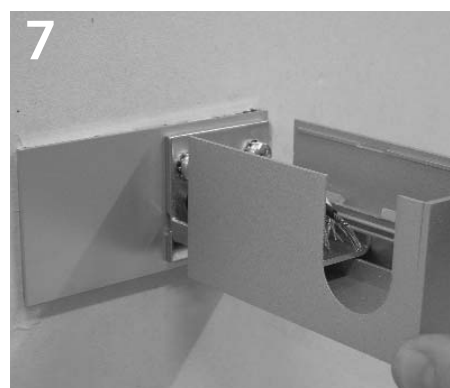

7  
Slide end block onto support bracket. NOTE: Opening in end block should face in direction of blank portion of trim plate, as shown.



8  
Rotate support bracket lock to engage end block, as shown. Tighten screw to secure.

PART # 04040645-01 REV .01

## EMC Installation Instructions continued...

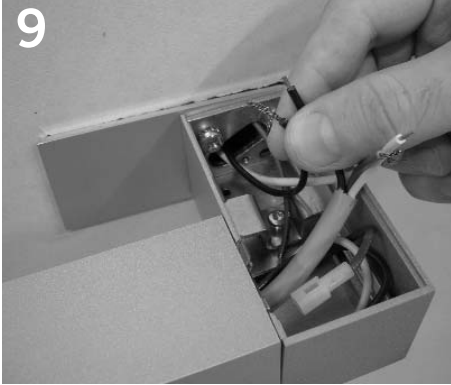

9  
Install luminaire body per instructions.  
Make EMC electrical connection.



10  
Snap end block covers into place.  
NOTE: Cover lip should face wall.