

## Pendant Mount Suspension and Feed Kit Contents

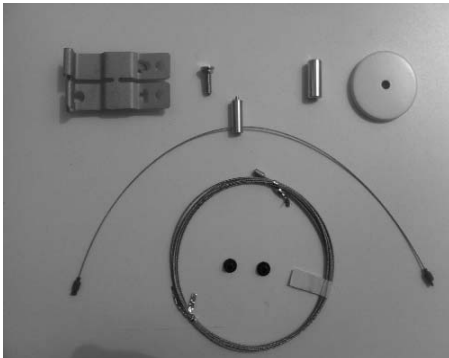

### PENDANT SUSPENSION KIT CONTENTS:

- One (1) 6.5' x 3/64 Aircraft Cable
- One (1) 15" x 3/64 Aircraft Cable w/ Gripper
- One (1) M4 Knurled Locking Screw
- Two (2) Plastic Retaining Plugs
- One (1) 1/4-20 Barrel Nut
- One (1) 2" Ceiling Canopy
- One (1) IDS Caddy Clip with 1/4-20 Stud

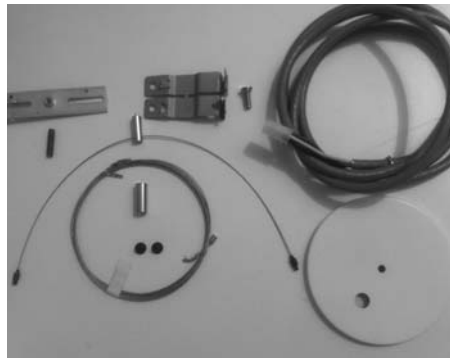

### PENDANT FEED KIT CONTENTS:

- One (1) 6.5' x 3/64 Aircraft Cable
- One (1) 15" x 3/64 Aircraft Cable w/ Gripper
- One (1) M4 Knurled Locking Screw
- Two (2) Plastic Retaining Plugs
- One (1) 1/4-20 Barrel Nut
- One (1) 4-15/16" Ceiling Canopy
- One (1) Plastic Bushing
- One (1) 8' SJT Cord w/ Connectors (1) End
- One (1) 4-3/16" L Cross Bar
- One (1) 1/4-20 x 1" Stud
- One (1) IDS Caddy Clip with 1/4-20 Stud

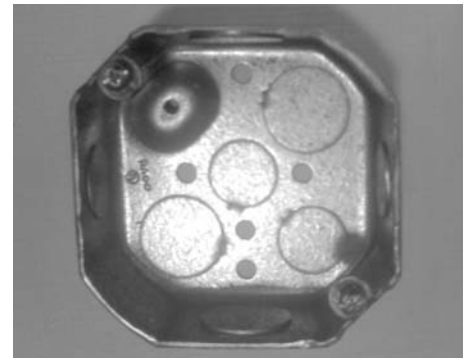

### SUPPLIED BY CONTRACTOR:

- One (1) Octagonal Junction Box

**Note:** Luminaire must be tied to structure per local requirements.

## Pendant Mount Suspension Kit Installation Instructions



1 Fasten caddy clip around spline.

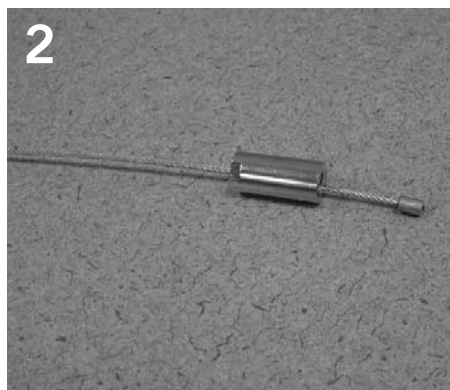

2 Insert swaged suspension cable through threaded barrel.



3 Secure non-feed canopy to 1/4-20 x 1 1/2" length stud with threaded barrel.

Product to be installed by qualified electrician only.

PART #04040652-01 REV .01

## Pendant Mount Feed Kit Installation Instructions

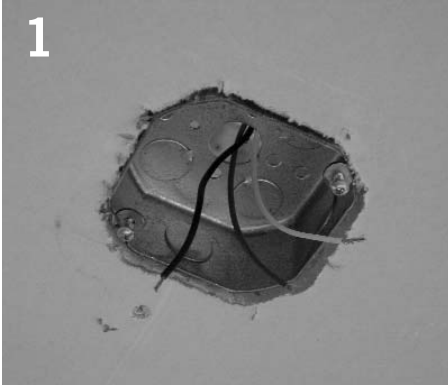

1  
Install 4" octagon junction box (not provided) into ceiling.

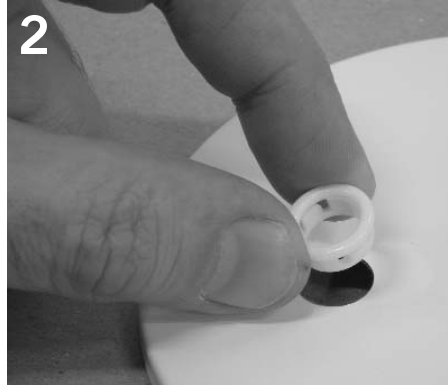

2  
Insert bushing into feed canopy.

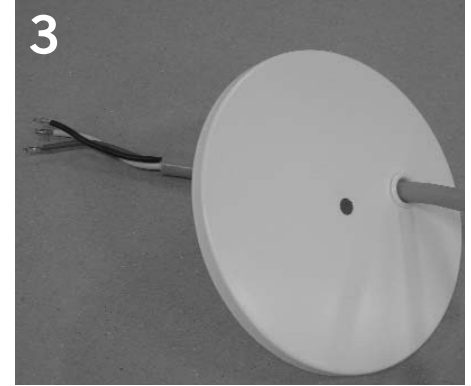

3  
Slide power cord through feed canopy and make electrical connections to pre-installed junction box.

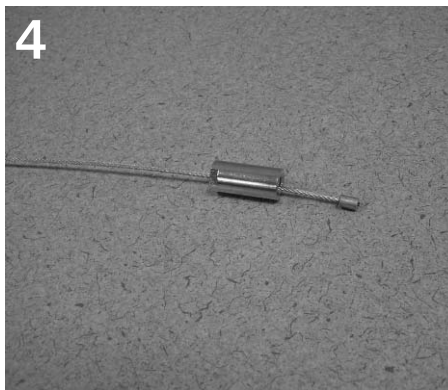

4  
Insert swaged suspension cable through threaded barrel.



5  
Secure feed canopy to 1/4-20 x 1 1/2" length stud with threaded barrel.

# LUCEO PENDANT MODULAR

énergie

## Suspending the Fixtures

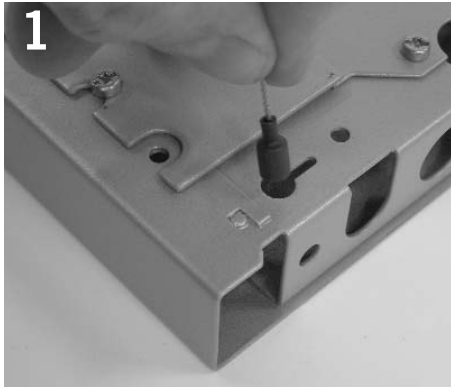

1  
Insert V-cable ends into keyslots at each end of luminaire body.

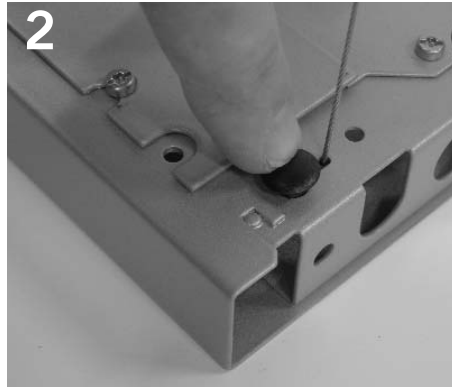

2  
Insert retaining plug into large end of each keyslot.

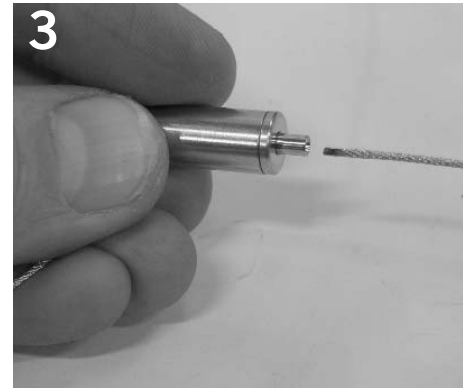

3  
Install suspension cable into gripper attached to V-cables at each end of luminaire.

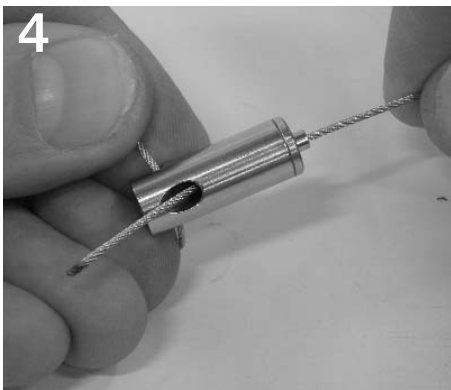

4  
Adjust and level luminaire by pushing suspension cable into gripper until desired height achieved. Trim excess cable from side of gripper.

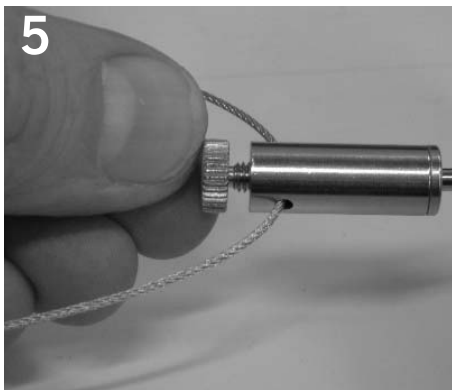

5  
Secure gripper by inserting and tightening locking screw at gripper bottom.

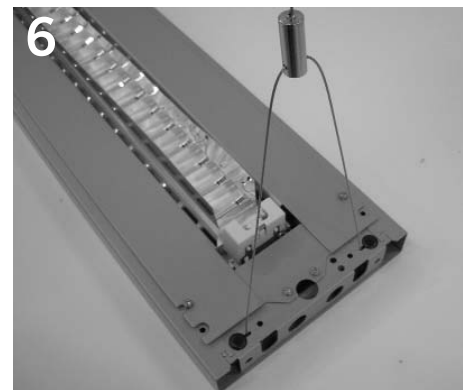

6  
Final suspension cable, gripper, and V-cable should be configured as shown.

## Electrical Feed Connection

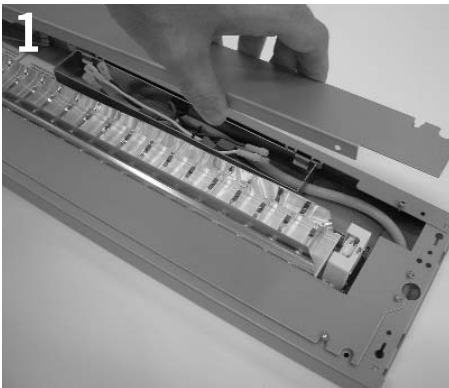

1 Remove splice compartment cover.

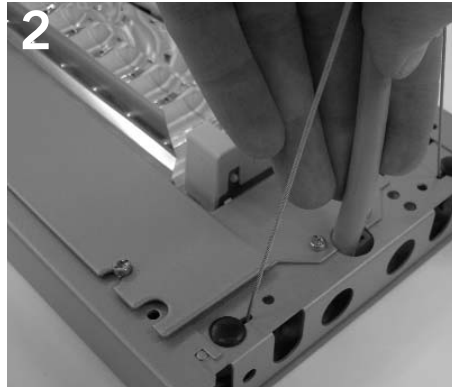

2 Feed power cord into luminaire body.

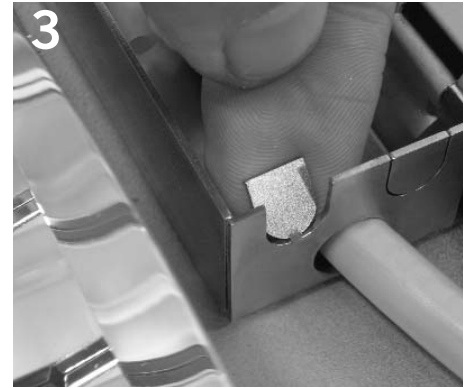

3 Remove tab in splice compartment for cord entry.



4 Seat cord into void left from tab removal.  
NOTE: Cord must be properly seated for replacement of splice compartment cover.



5 Connect power cord to jumper wires inside splice compartment.

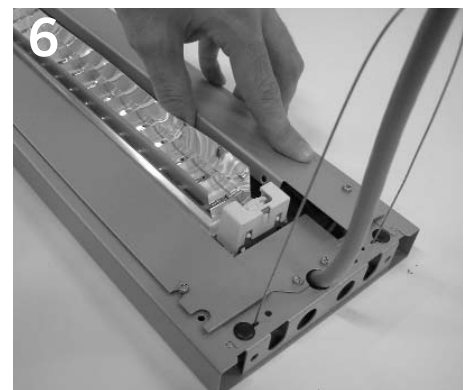

6 Reinstall splice compartment cover and secure by tightening screws.

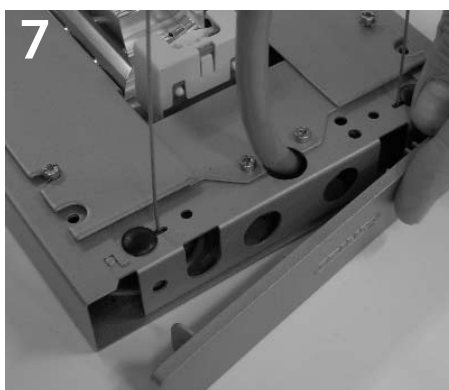

7 Snap endcap into place.

## Maximum Run Length Per Feed

	LAMPING per 4' SECTION			
	(1) T5	(2) T5	(1) T5HO	(2) T5HO
<b>120 volt</b>	147'	71'	76'	40'
<b>277 volt</b>	343'	174'	178'	89'

Note: Run lengths based on fixtures with standard ballast. Dimming ballasts, battery packs, separate switching and specified ballasts should be verified by an electrical engineer.

## Joining the Fixtures

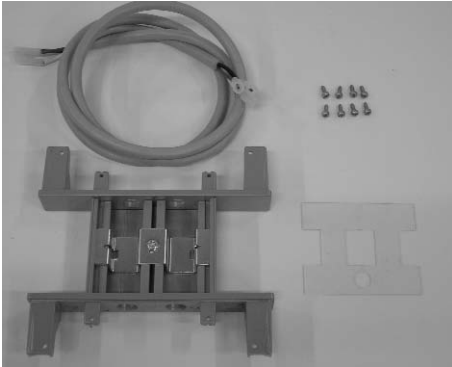

### PENDANT JOINER KIT CONTENTS:

- One (1) Pendant Coupler
- One (1) Clear Plastic Coupler Cover
- Eight (8) M3 x 12 T10 Drive Screws
- One (1) 50" SJT Cord w/ M/F Connectors

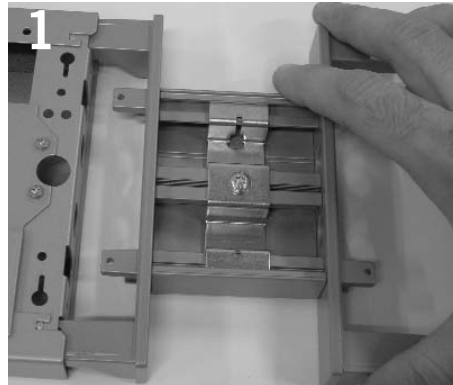

Insert joiner into end of luminaire body.

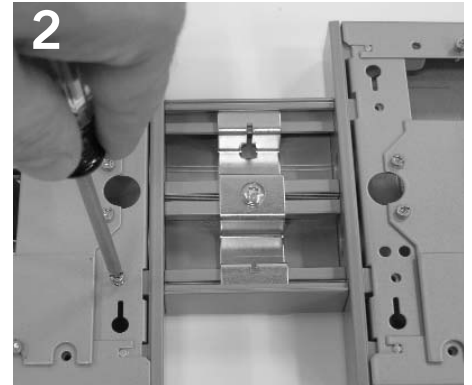

Install (8) screws (provided) to secure joiner to luminaire bodies.



Insert connection cord through luminaires-- as shown.

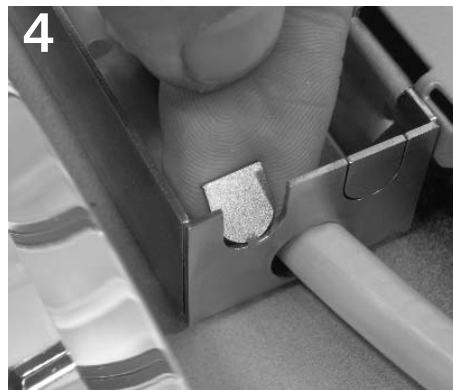

Remove tab in splice compartment for cord entry.



Seat cord into void left from tab removal. NOTE: Cord must be properly seated for replacement of splice compartment cover.



Connect joiner cord to jumper wires inside splice compartment.



Install support cable into slots in joiner bracket.



Install clear joiner cover as shown.

Product to be installed by qualified electrician only.

PART # 04040652-01 REV .01

## Joining the Fixtures with Node

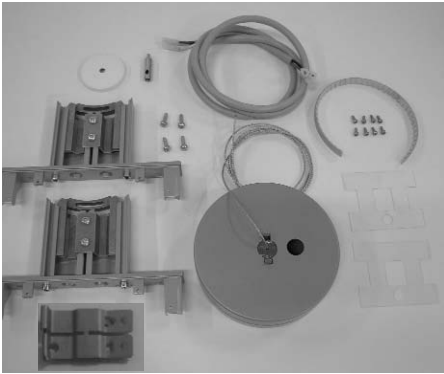

### PENDANT JOINER NODE KIT CONTENTS:

- One (1) Pendant Node w/ 6.5' Aircraft Cable
- One (1) Plastic Node Shield
- Two (2) Pendant Node Couplers
- Two (2) Clear Plastic Node Coupler Covers
- Eight (8) M3 x 12 T10 Drive Screws
- Four (4) M4 x 15 T20 Drive Screws w/ Lock Washers
- One (1) 62" SJT Cord w/ M/F Connectors
- One (1) 2" Ceiling Canopy
- One (1) 1/4-20 Threaded Cable Gripper
- One (1) IDS Caddy Clip with 1/4-20 Stud



1 Remove node cover.

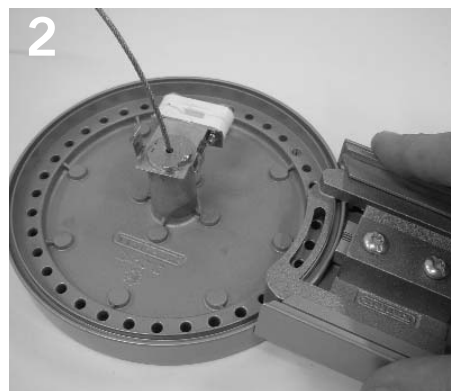

2 Insert node coupler into node.

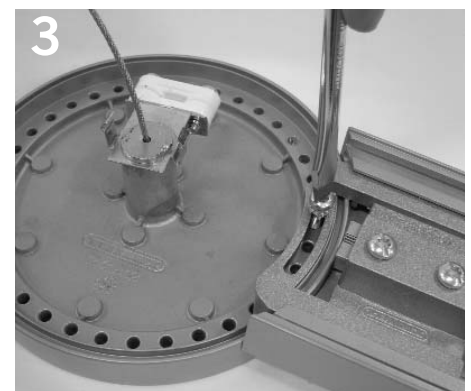

3 Secure node coupler by installing (2) screws (provided).

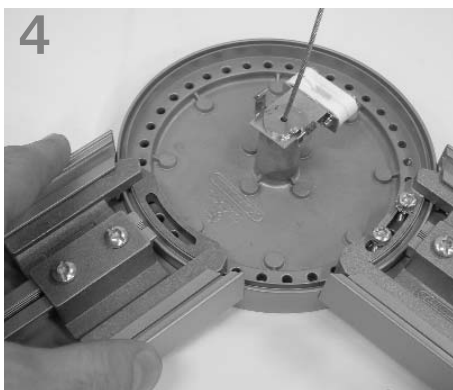

4 Install second node coupler into node and secure with provided screws. Node couplers may be positioned from 90° to 150°.

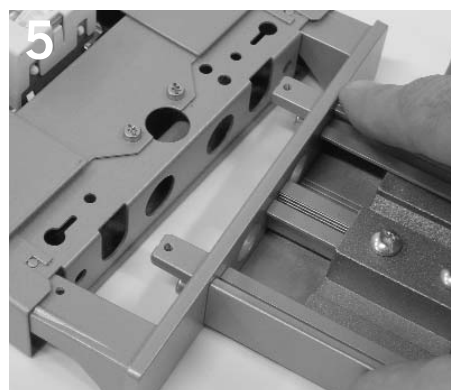

5 Insert node coupler into end of luminaire body.

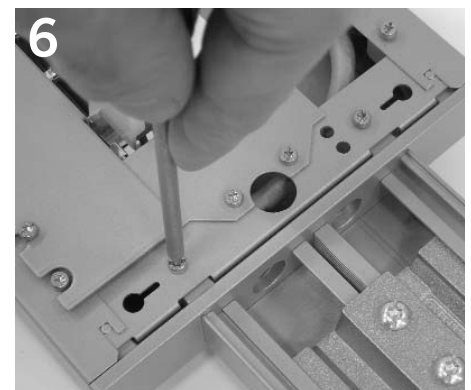

6 Secure node coupler to luminaire by installing (4) screws (provided). Repeat steps 5 & 6 with second luminaire.

Product to be installed by qualified electrician only.

PART # 04040652-01 REV .01

## Joining the Fixtures with Node

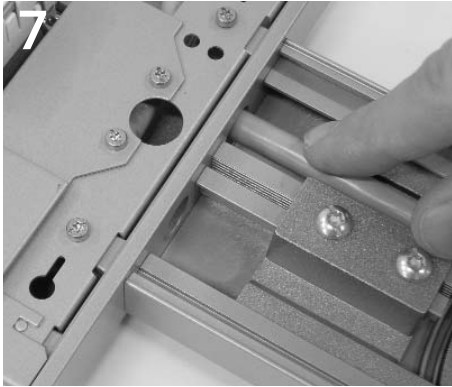

7  
Insert cord from node coupler into luminaire body.

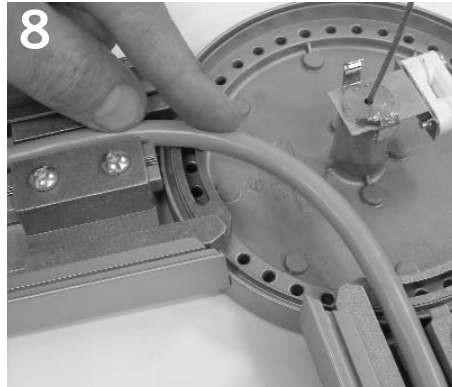

8  
Route node joiner cord through node, as shown, and into second luminaire body.

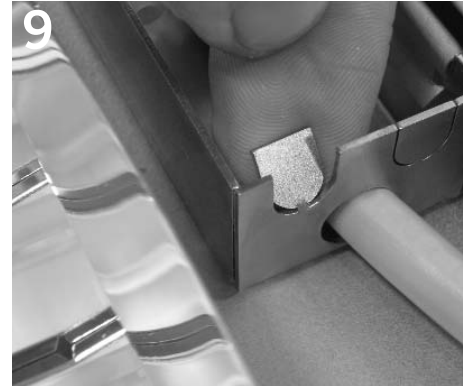

9  
Remove tab in splice compartment for cord entry.



10  
Seat cord into void left from cord removal. NOTE: Cord must be properly seated for replacement of splice compartment cover.



11  
Connect node joiner cord to jumper wires inside splice compartment.

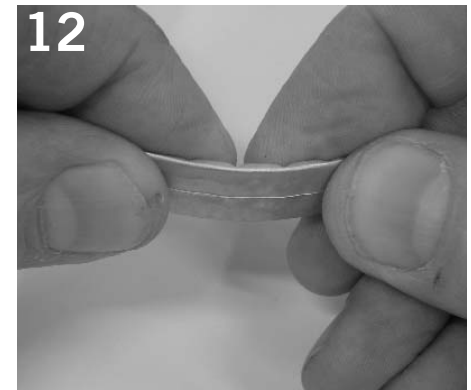

12  
Break node shield in lengths to fill gaps between node joiners.

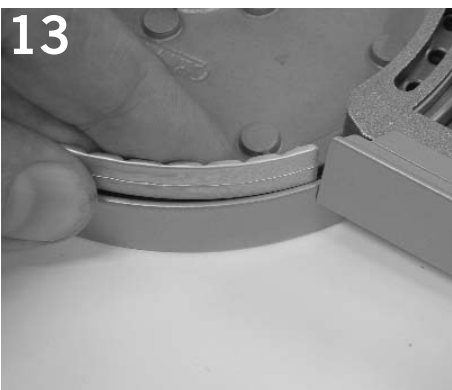

13  
Insert node shield pieces in node to close gaps between node joiners.

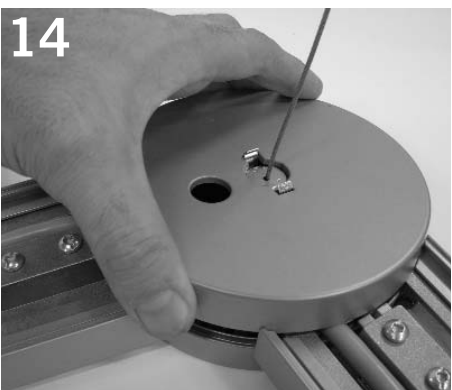

14  
Reinstall node cover.



15  
Install clear plastic node coupler covers, as shown.

Product to be installed by qualified electrician only.

PART # 04040652-01 REV .01

## Joining the Fixtures with Node

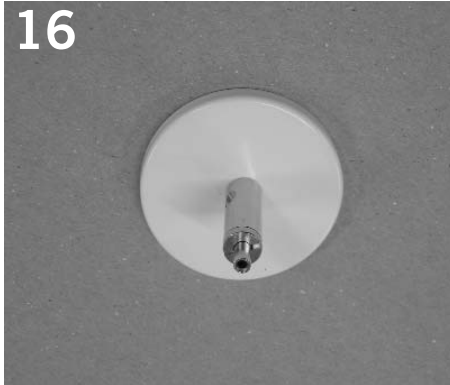

Install canopy over 1/4-20 stud and secure with gripper.



Insert cable from node into gripper. Adjust to desired height. Cut excess cable.



## EMC Feed and Luminaire Installation

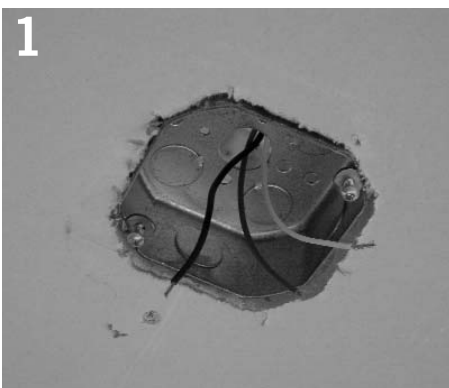

1 Install 4" octagon junction box (not provided) into ceiling.

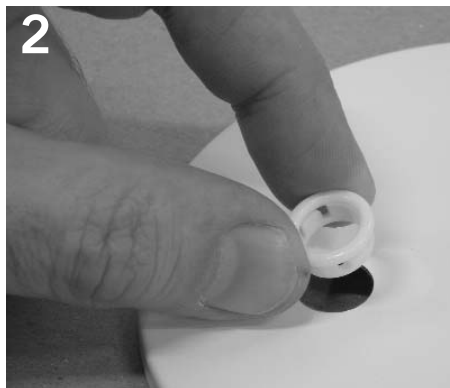

2 Insert bushing into feed canopy.

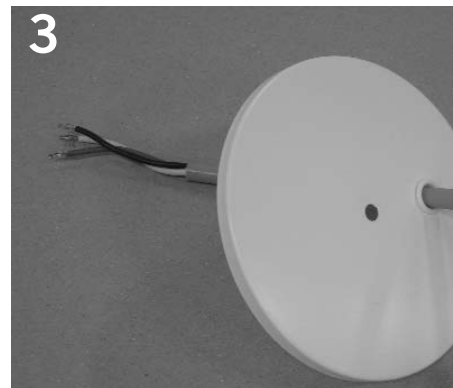

3 Slide power cord through feed canopy and make electrical connections to pre-installed junction box..



4 Insert swaged suspension cable through threaded barrel.

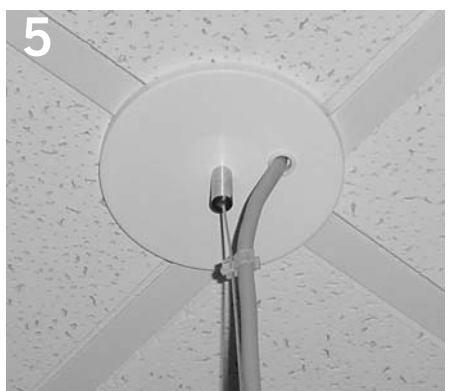

5 Secure feed canopy to 1/4-20 x 1 1/2" length stud with threaded barrel.

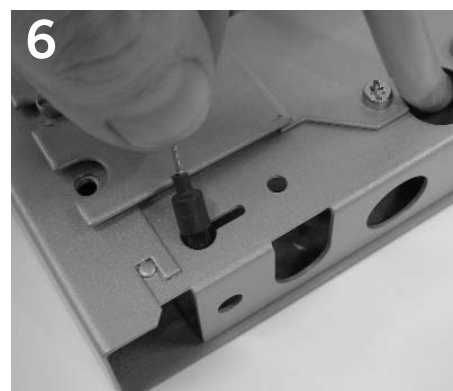

6 Insert V-cable ends into keyslots at each end of luminaire body.

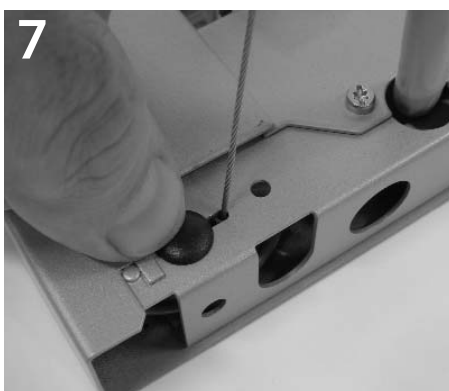

7 Insert retaining plug into large end of each keyslot.

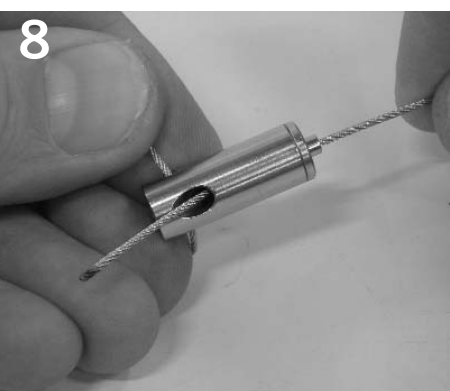

8 Adjust and level luminaire by pushing suspension cable into gripper until desired height achieved. Trim excess cable from side of gripper.

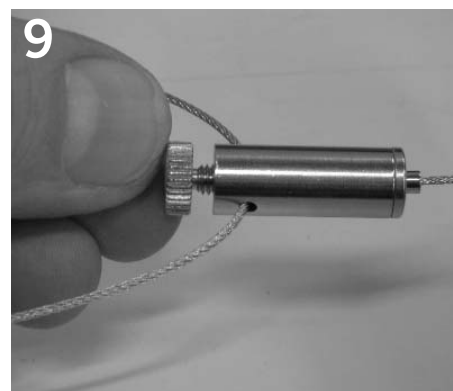

9 Secure gripper by inserting and tightening locking screw at gripper bottom

Product to be installed by qualified electrician only.

PART # 04040652-01 REV .01

## EMC Feed and Luminaire Installation



10 Final suspension cable, gripper, and V-cable should be configured as shown.

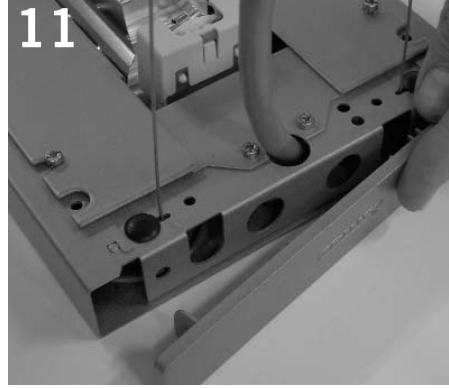

11 Snap endcap into place.

## Relamping



1 From below luminaire, remove reflector and let hang via pre-installed lanyards. Install lamp(s) as specified on relamp label.

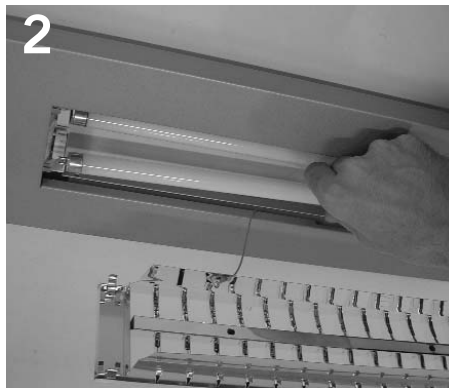

2 To reinstall reflector, carefully depress springs as shown and push reflector into luminaire body.

Product to be installed by qualified electrician only.

PART # 04040652-01 REV .01