

LUCEO PENDANT

Pendant Mount Suspension and Feed Kit Contents

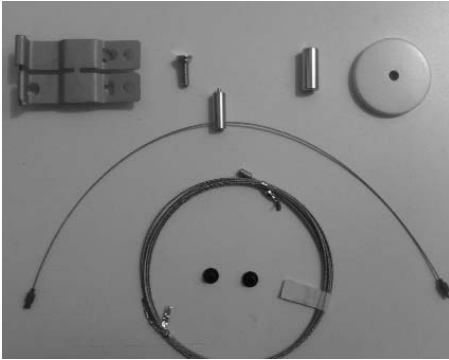

PENDANT SUSPENSION KIT CONTENTS:

- One (1) 6.5' x 3/64 Aircraft Cable
- One (1) 15" x 3/64 Aircraft Cable w/ Gripper
- One (1) M4 Knurled Locking Screw
- Two (2) Plastic Retaining Plugs
- One (1) 1/4-20 Barrel Nut
- One (1) 2" Ceiling Canopy
- One (1) Caddy IDS with 1/4-20 Stud

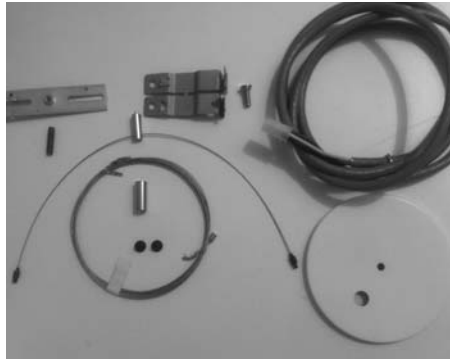

PENDANT FEED KIT CONTENTS:

- One (1) 6.5' x 3/64 Aircraft Cable
- One (1) 15" x 3/64 Aircraft Cable w/ Gripper
- One (1) M4 Knurled Locking Screw
- Two (2) Plastic Retaining Plugs
- One (1) 1/4-20 Barrel Nut
- One (1) 4-15/16" Ceiling Canopy
- One (1) Plastic Bushing
- One (1) 8' SJT Cord w/ Connectors (1) End
- One (1) 4-3/16" L Cross Bar
- One (1) 1/4-20 x 1" Stud
- One (1) Caddy IDS with 1/4-20 Stud

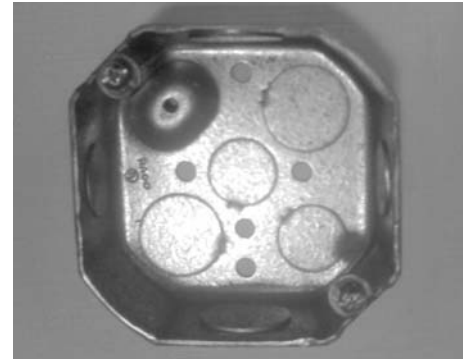

SUPPLIED BY CONTRACTOR:

- One (1) Octagonal Junction Box

Note: Luminaire must be tied to structure per local requirements.

Pendant Mount Feed Location on Grid Installation Instructions

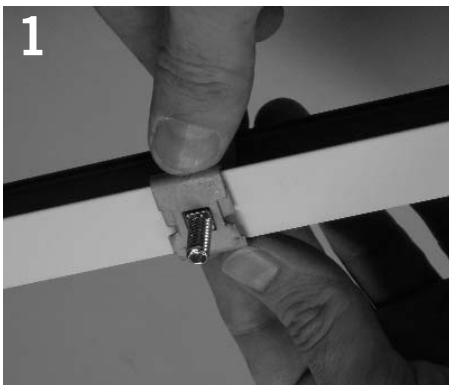

1
To assemble the Caddy Clip start by separating each half of the clip. Place the threaded stud in the square hole on one half. Place the two halves around the T-grid Ceiling and press together. The integrated tabs will then lock together.

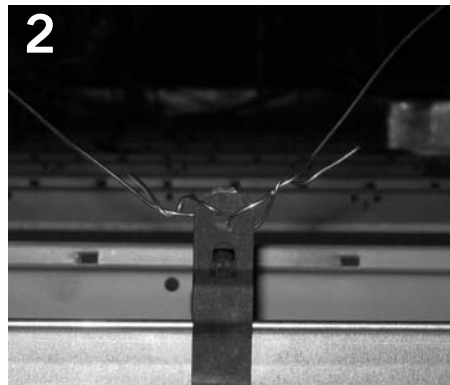

2
Attach the Caddy/B-line clip to the T-grid ceiling as shown. Make sure to tie the clip off to the ceiling structure in a "V" Pattern or directly above the suspension point. This will reduce torsion to the T-grid.

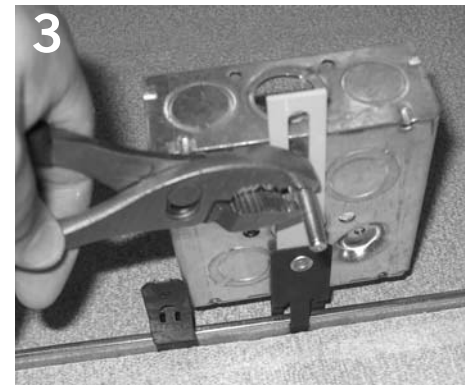

3
Attach the J-box to the Caddy/B-Line clip as shown. Make sure to secure the J-box with a screw. Run conduit to J-box with proper feed wiring for that location.

Product to be installed by qualified electrician only.

PART# 04040651-01 REV .01

LUCEO PENDANT

énergie™

Installation Instructions Continued...

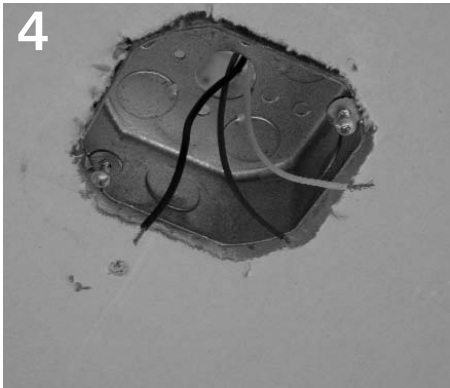

4 For Hard Ceiling, install 4" octagonal junction box into ceiling.

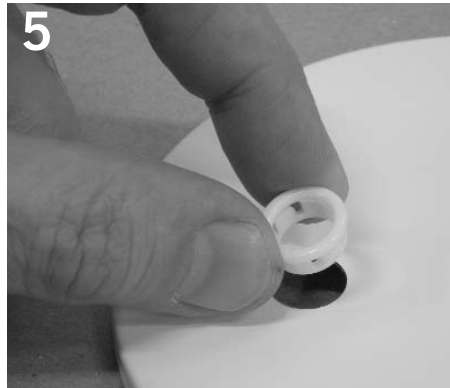

5 Insert bushing into feed canopy.

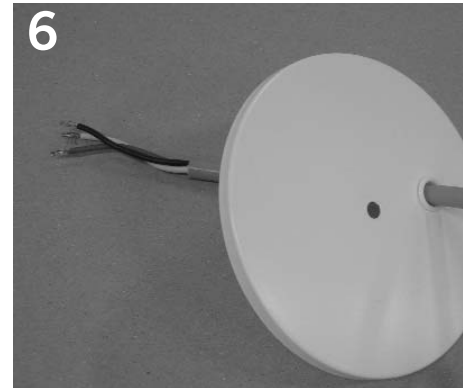

6 Slide power cord through feed canopy and make electrical connections to pre-installed junction box.



7 Insert swaged suspension cable through threaded barrel.



8 Secure feed canopy to 1/4-20 x 1 1/2" length stud with threaded barrel.



9 Secure non-feed canopy to 1/4-20 x 1 1/2" length stud (not provided) or caddy clip with threaded barrel.



10 Insert V-cable ends into keyslots at each end of luminaire body.

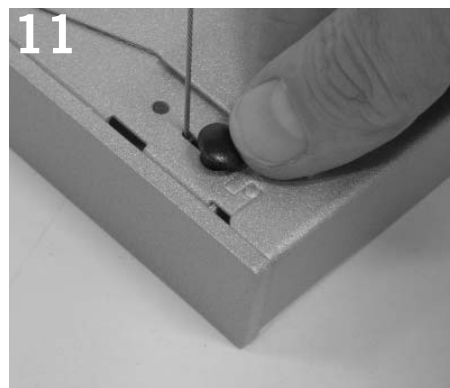

11 Insert retaining plug into large end of each keyslot.

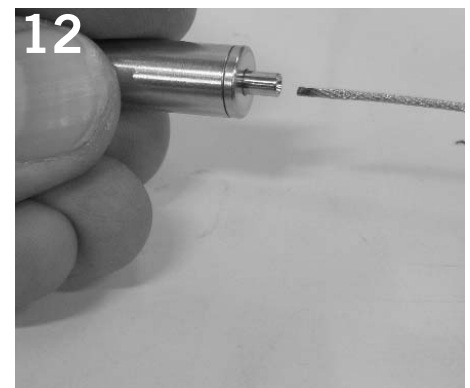

12 Slide non-swaged end of suspension cable into cable grippers.

Product to be installed by qualified electrician only.

PART# 04040651-01 REV .01

LUCEO PENDANT

énergie™

Installation Instructions Continued...

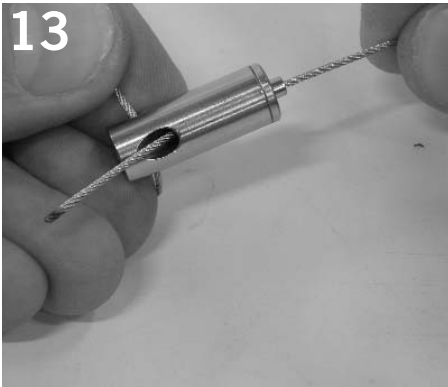

13 Adjust and level luminaire by pushing suspension cable into gripper until desired height is achieved. Trim excess cable from side of gripper.

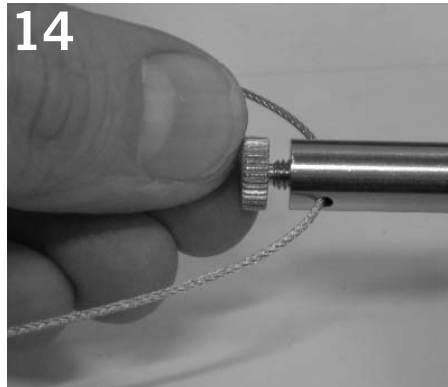

14 Secure gripper by inserting and tightening locking screw at gripper bottom.

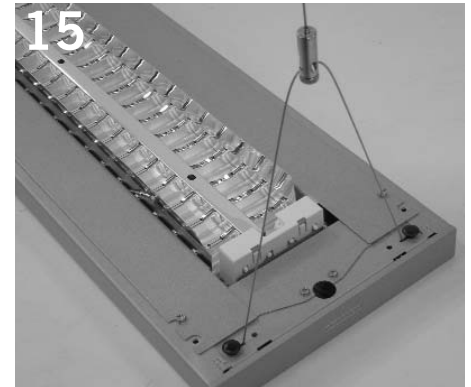

15 Final suspension cable, gripper and V-cable should be configured as shown.



16 From below luminaire, remove reflector and let hang via pre-installed lanyards. Install lamps as specified on relamp label.



17 To reinstall reflector, carefully depress springs as shown and push reflector into luminaire body.