

ENFORM / ENSPIRE / ENTHUSE énergie

Enform Shown Unless Otherwise Noted

Surface Mount Suspension Kit Installation Instructions

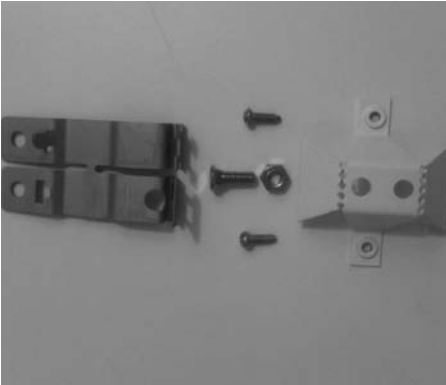

SURFACE SUSPENSION KIT CONTENTS:

- One (1) white steel mounting bracket
- Two (2) #10 machine screws
- One (1) 1/4x20 nut
- One (1) Caddy IDS Clip

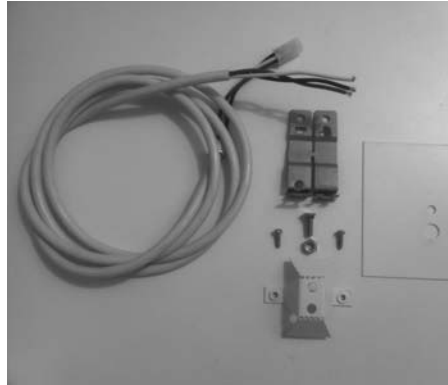

SURFACE FEED KIT INCLUDES:

- One (1) 18" SJT Cord with Hog Ring
- One (1) 4" J-Box Cover Plate
- One (1) white steel mounting bracket
- Two (2) #10 machine screws
- One (1) 1/4x20 nut
- One (1) Caddy IDS Clip



ENFORM 1 & 2 ENDCAP KIT INCLUDES:

- Two (2) Die-Cast Endcaps
- Four (4) #10 Machine Screws

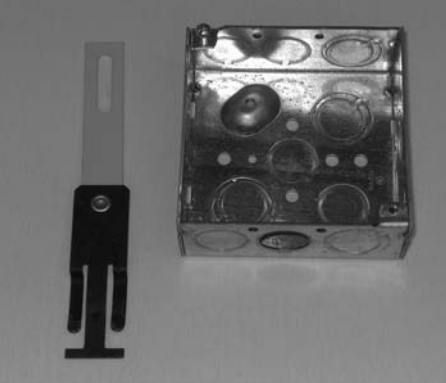

SUPPLIED BY CONTRACTOR FOR INSTALLATION OF ON GRID FIXTURES:

- One (1) square J-box
- One (1) Caddy DFN or B-Line BA-311 J-box securing clip



SUPPLIED BY CONTRACTOR FOR INSTALLATION OF OFF GRID FIXTURES:

- One (1) octagonal J-box
- One (1) 1/4-20 threaded rod and nut
- Two (2) electrical box hangers

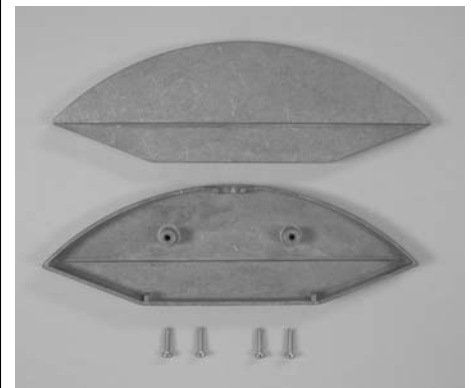

ENSPIRE ENDCAP KIT INCLUDES:

- Two (2) Die-Cast Endcaps
- Four (4) #10 Machine Screws

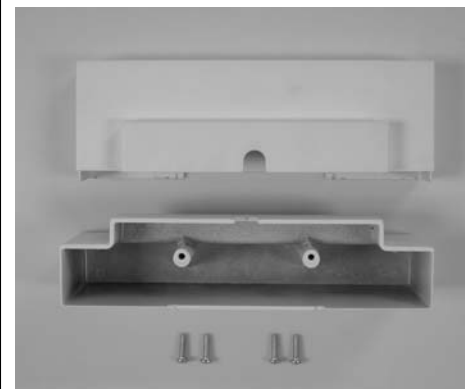

ENTHUSE ENDCAP KIT INCLUDES:

- Two (2) Die-Cast Endcaps
- Four (4) #10 Machine Screws

Note: Luminaire must be tied to structure per local requirements.

Product to be installed by qualified electrician only.

Separation of circuits in the outlet box are to be made in accordance with local and/or national electrical installation codes.

PART #04040612-01

ENFORM / ENSPIRE / ENTHUSE énergie

Surface Mount Feed Location On Grid Ceiling

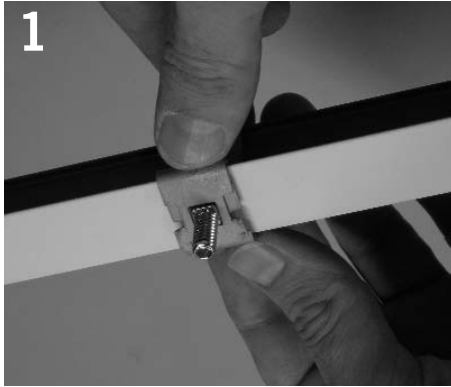

1
To assemble the Caddy Clip start by separating each half of the clip. Place the threaded stud in the square hole on one half. Place the two halves around the T-grid Ceiling and press together. The integrated tabs will then lock together.

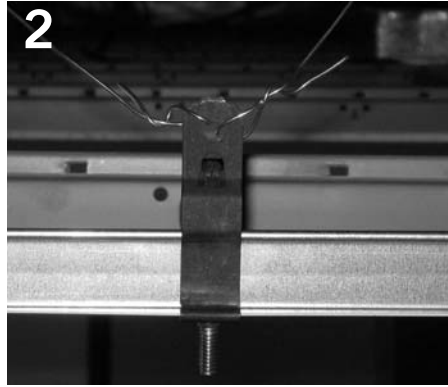

2
Attach the Caddy/B-line clip to the T-grid ceiling as shown. Make sure to tie the clip off to the ceiling structure in a "V" Pattern or directly above the suspension point. This will reduce torsion to the T-grid.

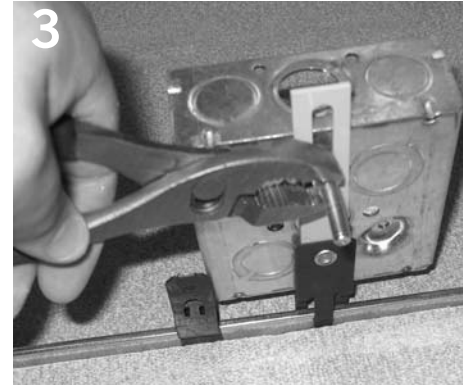

3
Attach the J-box to the Caddy/B-Line clip as shown. Make sure to secure the J-box with a screw. Run conduit to J-box with proper feed wiring for that location.

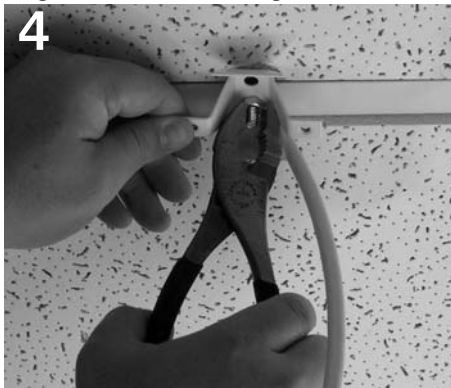

4
At feed end, make the electrical connection. Place suspension bracket over 1/4-20 stud and fasten the suspension bracket using 1/4-20 nut. Bend tabs down to close surface mount bracket side openings.



5
To install fixture, remove louver & lamp. Raise fixture to bottom of mounting bracket and make the electrical connection. Insert machine screws through the holes in the top of the light fixture end bracket. Tighten screws to secure fixture.

Product to be installed by qualified electrician only.

Separation of circuits in the outlet box are to be made in accordance with local and/or national electrical installation codes.

PART #04040612-01

Surface Mount Suspension Location On Grid Ceiling

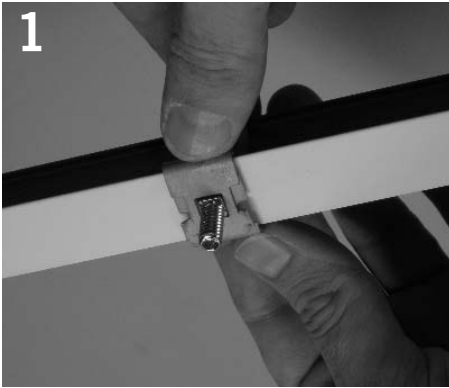

1
To assemble the Caddy Clip start by separating each half of the clip. Place the threaded stud in the square hole on one half. Place the two halves around the T-grid Ceiling and press together. The integrated tabs will then lock together.

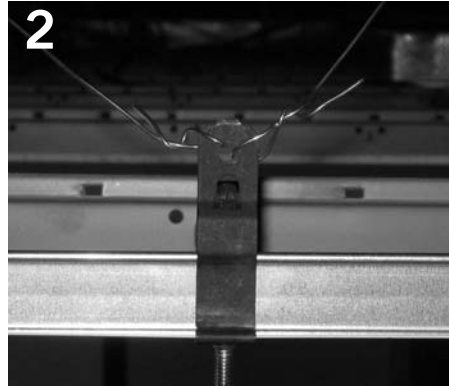

2
Attach the Caddy/B-line clip to the T-grid ceiling as shown. Make sure to tie the clip off to the ceiling structure in a "V" Pattern or directly above the suspension point. This will reduce torsion to the T-grid.

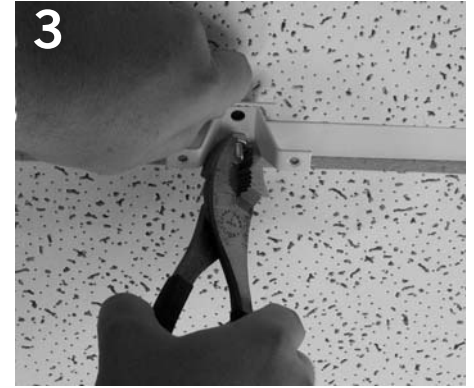

3
Secure the mounting bracket to the 1/4-20 Stud using 1/4-20 nut. Bend tabs down to close the surface mount bracket side openings.

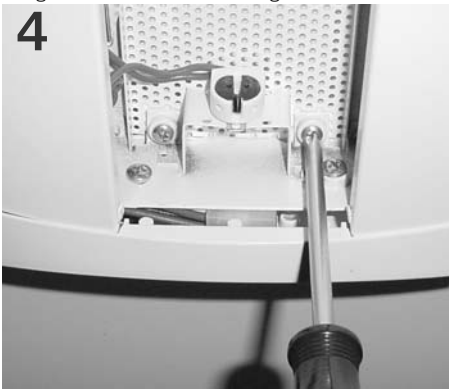

4
To install fixture, remove louver & lamp. Raise fixture to bottom of mounting bracket and insert machine screws through the holes in the top of the light fixture end bracket. Tighten screws to secure fixture.

Product to be installed by qualified electrician only.

Separation of circuits in the outlet box are to be made in accordance with local and/or national electrical installation codes.

PART #04040612-01

Surface Mount Feed Location Off Grid/Hard Ceiling



1
If using a T-grid ceiling, attach the Caddy/B-line crossbar to the T-grid ceiling as shown. Make sure to tie the crossbar off to the ceiling structure.



2
If using a T-grid ceiling, attach the octagonal J-box to the Caddy/B-Line bar as shown. If installing in a hard ceiling mount the j-box to a structure. Run conduit to J-box with proper feed wiring for that location.



3
Attach a j-box strap to the j-box with the 1/4-20 stud hanging down.



4
At feed end, pass feed cord through j-box cover plate and make the electrical connection. Place j-box cover plate over 1/4-20 stud and fasten the suspension bracket assembly to the j-box coverplate, using 1/4-20 nut. Bend tabs down to close surface mount bracket side openings.



5
To install fixture, remove louver & lamp. Raise fixture to bottom of mounting bracket and insert machine screws through the holes in the top of the light fixture end bracket. Tighten screws to secure fixture.

Product to be installed by qualified electrician only.

Separation of circuits in the outlet box are to be made in accordance with local and/or national electrical installation codes.

PART #04040612-01

Surface Mount Suspension Location Off Grid/Hard Ceiling



1
If using a T-grid ceiling, attach the Caddy/B-line crossbar to the T-grid ceiling as shown. Make sure to tie the crossbar off to the ceiling structure per code.



2
If using T-grid Ceiling, run threaded 1/4-20 rod through crossbar and secure with 1/4-20 nuts, allowing enough length to connect to mounting bracket below the ceiling line.

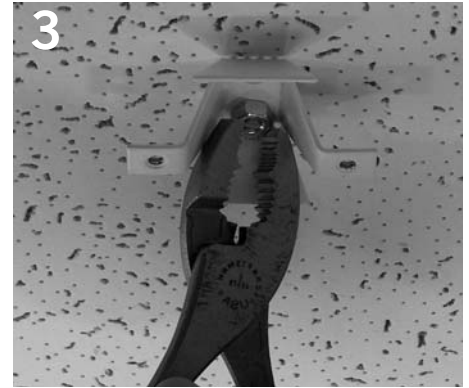

3
Secure the mounting bracket to the 1/4-20 Stud. Bend tabs down to close the surface mount bracket side openings.



4
To install fixture, remove louver & lamp. Raise fixture to bottom of mounting bracket and insert machine screws through the holes in the top of the light fixture end bracket. Tighten screws to secure fixture.

Product to be installed by qualified electrician only.

Separation of circuits in the outlet box are to be made in accordance with local and/or national electrical installation codes.

PART #04040612-01

ENFORM / ENSPIRE / ENTHUSE énergie

Installing Endcaps (Enform Pendant Fixture Shown)

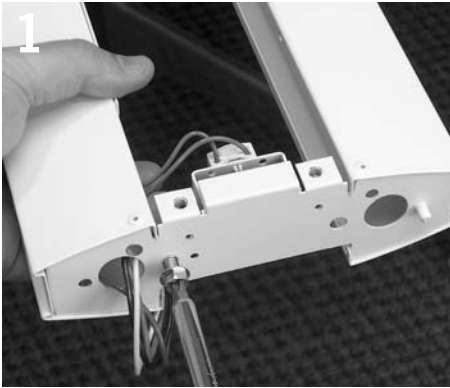

1
Remove the ¼-20 bolt from the end of the fixture run. Make sure that the excess feed cord and wiring harness is pushed back into the light fixture wire way.

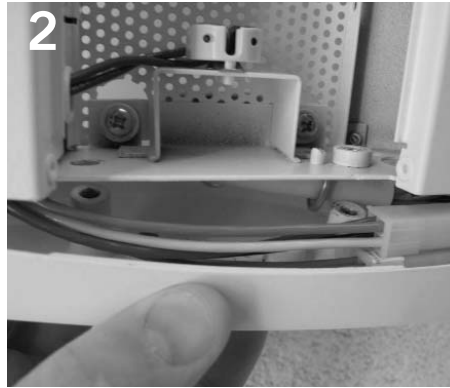

2
Back off the supplied #10 machine screws in both mounting holes. Route the feed cord through the hole in the top of the endcap (Ensure that the “hog ring” is placed correctly). Snap the endcap into place.

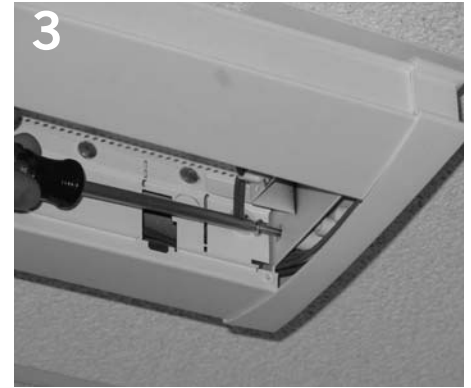

3
Attach the endcap using the supplied #10 machine screws in both mounting holes.

Installing Louvers and Lamps (Pendant Fixture Shown)



1
Install lamps into fixture as shown.

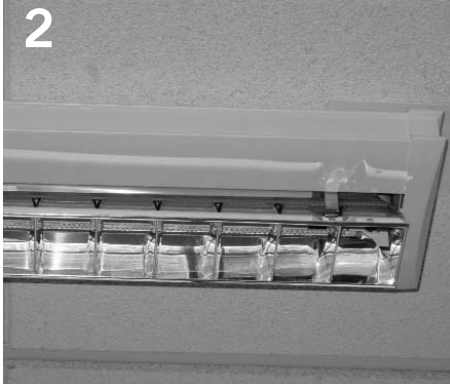

2
Place louver into housing opening and allow to be suspended for adjustment in the fixture.



3
Starting at one end, push louver so that the starting edge of the louver is as close as possible to the end of the fixture. Then push the louver into the fixture. This ensures that all louvers will be in the proper position for the entire length fixture run.

Product to be installed by qualified electrician only.

Separation of circuits in the outlet box are to be made in accordance with local and/or national electrical installation codes.

PART #04040612-01

ENFORM / ENSPIRE / ENTHUSE énergie

Surface Mounted Dimension Drawings

Enform 1



Enform 2



Enspire

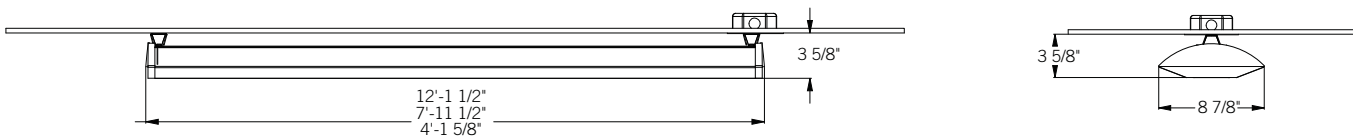

Enthuse

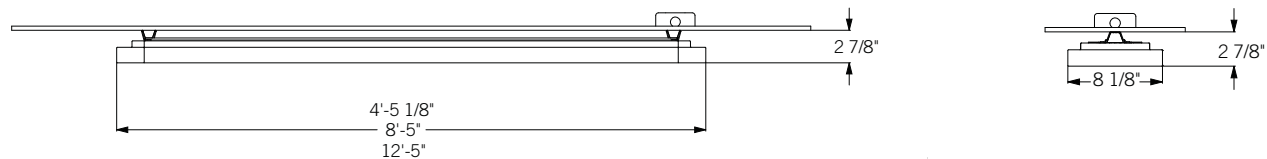

Maximum Run Length Per Feed

	LAMPING per 4' SECTION					
	(1) T5	(2) T5	(1) T5HO	(2) T5HO	(1) T8	(2) T8
120 volt	132'	64'	68'	32'	120'	72'
277 volt	308'	156'	160'	84'	284'	176'

Note: Run lengths based on fixtures with standard ballast. Dimming ballasts, battery packs, separate switching and specified ballasts should be verified by an electrical engineer.

Product to be installed by qualified electrician only.

Separation of circuits in the outlet box are to be made in accordance with local and/or national electrical installation codes.

PART #04040612-01