

# ENFORM / ENSPIRE / ENTHUSE énergie

Enform Shown Unless Otherwise Noted

## Pendant Mount Suspension Kit Contents

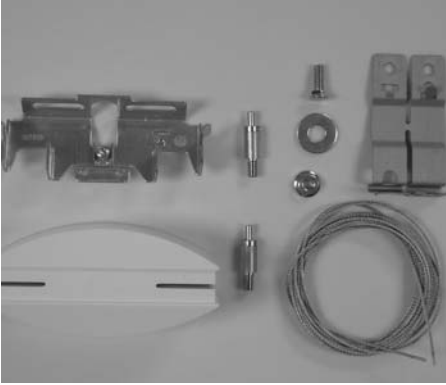

### PENDANT SUSPENSION KIT CONTENTS:

- One (1) 9' 3/32 Aircraft Cable
- Two (2) 1/4x20x1/16 Cable Grippers
- One (1) Plastic Canopy Cover
- One (1) Suspension Bracket Assembly
- One (1) Fender Washer
- One (1) 1/4-20 Nut
- One (1) Caddy IDS with 1/4-20
- One (1) 1/4 - 20 Stud

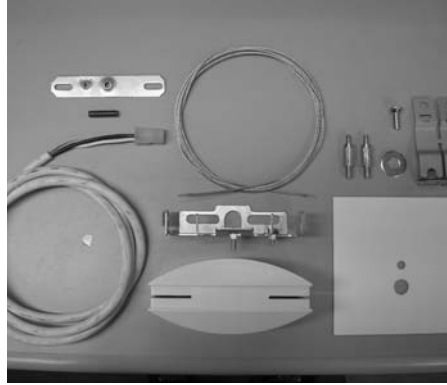

### PENDANT FEED KIT INCLUDES:

- In addition to the contents of the suspension kit
- One (1) J-Box Cover Plate
- One (1) 4' SJT Cord
- One (1) Hog Ring
- One (1) J-box Hanger Strap
- One (1) 1/4 -20 Stud



### ENFORM ENDCAP KIT INCLUDES:

- Two (2) Die-Cast Endcaps
- Four (4) #10 Machine Screws

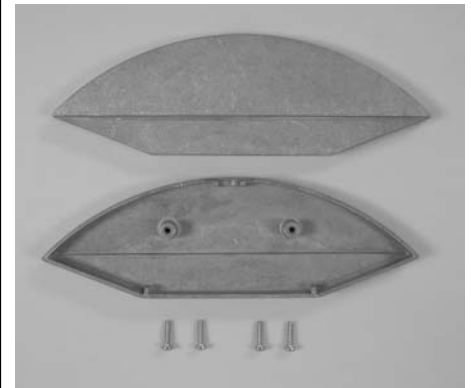

### ENSPIRE ENDCAP KIT INCLUDES:

- Two (2) Die-Cast Endcaps
- Four (4) #10 Machine Screws

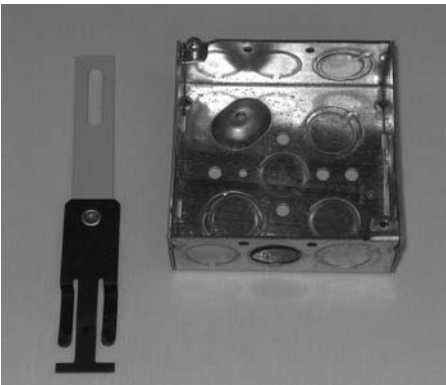

### SUPPLIED BY CONTRACTOR FOR INSTALLATION OF ON GRID FIXTURES:

- One (1) Square J-box
- One (1) Caddy DFN or B-Line BA-311 J-box Securing Clip



### SUPPLIED BY CONTRACTOR FOR INSTALLATION OF OFF GRID FIXTURES:

- One (1) Octagonal J-box
- One (1) 1/4-20 Threaded Rod and Nut
- One (1) Electrical Box Hanger

**Note:** Luminaire must be tied to structure per local requirements.

Product to be installed by qualified electrician only.

Separation of circuits in the outlet box are to be made in accordance with local and/or national electrical installation codes.

PART #04040610-01, Rev A

## Pendant Mount Feed Location On Grid

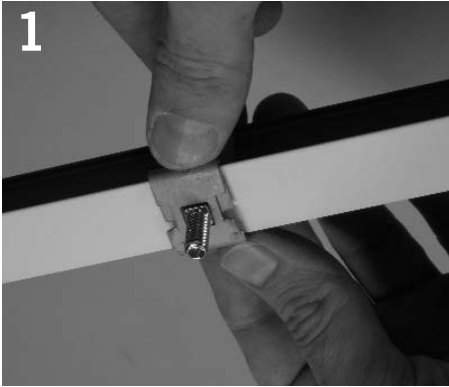

To assemble the Caddy Clip start by separating each half of the clip. Place the threaded stud in the square hole on one half. Place the two halves around the T-grid Ceiling and press together. The integrated tabs will then lock together.

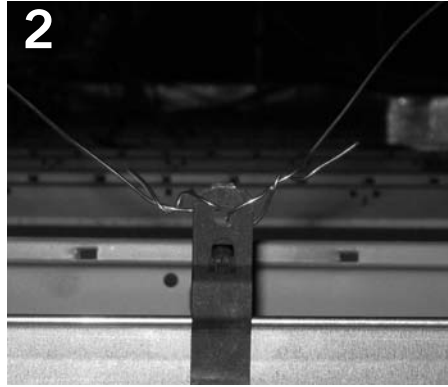

Attach the Caddy/B-line clip to the T-grid ceiling as shown. Make sure to tie the clip off to the ceiling structure in a "V" Pattern or directly above the suspension point. This will reduce torsion to the T-grid.

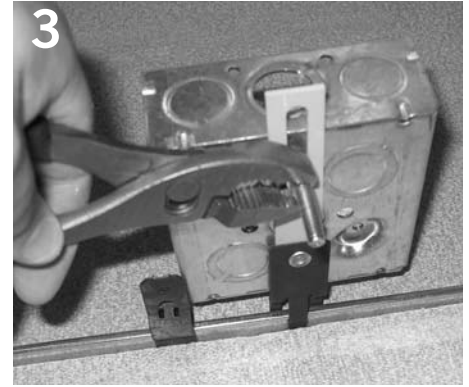

Attach the J-box to the Caddy/B-Line clip as shown. Make sure to secure the J-box with a screw. Run conduit to J-box with proper feed wiring for that location.

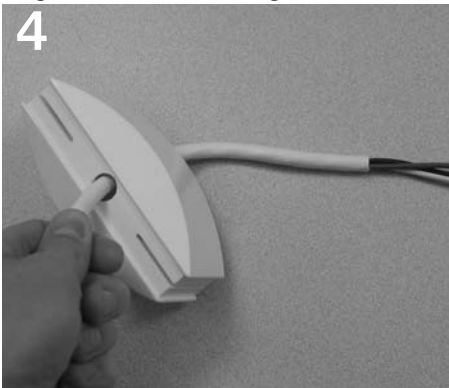

Slide the feed-cord through knock-out in the canopy and make the electrical connection in the junction box.



Secure the mounting bracket to the 1/4-20 stud provided with the Caddy/B-line clip using the supplied 1/4-20 nut and fender washer.

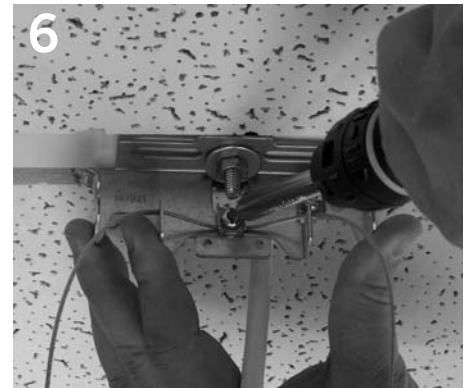

Drrape the aircraft cable over the inner slotted arms (Enform 1 & Enspire shown) or the outer slotted arms (Enform 2) routing behind clamping screw assembly. Tighten screw to secure. This step is critical in order to balance the fixture.

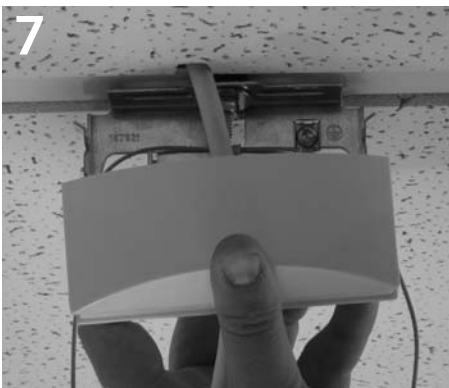

After the fixture has been installed, slide the canopy over the mounting bracket, placing one cable through each slot on the sides of the canopy. Position canopy flush to the T-grid ceiling surface.

Separation of circuits in the outlet box are to be made in accordance with local and/or national electrical installation codes.

PART #04040610-01, Rev A

## Pendant Mount Support Location On Grid

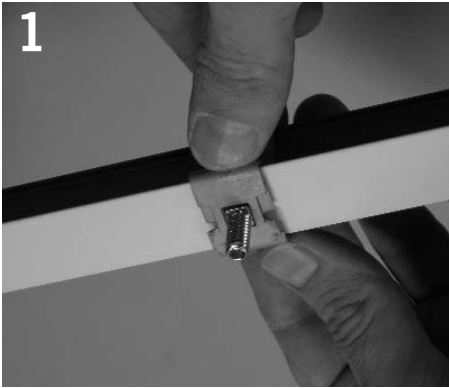

1  
To assemble the Caddy Clip start by separating each half of the clip. Place the threaded stud in the square hole on one half. Place the two halves around the T-grid Ceiling and press together. The integrated tabs will then lock together.

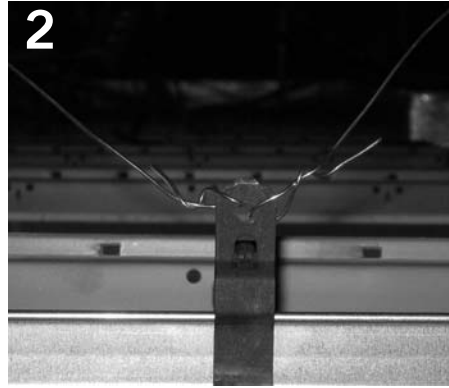

2  
Attach the Caddy/B-line clip to the T-grid ceiling as shown. Make sure to tie the clip off to the ceiling structure in a "V" Pattern or directly above the suspension point. This will reduce torsion to the T-grid.

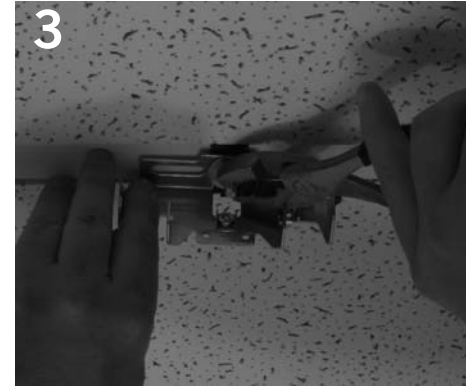

3  
Secure the mounting bracket to the 1/4-20 stud provided with the Caddy/B-line clip using the supplied 1/4-20 nut and fender washer.

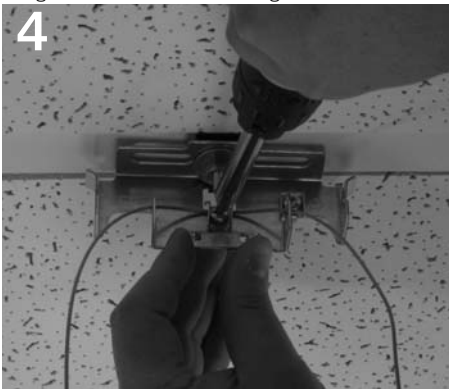

4  
Drape the aircraft cable over the inner slotted arms (Enform 1 & Enspire shown) or the outer slotted arms (Enform 2) routing behind clamping screw assembly. Tighten screw to secure. This step is critical in order to balance the fixture.

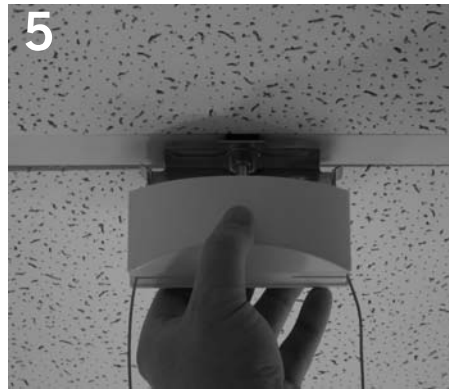

5  
After the fixture has been installed, slide the canopy over the mounting bracket, placing one cable through each slot on the sides of the canopy.

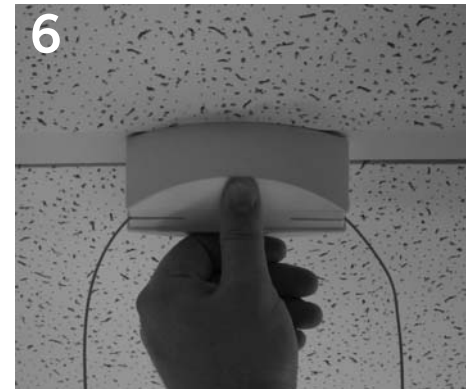

6  
Position Canopy flush to the T-grid ceiling surface.

Product to be installed by qualified electrician only.

Separation of circuits in the outlet box are to be made in accordance with local and/or national electrical installation codes.

PART #04040610-01, Rev A

## Pendant Mount Feed Location Off Grid/Hard Ceiling



1  
If using a T-grid ceiling, attach the Caddy/B-line crossbar to the T-grid ceiling as shown. Make sure to tie the crossbar off to the ceiling structure.



2  
If using a T-grid ceiling, attach the octagonal J-box to the Caddy/B-Line bar as shown. If installing in a hard ceiling mount the j-box to a structure. Run conduit to J-box with proper feed wiring for that location.

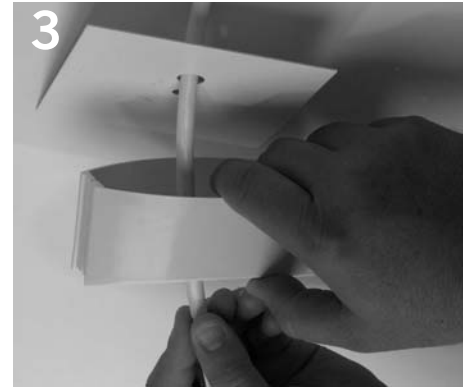

3  
Slide the feed-cord through knock-out in the canopy, then through the mounting plate and make the electrical connection in the junction box.



4  
Attach a j-box strap to the j-box with the 1/4-20 stud hanging down.



5  
Secure the mounting bracket to the 1/4-20 stud provided with the Caddy/B-line clip using the supplied 1/4-20 nut and fender washer.



6  
Drape the aircraft cable over the inner slotted arms (Enform 1 & Enspire shown) or the outer slotted arms (Enform 2) routing behind clamping screw assembly. Tighten screw to secure. This step is critical in order to balance the fixture.



7  
After the fixture has been installed, slide the canopy over the mounting bracket, placing one cable through each slot on the sides of the canopy. Position canopy flush to the T-grid ceiling surface.

Separation of circuits in the outlet box are to be made in accordance with local and/or national electrical installation codes.

PART #04040610-01, Rev A

## Pendant Mount Suspension Location Off Grid/Hard Ceiling

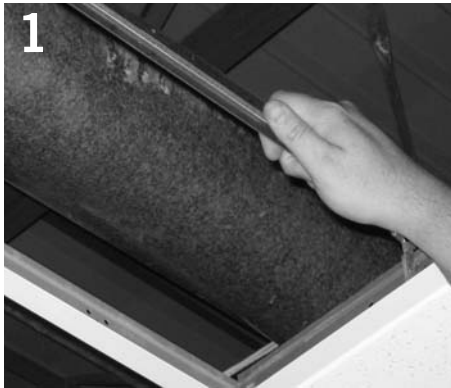

1  
If using a T-grid ceiling, attach the Caddy/B-line crossbar to the T-grid ceiling as shown. Make sure to tie the crossbar off to the ceiling structure per code.



2  
If using T-grid ceiling, run threaded 1/4-20 rod through crossbar and secure with 1/4-20 nuts, allowing enough length to connect to mounting bracket below the ceiling line.

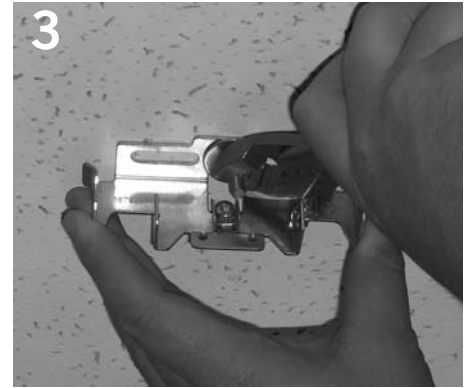

3  
Secure the mounting bracket to the 1/4-20 stud provided with the Caddy/B-line clip using the supplied 1/4-20 nut and fender washer.

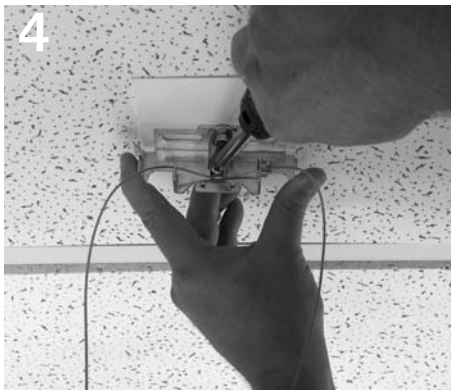

4  
Drape the aircraft cable over the inner slotted arms (Enform 1 & Enspire shown) or the outer slotted arms (Enform 2) routing behind clamping screw assembly. Tighten screw to secure. This step is critical in order to balance the fixture.

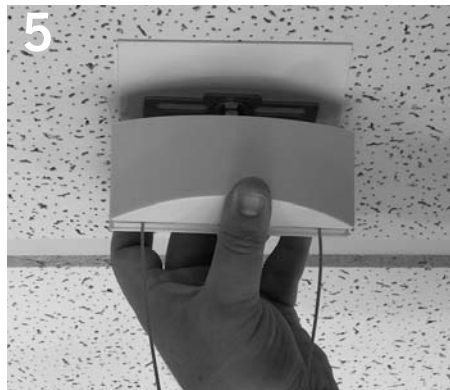

5  
After the fixture has been installed, slide the canopy over the mounting bracket, placing one cable through each slot on the sides of the canopy.



6  
Position Canopy flush to the mounting plate surface.

Product to be installed by qualified electrician only.

Separation of circuits in the outlet box are to be made in accordance with local and/or national electrical installation codes.

PART #04040610-01, Rev A

## Suspending the Fixtures

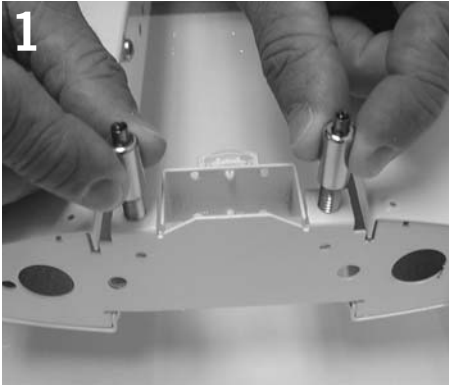

1  
Thread the two (2) supplied 1/4x20 Cable Grippers into the holes in the light fixture end bracket. Repeat at the other end of the fixture.



2  
Remove the louver and lamps if present. Raise the light fixture using a drywall jack or similar device to support the fixture, placing it into position at the proper height and location.

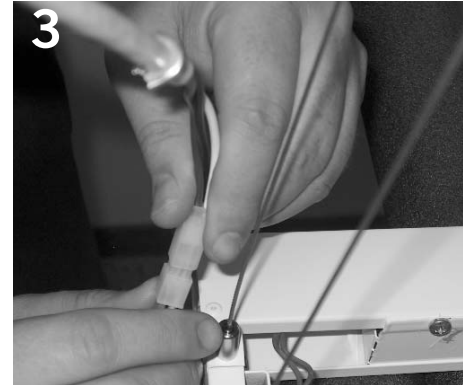

3  
If this is a feed location, connect the feed cord to the light fixture wiring harness, ensuring the excess is pushed back into the light fixture wire way channel.



4  
Insert the aircraft cable into the cable grippers and adjust to the proper position. Trim off excess cable. Repeat at the other end of the fixture.



5  
Lift second fixture into place using the drywall lift.

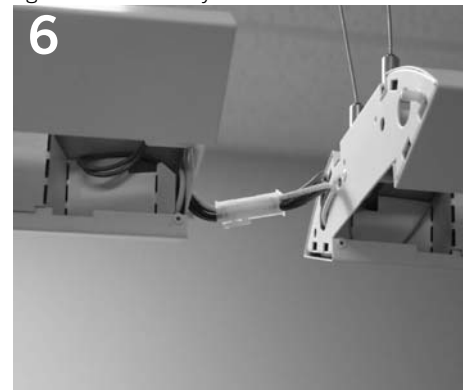

6  
If the run contains more than one fixture, remove the 1/4-20 screws in the fixture ends. Connect the through-wire harness between fixtures.

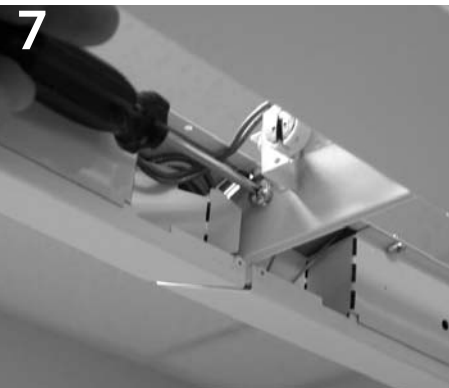

7  
Align the fixtures using the alignment pins, reinsert the 1/4-20 screws and tighten until the joint seam closes.

Product to be installed by qualified electrician only.

Separation of circuits in the outlet box are to be made in accordance with local and/or national electrical installation codes.

PART #04040610-01, Rev A

# ENFORM / ENSPIRE / ENTHUSE énergie

## Installing Endcaps

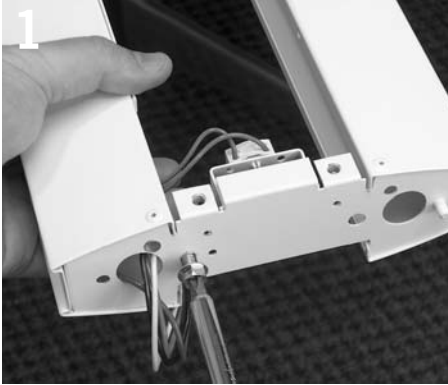

1 Remove the ¼-20 bolt from the end of the fixture run. Make sure that the excess feed cord and wiring harness is pushed back into the light fixture wire way.



2 Back off the supplied #10 machine screws in both mounting holes. Route the feed cord through the hole in the top of the endcap (Ensure that the “hog ring” is placed correctly). Snap the endcap into place.



3 Attach the endcap using the supplied #10 machine screws in both mounting holes.

## Installing Louvers and Lamps

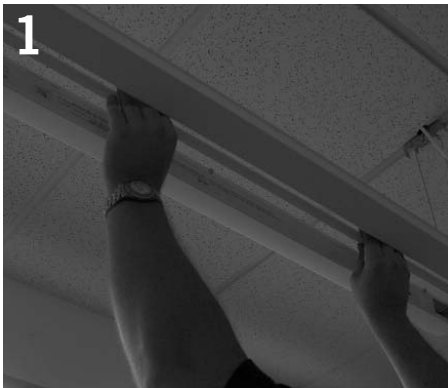

1 Install lamps into fixture as shown.



2 Place louver into housing opening and allow to be suspended for adjustment in the fixture.



3 Starting at one end, push louver so that the starting edge of the louver is as close as possible to the end of the fixture. Then push the louver into the fixture. This ensures that all louvers will be in the proper position for the entire length fixture run.

Product to be installed by qualified electrician only.

Separation of circuits in the outlet box are to be made in accordance with local and/or national electrical installation codes.

PART #04040610-01, Rev A

# ENFORM / ENSPIRE / ENTHUSE énergie

## Pendant Mount Suspension Dimension Drawings

### Enform 1 & 2

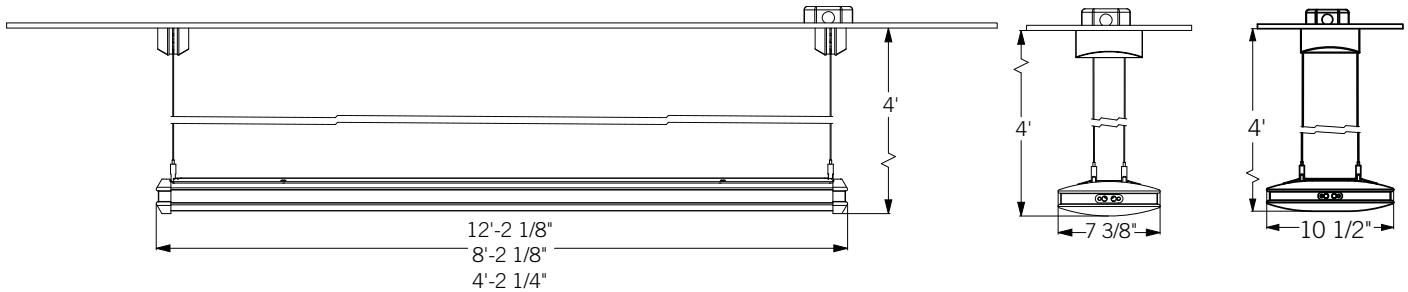

### Enspire

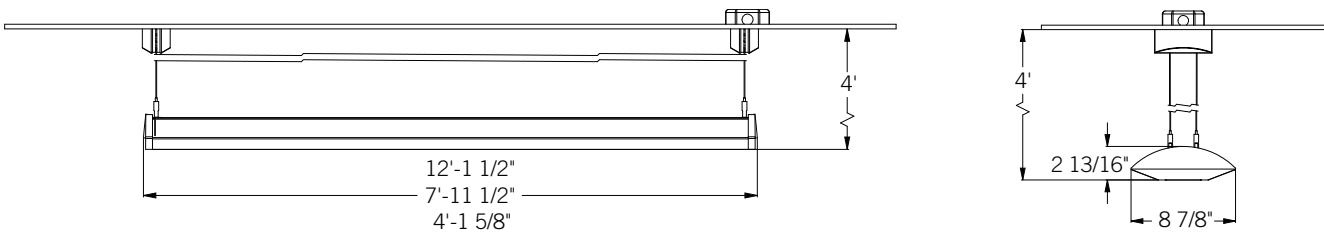

### Enthuse

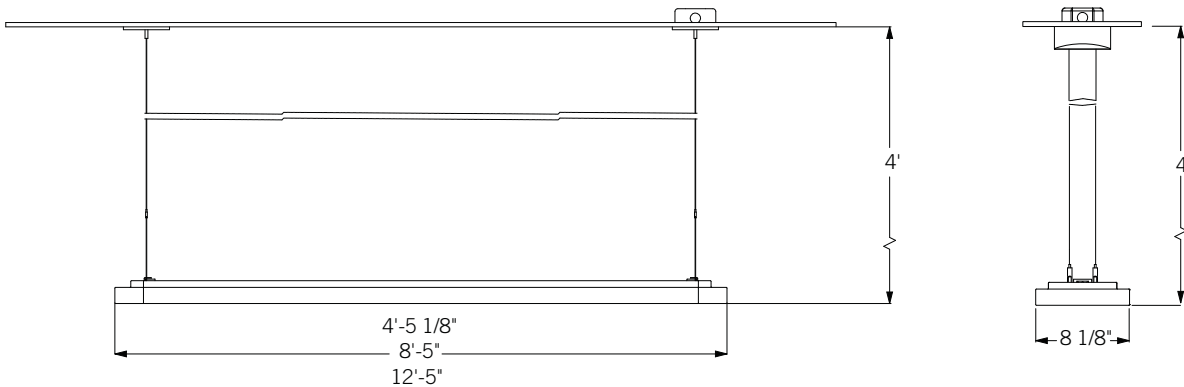

## Maximum Run Length Per Feed

	LAMPING per 4' SECTION						MAX
	(1) T5	(2) T5	(1) T5HO	(2) T5HO	(1) T8	(2) T8	
<b>120 volt</b>	132'	64'	68'	32'	120'	72'	144'
<b>277 volt</b>	308'	156'	160'	84'	284'	176'	344'

Note: Run lengths based on fixtures with standard ballast. Dimming ballasts, battery packs, separate switching and specified ballasts should be verified by an electrical engineer.

Product to be installed by qualified electrician only.

Separation of circuits in the outlet box are to be made in accordance with local and/or national electrical installation codes.

PART #04040610-01, Rev A