

Installation Instructions



1 Unscrew cable stop at each end of fixture.



2 Position cable swedge underneath cable stop.

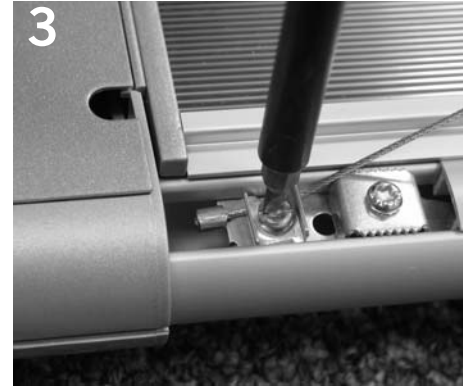

3 Tighten cable stop.

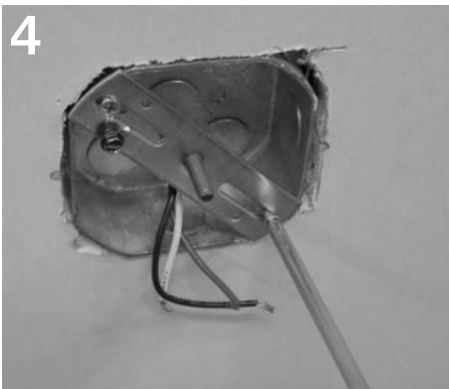

4 Install j-box strap and 1/4-20 stud to j-box.



5 Thread feed cord through bushing in feed canopy.



6 Make electrical connection in j-box and slide canopy over 1/4-20 stud.



7 Secure canopy by tightening threaded cable gripper onto stud.



8 Insert cable and adjust to desired length. Trim excess cable. Repeat same steps at support point, without cord. Attach to 1/4-20 stud provided by contractor.

Note: Luminaires must be tied to structure per local requirements.

Product to be installed by qualified electrician only.

PART # 04040636-01