

Feed and Support Kit Contents

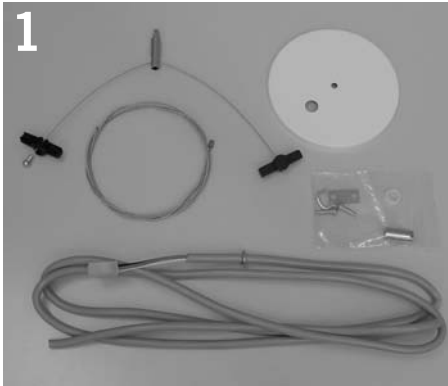

FEED KIT CONTENTS:

- One (1) 72" Feed Cord
- One (1) 4" Canopy
- One (1) Grommet
- One (1) Threaded Barrel
- One (1) 72" Swaged Suspension Cable
- One (1) Y-Cable Assembly with Cable Gripper and Snap-lock Connectors
- Two (2) #8 x 5/8" Screws
- One (1) Strain Relief
- One (1) Hog Ring

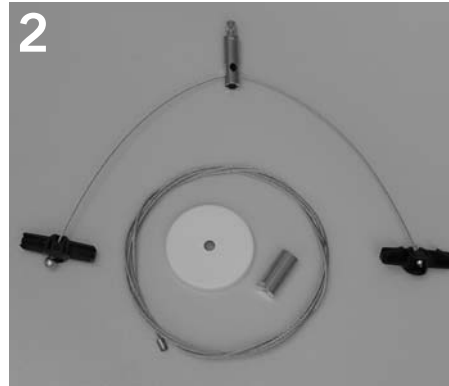

SUPPORT KIT CONTENTS:

- One (1) 2" Canopy
- One (1) Threaded Barrel
- One (1) 72" Swaged Suspension Cable
- One (1) Y-Cable Assembly with Cable Gripper and Snap-Lock Connectors

Feed Kit Installation



Slide power cord through feed canopy and make electrical connections to pre-installed junction box.



Insert swaged suspension cable through threaded barrel.



Secure feed canopy to 1/4-20 x 1 1/2" length stud (not included) with threaded barrel.

Product to be installed by qualified electrician only.

Separation of circuits in the outlet box are to be made in accordance with local and/or national electrical installation codes.

PART #110859-1

Support Kit Installation (non-feed locations)

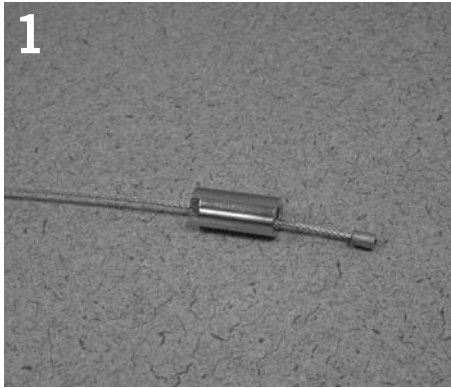

1
Insert swaged suspension cable through threaded barrel.



2
Secure non-feed canopy to 1/4-20 x 1 1/2" length stud (not supplied) with threaded barrel.

Endcap Installation

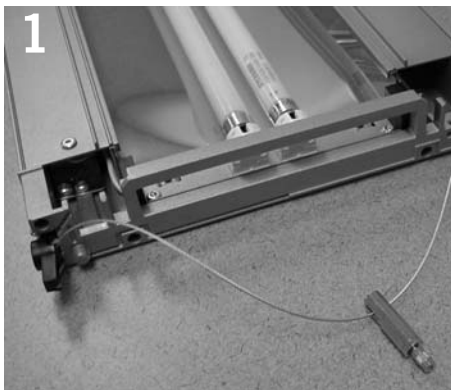

1
Install snap connectors as part of the Y-cable assembly into fixture body.



2
Loosen draw blocks as necessary, being careful not to detach screw from internal nut. Lift draw blocks and slide endcap onto snap-lock connectors.

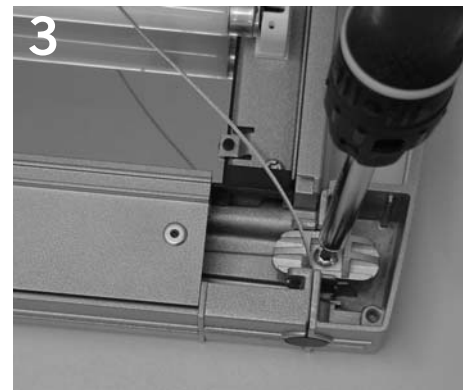

3
After ensuring that the cable is in the guide slots at each side of the joint, tighten draw blocks until snug (using a Torx T20 driver is preferred).

Product to be installed by qualified electrician only.

Separation of circuits in the outlet box are to be made in accordance with local and/or national electrical installation codes.

PART #110859-1

Suspending the Fixtures

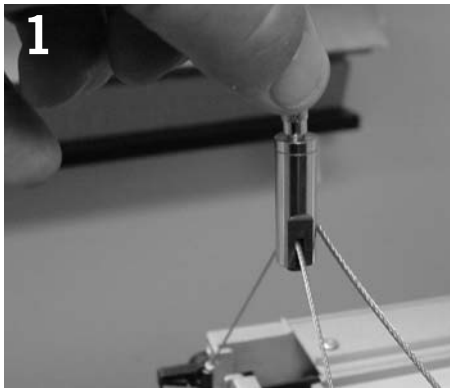

1
Insert suspension cables into support barrels and adjust to appropriate length. Tighten knurled knob to fix in place.

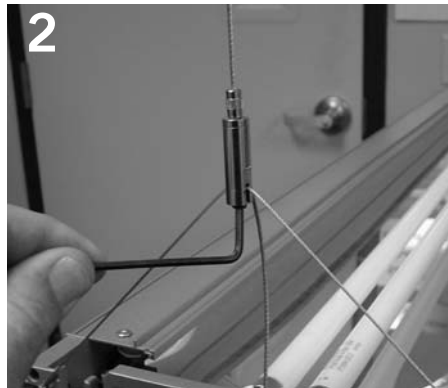

2
Adjust housing so it is level and tighten set screw to fix position.

Note: Luminaires must be tied to structure per local requirements.

Joining the Fixtures for Linear Runs

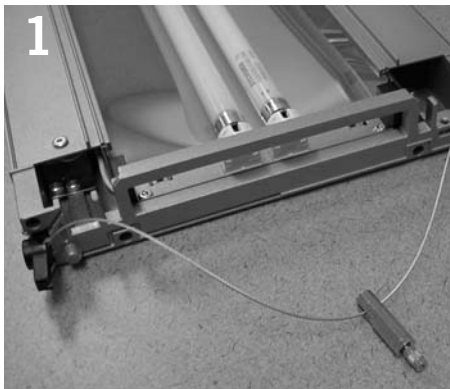

1
Starting with a suspended fixture, insert snap connectors into opposite end of next fixture to be joined.

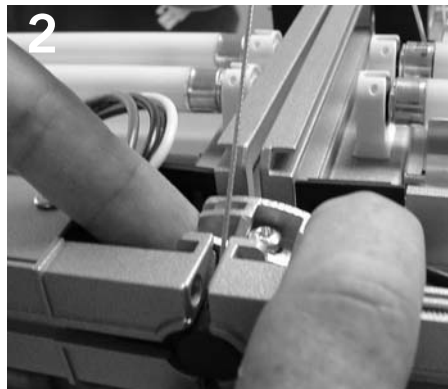

2
Loosen the draw blocks being careful not to remove the screw from the nut. Lift the draw blocks and slide the fixtures together. Tighten the draw blocks.

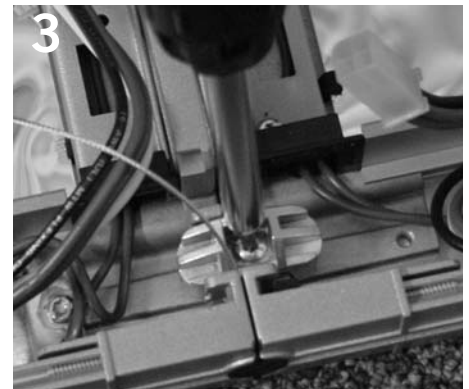

3
After ensuring that the cable is in the guide slots at each side of the joint, tighten draw blocks until snug (using a Torx T20 driver is preferred).

Product to be installed by qualified electrician only.

Separation of circuits in the outlet box are to be made in accordance with local and/or national electrical installation codes.

PART #110859-1

Adjusting the Leveling Bracket in 8' Fixtures

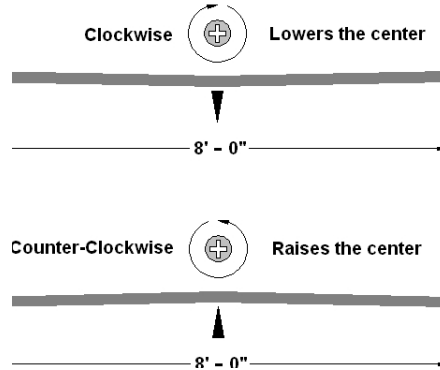

Rotating the screw clockwise will lower the center of the fixture. **Minimal rotation of the screw should be necessary.**

Rotating the screw counter-clockwise will raise the center of the fixture. **Minimal rotation of the screw should be necessary.**

Electrical Connection at Feed End

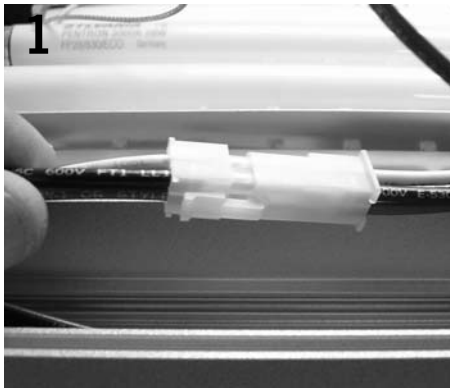

1 Remove ballast channel cover by releasing the snap-fit, then using the male/female Molex connectors, make the electrical power connection. channel.

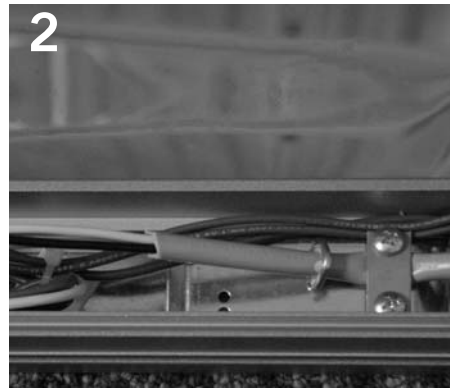

2 Install strain relief consisting of small metal plate and 2 screws, making sure the hog ring on the feed cord is on the side of the strain relief toward the center of the fixture.



3 Attach feed wire to the fixture housing and cable supports for clean appearance. Reinstall channel cover.

Product to be installed by qualified electrician only.

Separation of circuits in the outlet box are to be made in accordance with local and/or national electrical installation codes.

PART #110859-1

Electrical Connection at Joints in Linear Runs

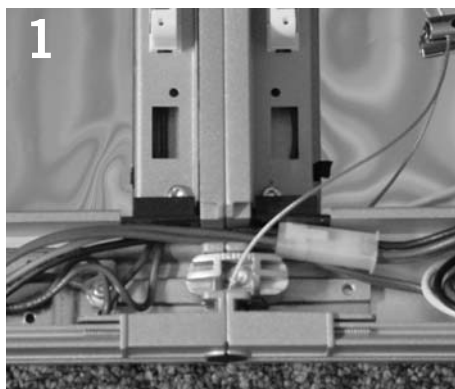

1
Remove ballast channel cover on both sides of joint by releasing the snap-fit, then using the male/female Molex connectors, make the electrical power connection.

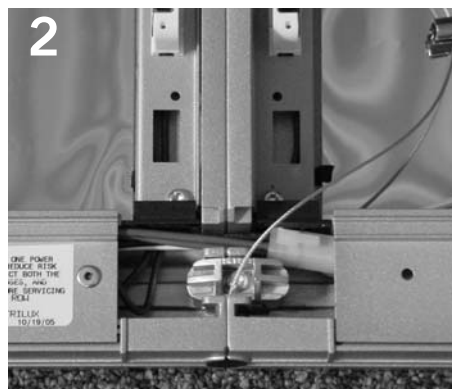

2
Reinstall channel covers.

Complete Hanging Assembly- Examples



One (1) 4' factory made SD fixture, using a two-point suspension.

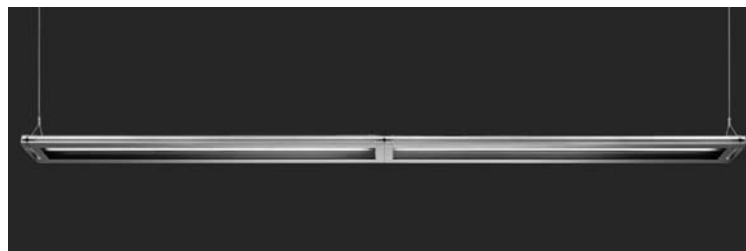

One (1) 8' factory made SD fixture, using a two-point suspension.

Maximum Run Length Per Feed

	LAMPING per 4' SECTION			
	(1) T5	(2) T5	(1) T5HO	(2) T5HO
120 volt	74'	36'	38'	18'
277 volt	172'	86'	90'	46'

Note: Run lengths based on fixtures with standard ballast. Dimming ballasts, battery packs, separate switching and specified ballasts should be verified by an electrical engineer.

Product to be installed by qualified electrician only.

Separation of circuits in the outlet box are to be made in accordance with local and/or national electrical installation codes.

PART #110859-1