

ASTRON PENDANT

Installation Instructions

PENDANT HARDWARE KIT CONTENTS:

At the feed point:

- One (1) 6' SJT cord
- One (1) 6' 3/32 aircraft cable with 1 swaged end
- One (1) Cable adjuster button with cover and brass bushing
- One (1) 3/32 aircraft cable with 2 swaged ends
- One (1) 1/4x20x3/32 cable gripper
- One (1) steel round canopy with 2 holes
- One (1) J-box strap
- One (1) 1/4x20 threaded stud
- One (1) white plastic cord strain relief

At the support point:

- One (1) 6' 3/32 aircraft cable with 1 swaged end
- One (1) Cable adjuster button with cover and brass bushing
- One (1) 3/32 aircraft cable with 2 swaged ends
- One (1) 1/4x20x3/32 cable gripper
- One (1) steel round canopy with 1 hole

SUPPLIED BY CONTRACTOR:

At the feed point:

- One (1) round j-box installed in ceiling

At the support point:

- One (1) 1/4x20 stud (hard ceiling)
- Caddy Clip or equivalent (grid mount)



1
Unscrew cable adjuster button and lay short cable through button as shown.



2
Lay brass ring into adjuster button.



3
Lay swaged end of long cable into adjuster button and reassemble button.



4
Remove ballast compartment cover.

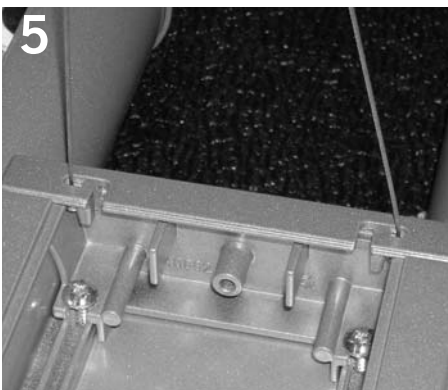

5
Insert cable ends into slots as shown.

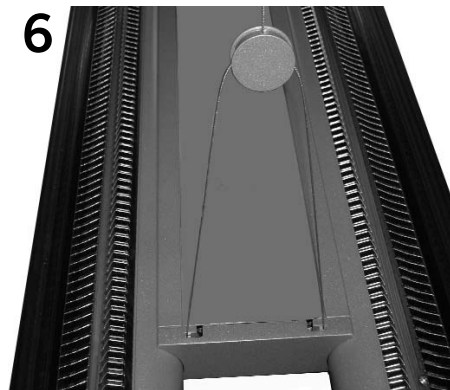

6
Replace ballast compartment cover.

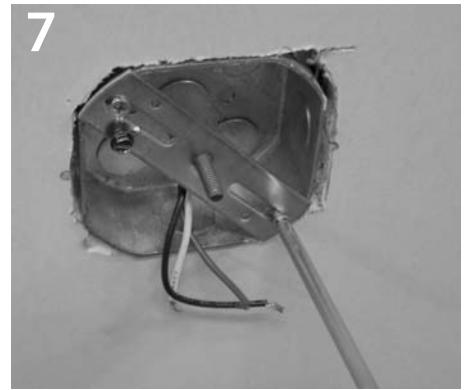

7
Install j-box strap and 1/4-20 stud to j-box.

Product to be installed by qualified electrician only.

PART # 05092701-02

ASTRON PENDANT

énergie™

Installation Instructions

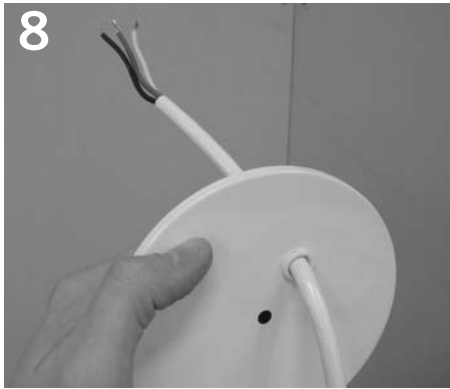

8 Thread feed cord through bushing in feed canopy.



9 Make electrical connection in j-box and slide canopy over 1/4-20 stud.



10 Secure canopy by tightening threaded cable gripper onto stud.



11 Insert cable and adjust to desired length. Trim excess cable.

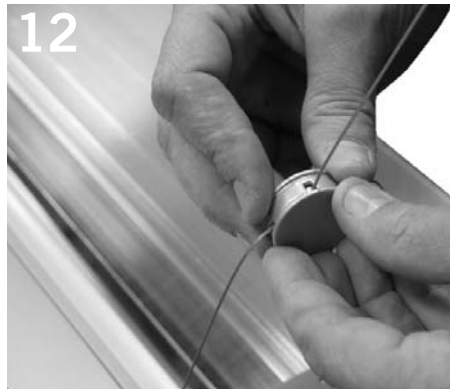

12 Loosen adjuster button.



13 Level fixture by sliding cable through adjuster button.

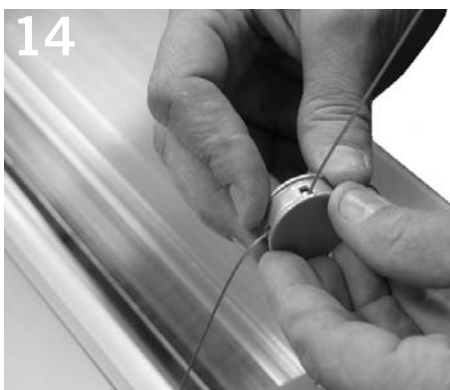

14 Tighten button when desired position is achieved. Repeat the same steps without

Notes:

1. Luminaires must be tied to structure per local requirements.
2. When dimming ballasts are installed in these luminaires, the dimming control circuit coming to the luminaire must be a class 1 circuit.

Product to be installed by qualified electrician only.

PART # 05092701-02