



ZENN

ZENN T2 | 17th and Larimer Building, Denver, CO | Architect: Klipp Architecture, Denver, CO | Photograph: Frank Ooms

Énergie • 4885 Ward Road, Suite 300 • Wheat Ridge, CO 80033 • Tel 720 963 8055 • www.energielighting.com

multiline®



ZENN T1 | Énergie Office, Wheat Ridge, CO | Photograph: Chris Kokias

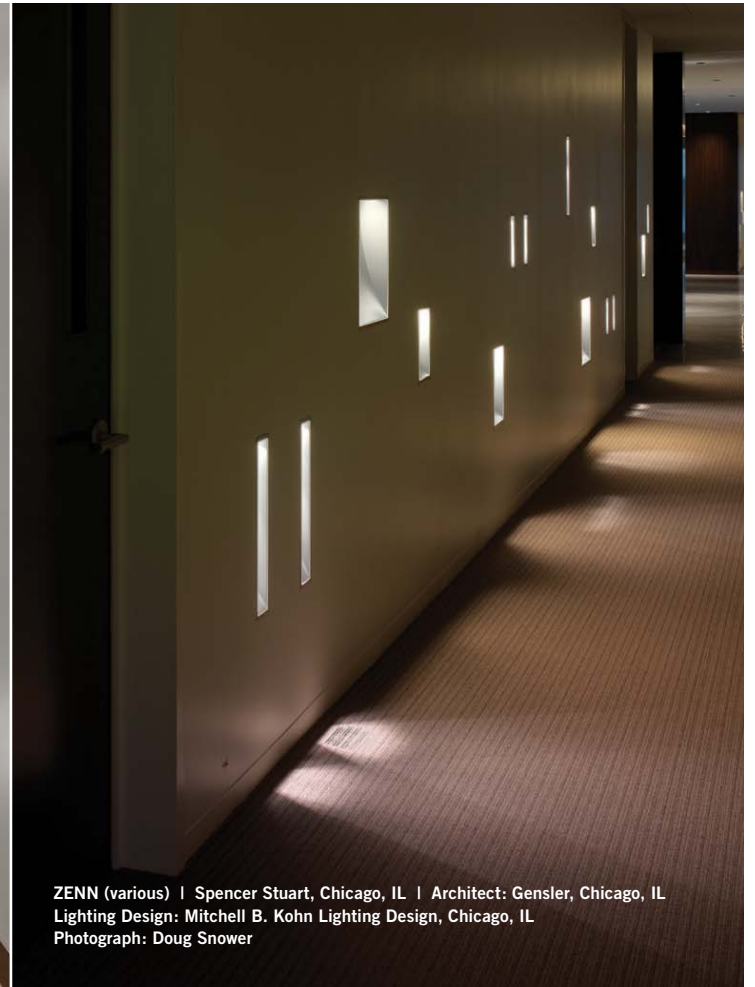

ZENN (various) | Spencer Stuart, Chicago, IL | Architect: Gensler, Chicago, IL
Lighting Design: Mitchell B. Kohn Lighting Design, Chicago, IL
Photograph: Doug Snower

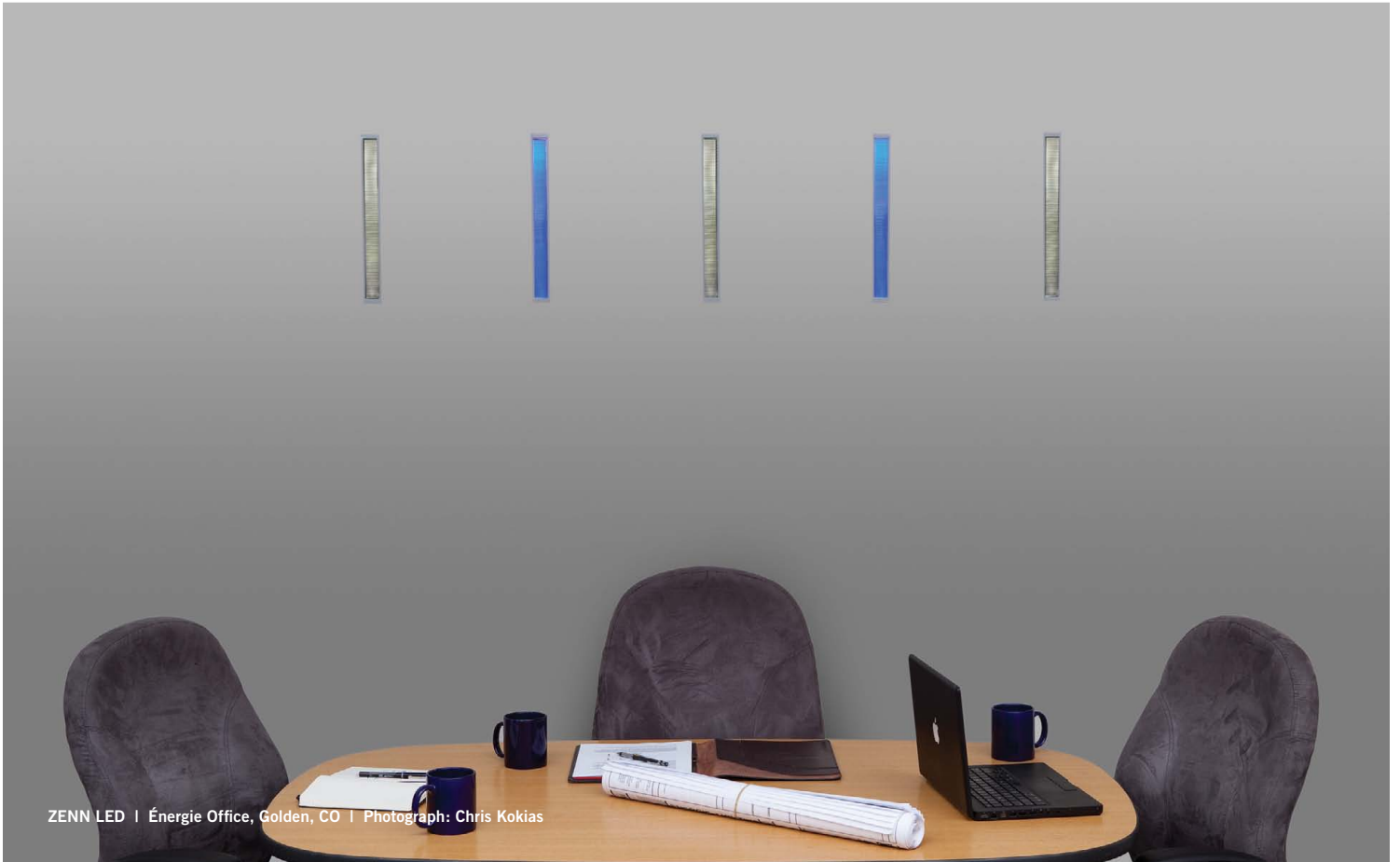

ZENN LED | Énergie Office, Golden, CO | Photograph: Chris Kokias

ZENN. Artful simplicity.

No detail or ornamentation interrupts its unpretentious presence. That's the beauty of ZENN by Multiline from Belgium. It is, pure and simple, a recessed pocket of light. Yet it takes many forms, including ZENN LED, an elegant 2x16-inch luminaire emitting a subtle glow in any of 7 colors.



RED



AMBER



GREEN



CYAN



BLUE



WARM WHITE



COOL WHITE

ZENN LED offers a choice of seven colors.

Smaller ZENN luminaires discreetly accent floors or ceilings; larger ones project higher levels of illumination where needed. You can face ZENN's lamps up or down. Choose smooth or ribbed aluminum reflectors. Installation is easy – electronic ballasts and transformers are integral; no back box or special mounting hardware required.

Six sizes. Endless design possibilities.



Zenn T0
4" x 4"



Zenn T1
4" x 10"



Zenn T2
4" x 18"



Zenn T3
8" x 10"



Zenn T4
10" x 14"



Zenn LED
2" x 16"



ZENN (various) | Spencer Stuart, Chicago, IL | Architect: Gensler, Chicago, IL
Lighting Design: Mitchell B. Kohn Lighting Design, Chicago, IL | Photographer: Doug Snower

ZENN fixtures can be used to create a light "gallery" to add visual interest to a wall.

Product details.

- Creates a recessed pocket of light
- Six fixture sizes available
- ZENN LED available in seven colors
- Simple installation – no back box or special mounting required
- May be mounted with lamp facing either up (above eye level) or down (below eye level) for dramatic lighting effects
- Choose either smooth or ribbed reflectors
- **ADA compliant**

CONSTRUCTION Fixture body is constructed of steel. Curved reflector is constructed of aluminum.







FINISH Fixture box and flange are finished in polyester powder coat. Curved reflector is a natural anodized aluminum.

SHIELDING Lamp opening is covered with a clear-glass lens except in T1 and T2, where glass-enclosed MR-16 lamps are required. ZENN LED has no lens. Choose smooth or ribbed reflector.

ELECTRICAL 120V or 277V. Integral ballast, transformer, or LED power supply in back box.

MOUNTING No back box or special mounting hardware required. Fixture may be installed with lamp facing up or down. Fixture may be mounted in plaster or drywall up to 5/8-inch thick.

See product specification sheets at www.energielighting.com for complete details.

 DAMP LOCATION LISTED ZENN LED DRY LOCATION ONLY						
	ZENN T0	ZENN T1	ZENN T2	ZENN T3	ZENN T4	ZENN LED
Catalog Number Prefix	ZT0	ZT1	ZT2	ZT3	ZT4	ZTL
Ribbed or Smooth Aluminum Reflector	Yes	Yes	Yes	Yes	Yes	Yes
Dimmable	Yes*	Yes*	Yes*	No	Yes	No
Indirect % / Direct %	n/a	68% / 32%	89% / 16%	82% / 18%	89% / 11%	n/a
ADA Compliant	Yes	Yes	Yes	Yes	Yes	Yes
Lamp (supplied by others except ZENN LED)	1x35W bi-pin T4 Halogen GY6.35	1x50W MR16** GU 5.3 (maximum)	1x50W MR16** GU 5.3 (maximum)	1x13W CFL G24q-2	1x26W CFL G24q-3	1x1W LED COLORS: Red, Amber, Green, Blue, Cyan, Warm White (3000°k), Cool White (4000°k)

*With ELV dimmer only; **MR16 lamp with frosted lens is suggested for softer beam.

Dimensions.

ZENN T0

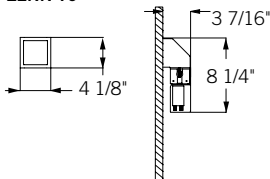

ZENN T2

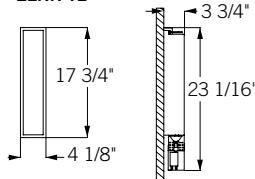

ZENN T4

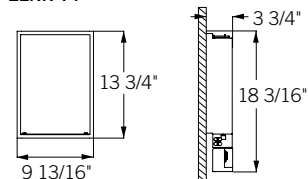

ZENN T1

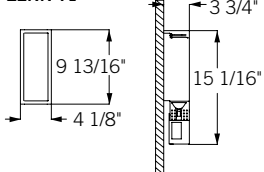

ZENN T3

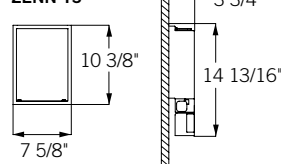

ZENN LED

