



LEVEL

LEVEL Linear | Arium Architects, Baltimore, MD | Photograph: Jonathan Galbreath

Énergie • 4885 Ward Road, Suite 300 • Wheat Ridge, CO 80033 • Tel 720 963 8055 • www.energielighting.com

 **REGENT**



LEVEL Wall | Énergie Office, Golden, CO | Photograph: Chris Kokias | Paintings: Wayne Miller



LEVEL Pendant 3 | WS Teleshop, Wiener Neudorf, Austria



LEVEL Linear | Énergie Office, Wheat Ridge, CO | Photograph: Chris Kokias



LEVEL. Elegant design. Patented optics. Smart choice.

Designed by Renato M. De Toffol for Regent of Basel, Switzerland, LEVEL is one of the most versatile high-performance direct/indirect lighting systems available for open-plan spaces, conference rooms, executive areas, and more.

In 4-, 8-, and 12-foot modules, LEVEL Linear can be joined to form linear runs spanning virtually any length, or it can be used as a stand-alone pendant fixture. LEVEL is also offered as a chandelier-style pendant, as well as a wall-mounted version, so specifiers may use the same fixture family to meet a range of needs throughout a space.

Dimming ballast, emergency battery pack, and integral control sensors are available in LEVEL Linear. LEVEL Wall and LEVEL Pendant fixtures are also available with dimming ballasts (but do not support controls or battery packs).



LEVEL Linear fixtures may be joined to create linear runs.

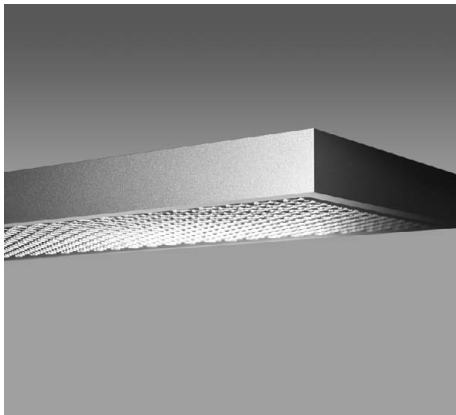

All LEVEL fixtures are beautifully designed and crafted as a slender (1.5") extruded aluminum body.



LEVEL Wall is often used in multiples but is not connectable.



LEVEL Pendant 3. Fixture head position may be adjusted by the user.

LEVEL family.

The LEVEL family includes linear pendant, wall, and 2- and 3-head pendant fixtures, allowing unlimited creative application. The 4'-, 8'-, and 12' LEVEL Linear fixtures may be joined for linear runs of any length.

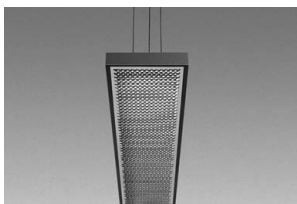

LEVEL Linear is available in 4-, 8-, and 12-foot modules.



LEVEL Wall is available in 2- and 4-foot lengths.

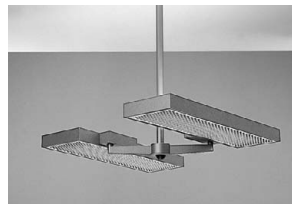

LEVEL Pendant 2.



LEVEL Pendant 3.

MicroDownlight Technology®. Exceptional brightness control.

LEVEL's optical system is based on Regent's patented MicroDownlight Technology (MDT). MDT is a two-part system comprised of "mini-downlights," drawn from aluminum reflector material, and a translucent overlay.

LEVEL Linear provides 90% fixture efficiency with omnidirectional brightness control and has intensity values at 55°, which are better than ANSI/IES RP-1-04 recommendations.

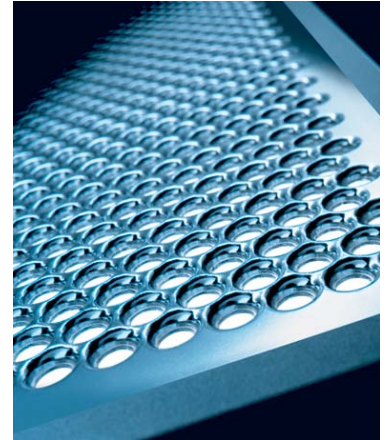

MicroDownlight Technology (MDT) optical system.



Eaton, Morges, Switzerland | Architect: Karl Steiner Architects, Geneva, Switzerland
Lighting Design: Michel Saugy, Echichens, Switzerland | Photograph: Tom Waugh

LEVEL Linear stand-alone pendant.



Énergie Office, Wheat Ridge, CO | Photograph: Chris Kokias



LEVEL Linear

Product details.

- Slim, rectilinear 1.5-inch profile
- MDT® louver produces excellent omnidirectional brightness control
- Intensity values at 55° are significantly better than ANSI/IES RP-1-04 recommendations (LEVEL Linear only)
- Family includes linear, wall, and pendant fixtures
- 4', 8', or 12' Linear fixtures may be joined to form runs of unlimited length
- LEVEL Pendant is available with 2 or 3 heads
- LEVEL Wall is available in 2- or 4-foot length

CONSTRUCTION	Fixture body constructed of extruded aluminum. Endplates constructed of steel. Fixtures joined together with internal joiners to form smooth seams.
FINISH	Fixture finished in thermopainted metallic silver.
SHIELDING	Lamps are shielded by MDT® louver and acrylic overlay. Louver is specular and allows 16%-22% downlight, depending on lamping.
ELECTRICAL	120V or 277V.
MOUNTING	Linear fixture may be individually mounted or joined together to form linear runs. Linear fixtures are supplied with 72-inch fully adjustable aircraft cable. Pendant fixtures are mounted with an aluminum rigid stem with a 46-inch overall suspension. Stem may be cut in the field. Pendant fixtures mount to standard octagonal junction box. Fixture head position may be adjusted by the user. Wall fixture is mounted to wall using Énergie junction box.

See product specification sheets at www.energielighting.com for complete details.

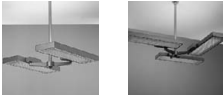
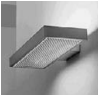
 DAMP LOCATION LISTED	 LEVEL Linear	 LEVEL Pendant	 LEVEL Wall
Catalog Number Prefix	LEV	LEP	LEW
Connectable	Individual or Runs	Individual	Individual
Dimming Ballast, Emergency Battery Pack	Yes	Dimming	Dimming
Indirect % / Direct %	84% / 16% (2-lamp)	78% / 22%	84% / 16%
Efficiency	82.2% 2x54W T5HO	65.1% 4x55W CFL 2G11	82.1% 2x54W T5HO
Lamp (supplied by others)	1x28W T5 1x54W T5HO 2x28W T5 2x54W T5HO	<u>2-Head Fixture</u> 4x55W CFL 2G11 <u>3-Head Fixture</u> 6x55W CFL 2G11	<u>2-Foot Fixture</u> 2x55W CFL 2G11 <u>4-Foot Fixture</u> 2x28W T5 2x54W T5HO

Dimensions.

LEVEL LINEAR

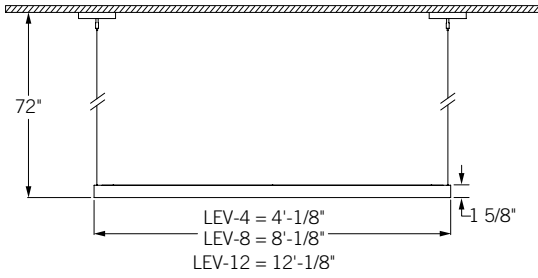

LEVEL PENDANT, 2- AND 3-HEAD

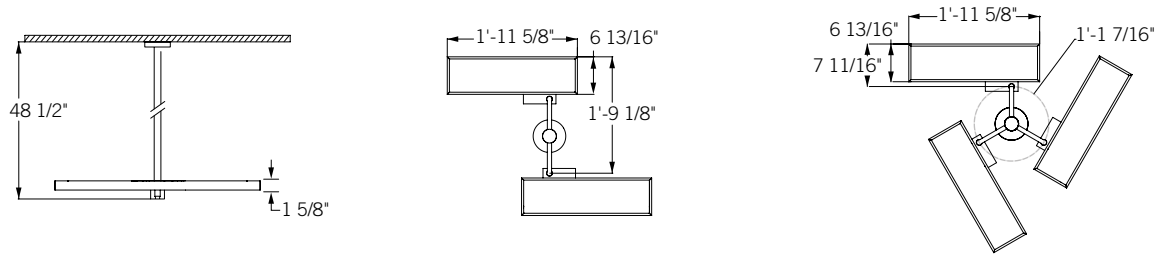

LEVEL WALL 2'

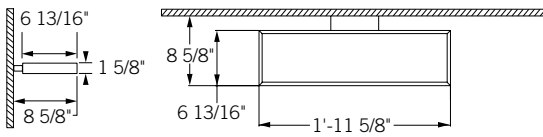

LEVEL WALL 4'

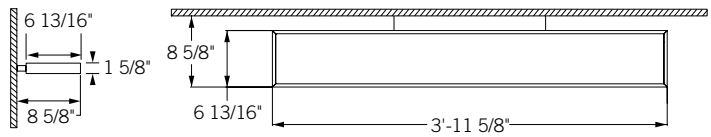

Performance.

For photometric files, visit www.energelighting.com.

